

## VF Series

### VF & VF-DS (Double Sided)

#### Technical Data:

Durometer Hardness

- ASTM C661, Shore A1, Silicone coating - not to exceed 25pts (±5)

Weatherometer

- ASTM C510, ASTM G26-77, Xenon Arc Weatherometer 2000 hrs - no Visible deterioration

#### Primary Surface Weathering

- ASTM G26-77, Atlas Weatherometer 6000 hrs - minimal hardness change

#### Temperature Range

- Low Permanent -40°F(-40°C) to High Permanent 185°F (85°C)
- Temperature Stability, Bleeding, Staining and Recovery Under Field Conditions - Material will not bleed or stain after withstanding 150°F (65°C) for 3 hours while compressed down to the minimum of movement capability (-50% of nominal material size). After cooling to room temperature, 60°F (20°C), the material will self-expand to the maximum of movement capability (+50% of nominal material size) within 24 hours.

#### Wind Loading

- ASTM E330, Hurricane Std. Miami-Dade County, FL=150 mph -0.1mm Net Deflection of Span @ +2730 ΔP(Pa), 150 mph equivalent, +0.1mm Net Deflection of Span @ -2730 ΔP(Pa), 150 mph equivalent, -0.6mm Net Deflection of Span @ +4854 ΔP(Pa), 200 mph equivalent -0.5 mm Net Deflection of Span @ -4854 ΔP(Pa), 200 mph equivalent

#### R-Value

- ASTM C518-04, 2.15 per 1-inch (25mm) depth at as-installed nominal joint size compression

#### Water Penetration

- ASTM E331-00, No water penetration after consecutive 15 minute soak durations under pressures of: 500 ΔP(Pa), 65 mph equivalent wind driven rain; 1000 ΔP(Pa), 92 mph equivalent wind driven rain; 5000 ΔP(Pa), 205 mph equivalent wind driven rain.

#### STC Rating (Sound Transmission Class)

- ASTM E90-09, STC 52 (in a STC 56 wall)

#### OITC Rating (Outdoor Indoor Transmission Class)

- ASTM E90-09, OITC 38 (in a OITC 38 wall)
- Air Permeability (ABAA air leakage limit for materials - not to exceed .02 L/(s·m<sup>2</sup>) @ 75 DP(Pa)
- ASTM E283-04, ABAA Compliant 0.0078 L/(s·m<sup>2</sup>) @ 75 DP(Pa), 0.0118 L/(s·m<sup>2</sup>) @ 250 DP(Pa)

#### Movement of Seal

- +/- 50% of movement in any direction, as long as the total combined movement in all directions is within the +/- 50% capability.

#### Product Description:

This precompressed low-modulus silicone with an open-cell polyurethane foam infused with a water-based, non-drying acrylic dispersion. The precompressed foam is available in 12 standard colors and supplied in 6'-6" lengths. (\*Note VF-100 is supplied in 10' reel length.)

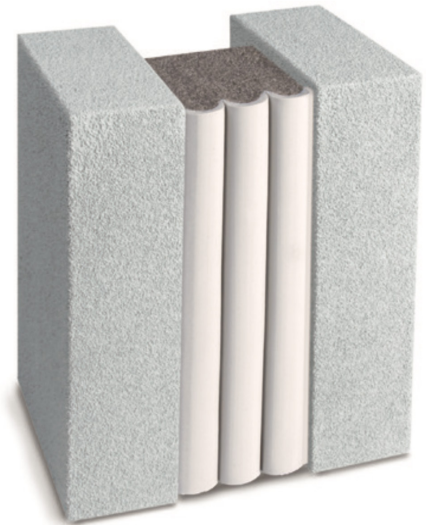

**Use This Cover For:**

- Primary exterior construction joints.
- Vertical or horizontal movement – Expansion, control, and isolation joints.
- Retrofit joints.
- Pre-cast concrete walls – Tilt-up walls.
- Exterior Panel Systems – Masonry, natural stone, brick, metal, GFRP, and curtain walls and other shallow substrates where sealing or finishing of both sides of structure is desired.

**Performance Characteristics:**

Provides a weather tight, airtight, UV stable and insulated primary seal.

Once VF joint sealant is installed in the joint, the material expands, adapting to the width of the joint and the irregularities of the substrate provided such profile changes are not sudden or extreme.

**Standard Finishes:**

Standard Colors: SWRI Sikasil® WS-295 Silicone. Custom colors available upon request.

**Installation Guidelines:**

Ensure that the joint is clean and will provide an appropriate surface for the joint sealant. Remove wrapping material, hardboard and release paper material. Wipe applied release agent from silicone facing and adhere to one joint face. Material will self expand and seal to opposite side. Tool fillet corner beads of liquid silicone where sealant facing meets the substrate. For the complete technical data and installation instructions, please visit [www.c-sgroup.com](http://www.c-sgroup.com).

MODEL	JOINT WIDTH	MINIMUM OPENING	MAXIMUM OPENING	EXPOSED SURFACE	BLOCKOUT WIDTH	BLOCKOUT HEIGHT	SEAL DEPTH
VF-100*	1.00" (25mm)	0.50" (13mm)	1.50" (38mm)	1.00" (25mm)	N/A	N/A	1.75" (44mm)
VF-150	1.50" (38mm)	0.75" (19mm)	2.25" (57mm)	1.50" (38mm)	N/A	N/A	2.25" (57mm)
VF-200	2.00" (51mm)	1.00" (25mm)	3.00" (76mm)	2.00" (51mm)	N/A	N/A	2.50" (64mm)
VF-250	2.50" (64mm)	1.25" (32mm)	3.75" (95mm)	2.50" (64mm)	N/A	N/A	2.75" (70mm)
VF-300	3.00" (76mm)	1.50" (38mm)	4.50" (114mm)	3.00" (76mm)	N/A	N/A	3.50" (89mm)
VF-350	3.50" (89mm)	1.75" (44mm)	5.25" (133mm)	3.50" (89mm)	N/A	N/A	3.75" (95mm)
VF-400	4.00" (102mm)	2.00" (51mm)	6.00" (152mm)	4.00" (102mm)	N/A	N/A	4.50" (114mm)
VF-450	4.50" (114mm)	2.25" (57mm)	6.75" (171mm)	4.50" (114mm)	N/A	N/A	5.00" (127mm)
VF-500	5.00" (127mm)	2.50" (64mm)	7.50" (191mm)	5.00" (127mm)	N/A	N/A	5.50" (140mm)
VF-550	5.50" (140mm)	2.75" (70mm)	8.25" (210mm)	5.50" (140mm)	N/A	N/A	5.75" (146mm)
VF-600	6.00" (152mm)	3.00" (76mm)	9.00" (229mm)	6.00" (152mm)	N/A	N/A	6.00" (152mm)
VF-650	6.50" (165mm)	3.25" (83mm)	9.75" (248mm)	6.50" (165mm)	N/A	N/A	6.50" (165mm)
VF-700	7.00" (178mm)	3.50" (89mm)	10.50" (267mm)	7.00" (178mm)	N/A	N/A	7.00" (178mm)
VF-750	7.50" (191mm)	3.75" (95mm)	11.25" (286mm)	7.50" (191mm)	N/A	N/A	7.50" (191mm)
VF-800	8.00" (203mm)	4.00" (102mm)	12.00" (305mm)	8.00" (203mm)	N/A	N/A	8.00" (203mm)

\*Note: VF-100 DS only Seal Depth is 2.75"

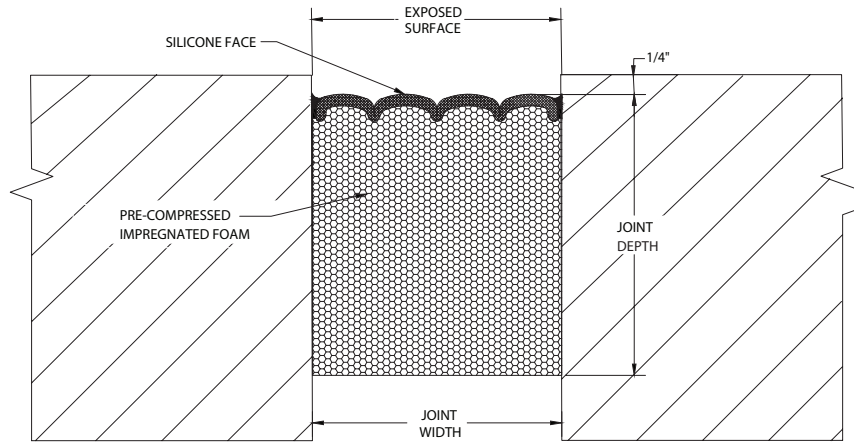

VF

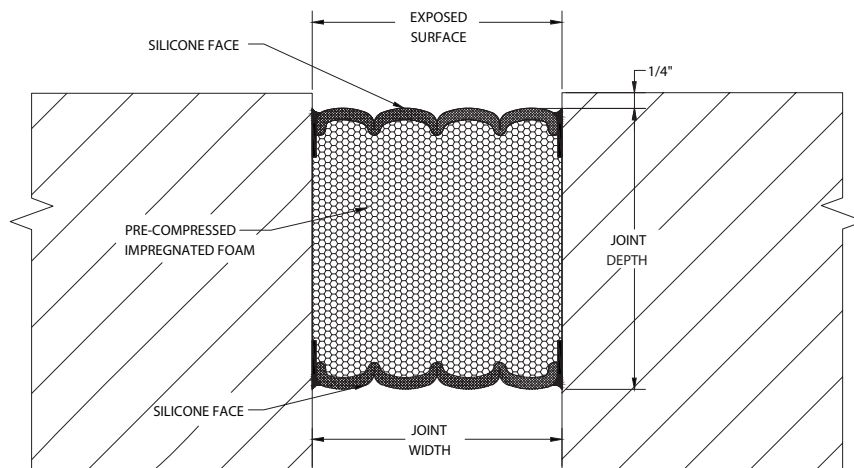

VF-DS