

# SPLIT BLADE DRAINABLE MULLION LOUVERS - MODEL 6917

LOUVER FURNISHED WITH 1 1/2"x1 1/2"x1/8" ALUM.  
CLIP ANGLES 24° O.C. (JAMBS ONLY) (MIN. 2 PER JAMB)

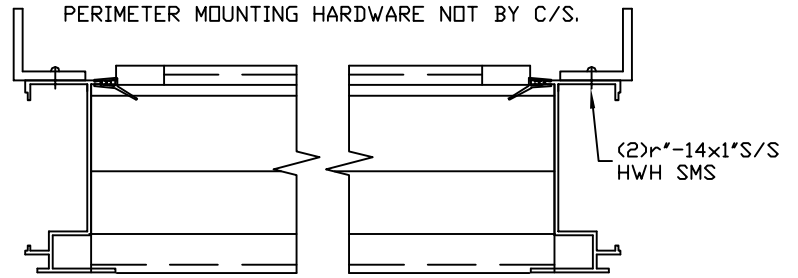

OPENING WIDTH = "A" DIMENSION  
(FABRICATED LOUVER WIDTH = "I" LESS THAN "A" DIM.)

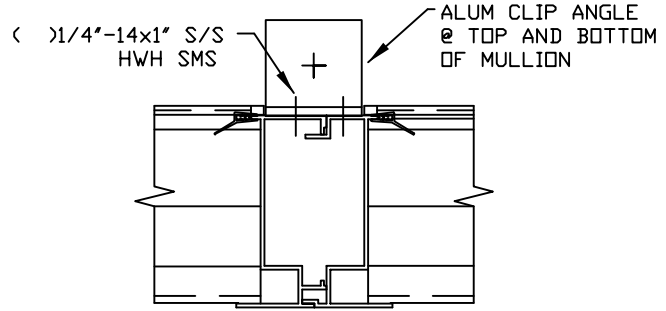

MULLION

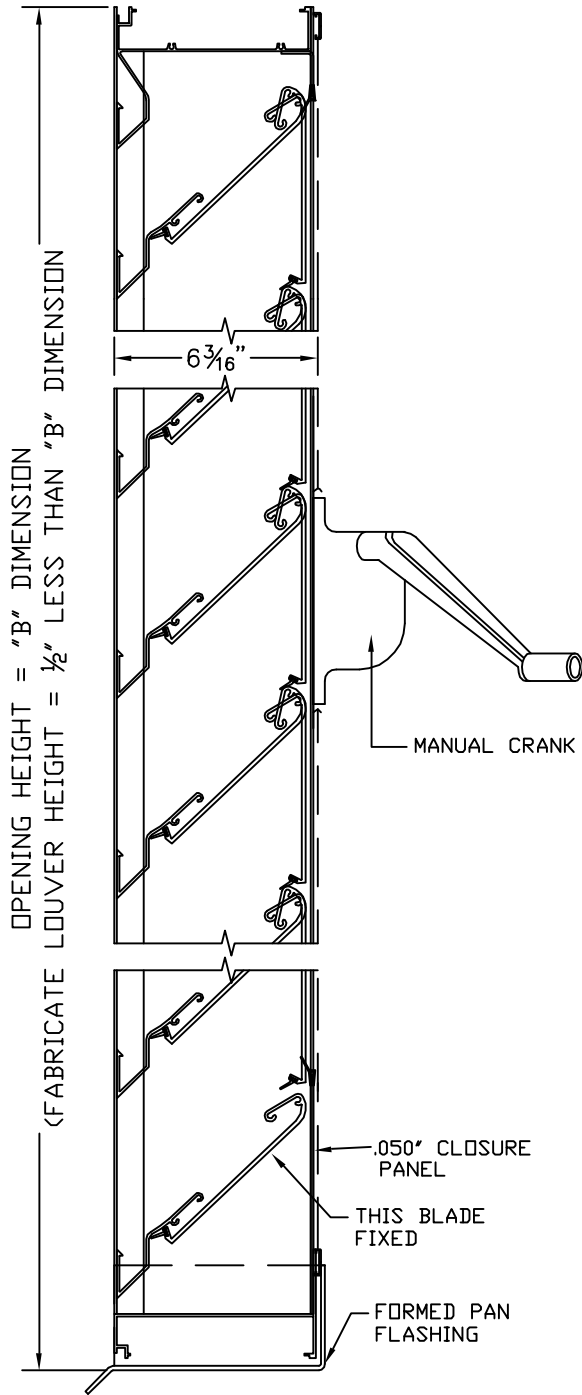

### SCREENS

- SCREEN NOT REQUIRED
- SCREEN REQUIRED
- INTERIOR MOUNTED
- EXTERIOR MOUNTED
- BIRDSCREEN (1/2" MESH)
- INSECT SCREEN (18x16 MESH)

### FINISHES

- STANDARD MILL
- DURACOLOR (400)
- KYNAR (500)
- (1) OF C/S STD. COLORS
- CUSTOM COLOR, C/S REQUIRES A COLOR CHIP FOR MATCHING
- ARCHITECTURAL CLASS I (DK. OR MED.) BRONZE ANODIC COATING
- 204-R1 CLEAR ANODIZE
- OTHER \_\_\_\_\_

C/S EXTRUDED ALUM. SPLIT BLADE FIXED/OPERATING DRAINABLE BLADE LOUVER MODEL 6917. FRAMES AND BLADES TO BE FABRICATED FROM 6063-T5 ALLOY, WITH REINFORCING BOSSES AND A NOMINAL .080" MATERIAL THICKNESS. ALL OPERATING BLADES TO BE PIVOTED ON ZAMAC ALLOY PINIONS OPERATING IN SELF-LUBRICATING NYLON BEARINGS. ALL FASTENERS TO BE STAINLESS STEEL. UNSUPPORTED BLADE LENGTH= @ PSF.

MARK	QTY.	"A" DIM.	"B" DIM.	NUMBER OF MULLIONS	LOCATION	REMARKS
						CKD. BY:

Construction Specialties, Inc.  
49 Meeker Avenue  
Cranford, New Jersey 07016  
(908) 272-5200  
Fax (908) 272-6038

PROJECT:	DRAWN BY:	
CUSTOMER:	DATE:	
ARCH'T:	DWG. NO:	
AGENT:	SHEET	OF

