



# Expansion Joint Covers

## SRJ & SRJW 300/1600 Series

### Technical Data:

#### Aluminum

- Extrusion – C/S uses multiple alloys & tempers which are established to be the most appropriate for the given use of individual parts. Will be one of the following:(6063-T5, T6, T52) (6061-T5, T6, T51) (6105-T5, T6) (6005-T5) (6005A-T5, T61)
- Sheet – 6061-T6, 3003-H14, 5005-H34, ASTM B209

#### Turnbar

- Material – C1075 Blue Temper Spring Steel
- Hardness - RC 44-47
- Finish - "A" Coating (Corrosion Protection).

#### Duroflex Gasket

- Duromete – 80 Shore A, ASTM D2000
- Color – Black

#### Vapor Barrier

- Material – Polyethelene, ASTM E-1745-97
- Color – Black
- 3" Tensile Strength – 275 lbs., ASTM-882
- Puncture Strength – 72 lbs., ASTM-4833
- PPT Resistance – 45 lbs., ASTM-2582

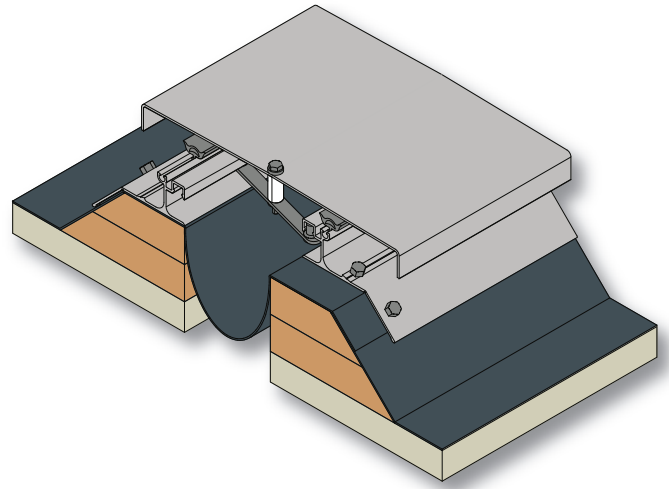

### Product Description:

Aluminum roof covers comprised of extruded aluminum components, spring steel turnbars, duroflex gaskets and polyethylene vapor barrier.

### Use This Cover For:

- Roof joint applications where occasional access is expected.
- Applications where exterior seals are used in walls and watertight transitions are critical.

### Performance Characteristics:

Available for movement of up to 100% of joint width in all horizontal directions. Available with custom factory made transitions to ensure watertight results.

### Standard Finishes:

Mill finish. Powder coated and Kynar® options available.

### Installation Guidelines:

Finish roof membrane up onto wooden curbs. Apply vapor barrier over roof membrane using mastic adhesive supplied. Adjust angle on aluminum side frame to suit angle of curb (up to 90°) and fasten through membrane and vapor barrier with fasteners provided. Attach cover plate using self-centering turnbars in accordance with manufacturer's instructions. (Note: all butt splices and factory made transitions to be installed in accordance with manufacturer's recommended sequencing.) For complete installation instructions, please visit [www.c-sgroup.com](http://www.c-sgroup.com).

To download detail, specs & photos visit [www.c-sgroup.com](http://www.c-sgroup.com)  
For technical and design assistance call 800-233-8493.

MODEL	JOINT WIDTH	MINIMUM OPENING	MAXIMUM OPENING	EXPOSED SURFACE	BLOCKOUT WIDTH	BLOCKOUT HEIGHT
SRJ-300	3.00" (76mm)	1.00" (25mm)	7.50" (191mm)	11.00" (279mm)	N/A	N/A
SRJ-400	4.00" (102mm)	1.00" (25mm)	7.50" (191mm)	12.00" (305mm)	N/A	N/A
SRJ-500	5.00" (127mm)	1.00" (25mm)	7.50" (191mm)	13.50" (343mm)	N/A	N/A
SRJ-600	6.00" (152mm)	1.00" (25mm)	11.75" (298mm)	15.00" (381mm)	N/A	N/A
SRJ-700	7.00" (178mm)	1.00" (25mm)	12.50" (318mm)	16.50" (419mm)	N/A	N/A
SRJ-800	8.00" (203mm)	1.00" (25mm)	12.50" (318mm)	18.00" (457mm)	N/A	N/A
SRJ-900	9.00" (229mm)	1.00" (25mm)	16.25" (413mm)	19.50" (495mm)	N/A	N/A
SRJ-1000	10.00" (254mm)	1.00" (25mm)	16.75" (425mm)	21.00" (533mm)	N/A	N/A
SRJ-1100	11.00" (279mm)	1.00" (25mm)	16.75" (425mm)	22.50" (572mm)	N/A	N/A
SRJ-1200	12.00" (305mm)	1.00" (25mm)	20.75" (527mm)	24.00" (610mm)	N/A	N/A
SRJ-1300	13.00" (330mm)	1.00" (25mm)	21.00" (533mm)	25.50" (648mm)	N/A	N/A
SRJ-1400	14.00" (356mm)	1.00" (25mm)	21.00" (533mm)	27.00" (686mm)	N/A	N/A
SRJ-1500	15.00" (381mm)	1.00" (25mm)	24.25" (616mm)	28.50" (724mm)	N/A	N/A
SRJ-1600	16.00" (406mm)	1.00" (25mm)	24.25" (616mm)	30.00" (762mm)	N/A	N/A
SRJW-300	3.00" (76mm)	0.00" (0mm)	5.25" (133mm)	7.00" (178mm)	N/A	N/A
SRJW-400	4.00" (102mm)	0.00" (0mm)	6.25" (159mm)	8.00" (203mm)	N/A	N/A
SRJW-500	5.00" (127mm)	0.00" (0mm)	7.50" (191mm)	9.25" (235mm)	N/A	N/A
SRJW-600	6.00" (152mm)	0.00" (0mm)	8.75" (222mm)	10.50" (267mm)	N/A	N/A
SRJW-700	7.00" (178mm)	4.00" (102mm)	9.75" (248mm)	11.75" (298mm)	N/A	N/A
SRJW-800	8.00" (203mm)	4.50" (114mm)	10.25" (260mm)	13.00" (330mm)	N/A	N/A
SRJW-900	9.00" (229mm)	5.00" (127mm)	12.50" (318mm)	14.25" (362mm)	N/A	N/A
SRJW-1000	10.00" (254mm)	5.50" (140mm)	13.25" (337mm)	15.50" (394mm)	N/A	N/A
SRJW-1100	11.00" (279mm)	6.00" (152mm)	13.75" (349mm)	16.75" (425mm)	N/A	N/A
SRJW-1200	12.00" (305mm)	6.50" (165mm)	16.25" (413mm)	18.00" (457mm)	N/A	N/A
SRJW-1300	13.00" (330mm)	7.00" (178mm)	17.06" (433mm)	19.25" (489mm)	N/A	N/A
SRJW-1400	14.00" (356mm)	7.50" (191mm)	17.50" (445mm)	20.50" (521mm)	N/A	N/A
SRJW-1500	15.00" (381mm)	8.00" (203mm)	19.50" (495mm)	21.75" (552mm)	N/A	N/A
SRJW-1600	16.00" (406mm)	8.50" (216mm)	20.00" (508mm)	23.00" (584mm)	N/A	N/A

Contact factory for larger sizes.

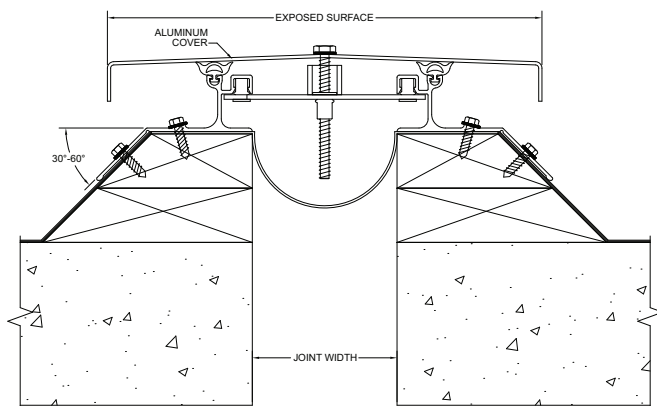

SRJ (typ.)

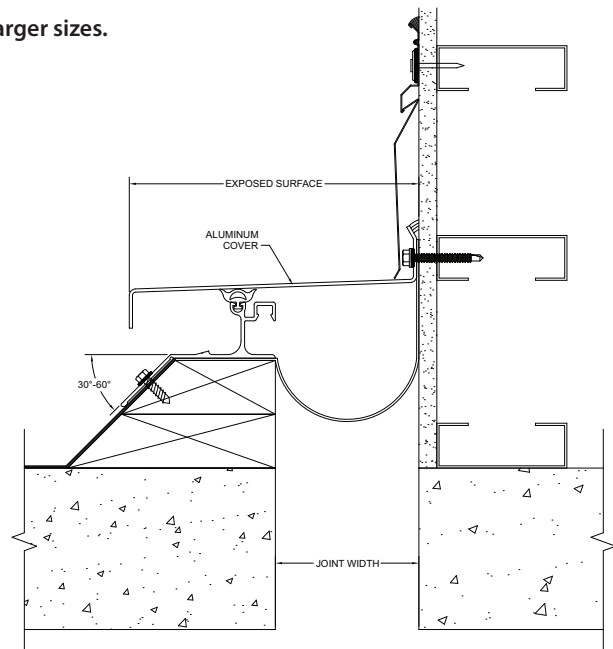

SRJW (typ.)