



# Expansion Joint Covers

## SJ-HDM Series

### Technical Data:

#### Aluminum

- Extrusion – C/S uses multiple alloys & tempers which are established to be the most appropriate for the given use of individual parts. Will be one of the following: (6063-T5, T6, T52) (6061-T5, T6, T51) (6105-T5, T6) (6005-T5) (6005A-T5, T61)
- Sheet – 6061-T6, 3003-H14, 5005-H34, ASTM B209

#### Standard Loading

- 2,000 lbs.

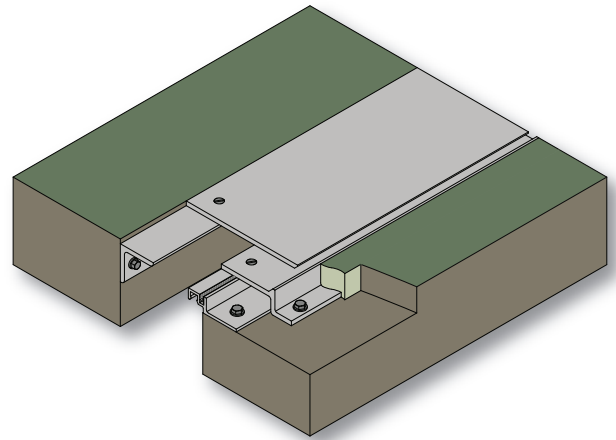

### Product Description:

This flush mounted metal floor cover is designed for new to existing interior or exterior applications. The joint can be designed for up to 100% movement, and heavy-duty rolling loads are expected.

### Use This Cover For:

- Interior or exterior seismic applications.
- Applications requiring movements up to 100% of joint width.
- Larger sizes available (contact factory).
- Optional waterstop available for wet areas.
- New to Existing conditions.

### Performance Characteristics:

Aluminum center plate remains flush during thermal movement, but temporarily displaces and slides over floor surface during seismic movement.

### Standard Finishes:

Mill finish. Aluminum surfaces in contact with concrete will be protected with a minimum 2 mil coating of a heavy metal free high solids primer.

### Installation Guidelines:

The blockouts must be prepared to receive the joint cover. It is recommended that the breakout be formed a minimum of 1/8" deeper to allow the base to be leveled prior to installation of the joint cover. Apply a high-strength leveling grout to the base of the blockouts to provide a continuous, solid, flat and level base for the joint cover. (Note: The blockouts must be level across the joint opening.) Install base frame in breakout and ledge frame to face of existing slab with C/S supplied fasteners. Attach cover plate to ledge frame. For complete installation instructions, please visit [www.c-sgroup.com](http://www.c-sgroup.com).

MODEL	JOINT WIDTH	MINIMUM OPENING	MAXIMUM OPENING	EXPOSED SURFACE	BLOCKOUT WIDTH	BLOCKOUT HEIGHT
SJ-200HDM	2.00" (51mm)	1.00" (25mm)	4.50" (114mm)	5.38" (137mm)	4.63" (117mm)	1.38" (35mm)
SJ-300HDM	3.00" (76mm)	1.50" (38mm)	5.50" (140mm)	6.38" (162mm)	4.63" (117mm)	1.38" (35mm)
SJ-400HDM	4.00" (102mm)	2.00" (51mm)	6.50" (165mm)	7.38" (187mm)	4.63" (117mm)	1.38" (35mm)
SJ-500HDM	5.00" (127mm)	2.00" (51mm)	7.50" (191mm)	8.38" (213mm)	4.63" (117mm)	1.38" (35mm)
SJ-600HDM	6.00" (152mm)	4.13" (105mm)	7.38" (187mm)	9.38" (238mm)	4.63" (117mm)	1.38" (35mm)
SJ-700HDM	7.00" (178mm)	4.75" (121mm)	10.38" (264mm)	10.38" (264mm)	4.63" (117mm)	1.38" (35mm)
SJ-800HDM	8.00" (203mm)	5.13" (130mm)	10.88" (276mm)	11.38" (289mm)	4.63" (117mm)	1.38" (35mm)

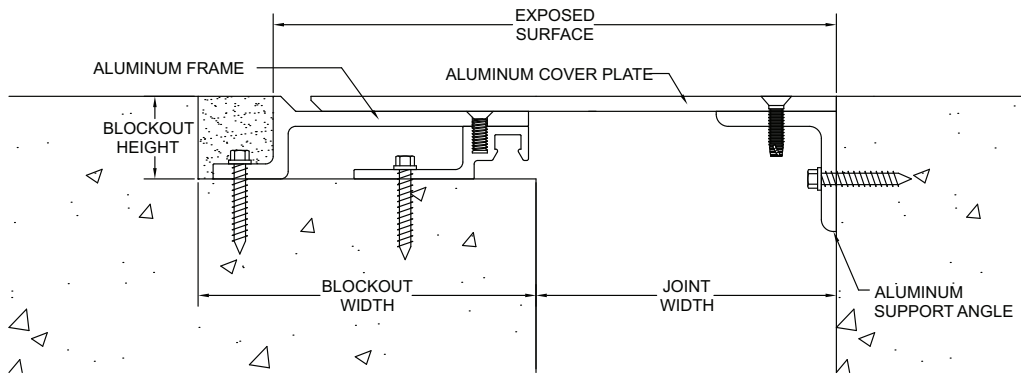

SJ-HDM (TYP.)