



Expansion Joint Covers

SGC & SGCC Series

Technical Data:

Aluminum

- Extrusion – C/S uses multiple alloys & tempers which are established to be the most appropriate for the given use of individual parts. Will be one of the following:(6063-T5, T6, T52) (6061-T5, T6, T51) (6105-T5, T6) (6005-T5) (6005A-T5, T61)
- Sheet – 6061-T6, 3003-H14, 5005-H34, ASTM B209

Turnbar

- Material - C1075 Blue Temper Spring Steel
- Hardness - RC 44-47
- Finish - "A" Coating (Corrosion Protection)

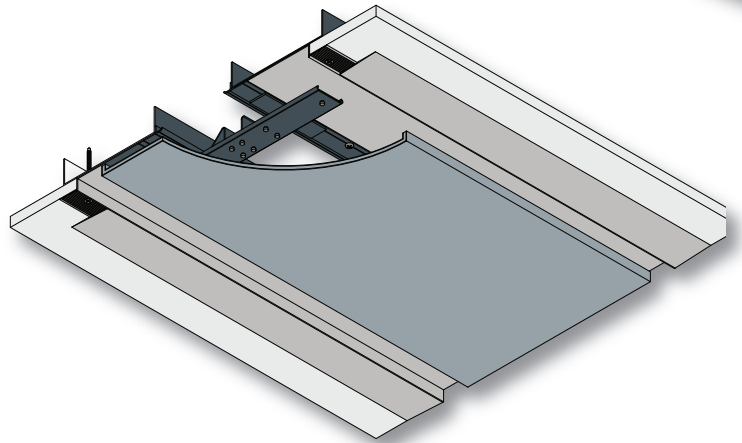

Product Description:

This self-centering, flush ceiling cover is ideal for areas with larger movement requirements. This model is also designed to match flush Twinline covers used on the wall.

Use This Cover For:

- Ceiling applications to match flush Twinline covers used on the wall.
- Suitable for most ceiling finishes.
- Where hygiene is important.

Performance Characteristics:

Durable self-centering aluminum plate spans joint opening and can be painted to match nearly any finish.

Standard Finishes:

Clear anodize finish on any exposed aluminum. Cover plate can be painted to match adjacent ceiling finishes.

Installation Guidelines:

The ceiling structure must be prepared to receive the joint cover. It must be plumb, square, and level across the width of the joint. Attach the aluminum frames to ceiling using mechanical fasteners. This model also features a turnbar assembly. There are some great tips in the complete C/S installation instructions. For the complete installation instructions, please visit www.c-sgroup.com.

MODEL	JOINT WIDTH	MINIMUM OPENING	MAXIMUM OPENING	EXPOSED SURFACE	BLOCKOUT WIDTH	BLOCKOUT HEIGHT
SGC-500	5.00" (127mm)	2.75" (70mm)	9.00" (229mm)	13.75" (349mm)	3.50" (89mm)	0.63" (16mm)
SGC-600	6.00" (152mm)	2.75" (70mm)	9.25" (235mm)	14.75" (375mm)	3.50" (89mm)	0.63" (16mm)
SGC-700	7.00" (178mm)	2.75" (70mm)	12.00" (305mm)	16.75" (425mm)	4.00" (102mm)	0.63" (16mm)
SGC-800	8.00" (203mm)	2.75" (70mm)	13.00" (330mm)	17.75" (451mm)	4.00" (102mm)	0.63" (16mm)
SGC-900	9.00" (229mm)	2.75" (70mm)	14.00" (356mm)	19.75" (502mm)	4.50" (114mm)	0.63" (16mm)
SGC-1000	10.00" (254mm)	2.75" (70mm)	16.00" (406mm)	20.75" (527mm)	4.50" (114mm)	0.63" (16mm)
SGC-1100	11.00" (279mm)	2.75" (70mm)	18.00" (457mm)	22.75" (578mm)	5.00" (127mm)	0.63" (16mm)
SGC-1200	12.00" (305mm)	2.75" (70mm)	18.50" (470mm)	23.75" (603mm)	5.00" (127mm)	0.63" (16mm)
SGC-1300	13.00" (330mm)	2.75" (70mm)	21.00" (533mm)	25.75" (654mm)	5.50" (140mm)	0.63" (16mm)
SGC-1400	14.00" (356mm)	2.75" (70mm)	22.00" (559mm)	26.75" (679mm)	5.50" (140mm)	0.63" (16mm)
SGC-1500	15.00" (381mm)	2.75" (70mm)	22.75" (578mm)	28.75" (730mm)	6.00" (152mm)	0.63" (16mm)
SGC-1600	16.00" (406mm)	2.75" (70mm)	25.00" (635mm)	29.75" (756mm)	6.00" (152mm)	0.63" (16mm)
SGCC-500	5.00" (127mm)	3.75" (95mm)	7.00" (178mm)	9.38" (238mm)	3.50" (89mm)	0.63" (16mm)
SGCC-600	6.00" (152mm)	4.25" (108mm)	7.50" (191mm)	10.38" (264mm)	3.50" (89mm)	0.63" (16mm)
SGCC-700	7.00" (178mm)	5.00" (127mm)	9.50" (241mm)	11.88" (302mm)	4.00" (102mm)	0.63" (16mm)
SGCC-800	8.00" (203mm)	5.50" (140mm)	10.50" (267mm)	12.88" (327mm)	4.00" (102mm)	0.63" (16mm)
SGCC-900	9.00" (229mm)	6.00" (152mm)	11.50" (292mm)	14.38" (365mm)	4.50" (114mm)	0.63" (16mm)
SGCC-1000	10.00" (254mm)	6.50" (165mm)	13.00" (330mm)	15.38" (391mm)	4.50" (114mm)	0.63" (16mm)
SGCC-1100	11.00" (279mm)	7.00" (178mm)	14.50" (368mm)	16.88" (429mm)	5.00" (127mm)	0.63" (16mm)
SGCC-1200	12.00" (305mm)	7.50" (191mm)	15.25" (387mm)	17.88" (454mm)	5.00" (127mm)	0.63" (16mm)
SGCC-1300	13.00" (330mm)	8.00" (203mm)	17.00" (432mm)	19.38" (492mm)	5.50" (140mm)	0.63" (16mm)
SGCC-1400	14.00" (356mm)	8.50" (216mm)	18.00" (457mm)	20.38" (518mm)	5.50" (140mm)	0.63" (16mm)
SGCC-1500	15.00" (381mm)	9.00" (229mm)	18.75" (476mm)	21.88" (556mm)	6.00" (152mm)	0.63" (16mm)
SGCC-1600	16.00" (406mm)	9.50" (241mm)	20.50" (521mm)	22.88" (581mm)	6.00" (152mm)	0.63" (16mm)

For larger size joints, call (800) 233-8493 or visit www.c-sgroup.com

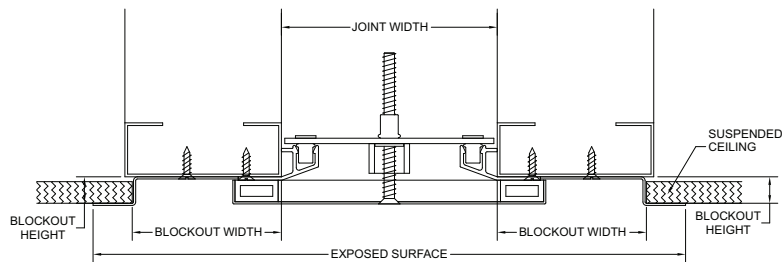

SGC (TYP.)

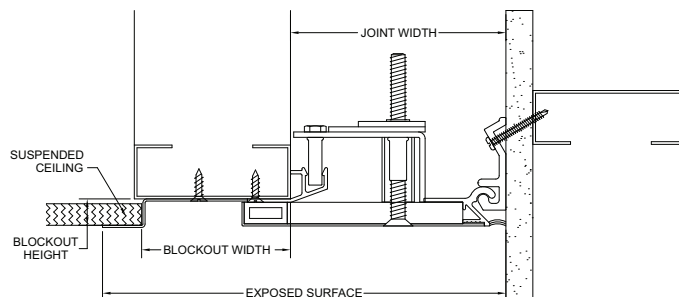

SGCC (TYP.)