



# Expansion Joint Covers

## SC 1100/1600 Series

### Technical Data:

#### Aluminum

- Extrusion – C/S uses multiple alloys & tempers which are established to be the most appropriate for the given use of individual parts. Will be one of the following:(6063-T5, T6, T52) (6061-T5, T6, T51) (6105-T5, T6) (6005-T5) (6005A-T5, T61)

#### Santoprene™ Primary Seal

- Single Durometer: 70 Shore A, ASTM D2000
- Color: 4 standard
- Brittle Point: -76°F
- Ozone Resistance: No Cracks, ASTM D1149
- UV Resistance: Very Good

#### Vapor Barrier

- Material – Polyethylene, ASTM E-1745-97
- Color – Black.
- 3" Tensile Strength – 275 lbs., ASTM-882
- Puncture Strength – 72 lbs., ASTM-4833
- PPT Resistance – 45 lbs., ASTM-2582

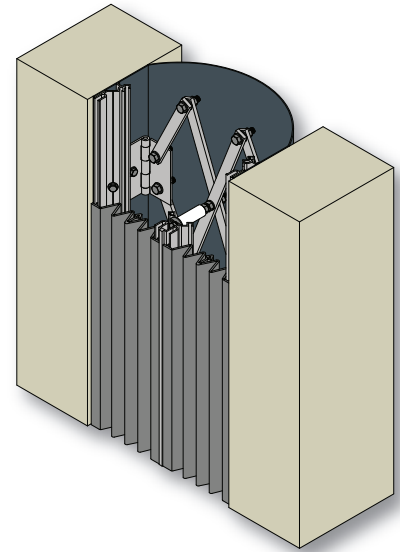

### Product Description:

SC is a gasketed exterior wall cover comprised of extruded aluminum frames, a Santoprene™ primary seal and polyethylene vapor barrier. Multiple seals are used in combination to accommodate 100% movement. Seals are supported with pantograph support assemblies.

### Use This Cover For:

- Exterior vertical applications where weather protection is critical.
- Frames designed to attach to most exterior finishes.
- 11" to 16" joint sizes with multi-directional movement. (Contact factory for larger sizes)
- Factory welded transitions available.
- Four standard gasket colors.

### Performance Characteristics:

Serrated profile, colorable seals for exterior applications, expand and compress during movement while providing a weather tight seal.

### Standard Finishes:

Gasket is available in Black, White, Gray and Greige. Custom colors available).

### Installation Guidelines:

No blockouts required. The joint width should be consistent and smooth, respective to its nominal size. Apply butyl tape to aluminum frame and attach inside joint opening with C/S supplied fasteners. Install pantograph support system behind frames. Apply sealant to aluminum frames and insert secondary seal and primary seal. For the complete installation instructions, please visit [www.c-sgroup.com](http://www.c-sgroup.com).

To download detail, specs & photos visit [www.c-sgroup.com](http://www.c-sgroup.com)  
For technical and design assistance call 800-233-8493.

MODEL	JOINT WIDTH	MINIMUM OPENING	MAXIMUM OPENING	EXPOSED SURFACE	BLOCKOUT WIDTH	BLOCKOUT HEIGHT
SC-1100	11.00" (279mm)	6.00" (152mm)	22.00" (559mm)	11.00" (279mm)	N/A	N/A
SC-1200	12.00" (305mm)	6.00" (152mm)	24.00" (610mm)	12.00" (305mm)	N/A	N/A
SC-1300	13.00" (330mm)	6.00" (152mm)	26.00" (660mm)	13.00" (330mm)	N/A	N/A
SC-1400	14.00" (356mm)	6.00" (152mm)	28.00" (711mm)	14.00" (356mm)	N/A	N/A
SC-1500	15.00" (381mm)	6.00" (152mm)	30.00" (762mm)	15.00" (381mm)	N/A	N/A
SC-1600	16.00" (406mm)	6.00" (152mm)	32.00" (813mm)	16.00" (406mm)	N/A	N/A

For odd and larger size joints, call (800) 233-8493 or visit [www.c-sgroup.com](http://www.c-sgroup.com)

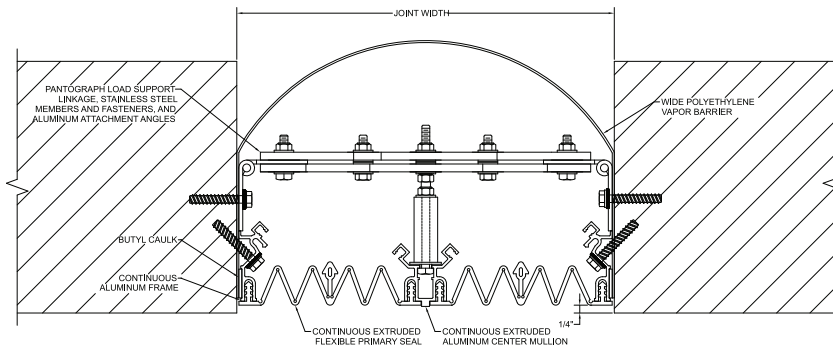

SC-1100/1600

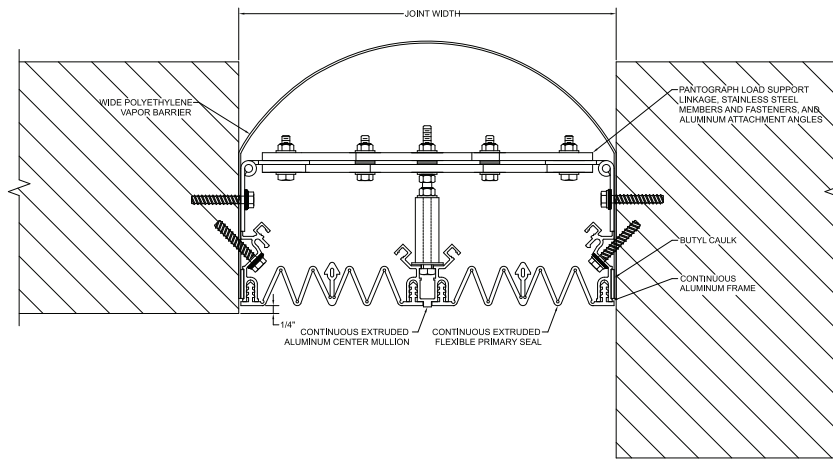

SC-1100/1600 (Corner)