



# Expansion Joint Covers

## RJT & RJTW 100/200 Series

### Technical Data:

#### Aluminum

- Extrusion – C/S uses multiple alloys & tempers which are established to be the most appropriate for the given use of individual parts. Will be one of the following: (6063-T5, T6, T52) (6061-T5, T6, T51) (6105-T5, T6) (6005-T5) (6005A-T5, T61)

#### Duroflex Gasket

- Single Durometer – 85 Shore A, ASTM D2000
- Color – Gray

#### Vapor Barrier

- Material – Polyethylene, ASTM E-1745-97
- Color – Black
- 3" Tensile Strength – 275 lbs., ASTM-882
- Puncture Strength – 72 lbs., ASTM-4833
- PPT Resistance – 45 lbs., ASTM-2582

#### Turnbar

- Injection Molded

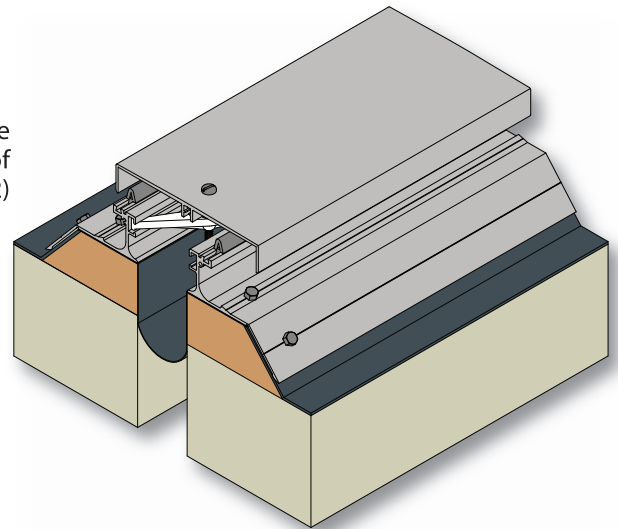

### Product Description:

Aluminum roof covers comprised of extruded aluminum components, injection molded turnbar, duroflex gaskets and polyethylene vapor barrier.

### Use This Cover For:

- Roof joint applications where occasional access is expected.
- Applications where exterior seals are used in walls and watertight transitions are critical.

### Performance Characteristics:

Available for movement of up to 50% of joint width in all horizontal directions. Available with custom factory made transitions to ensure watertight results.

### Standard Finishes:

Mill finish. Powder coat & Kynar® options available.

### Installation Guidelines:

Finish roof membrane up onto wooden curbs. Apply vapor barrier over roof membrane using mastic adhesive supplied. Adjust angle on aluminum side frame to suit angle of curb (up to 90°) and fasten through membrane and vapor barrier with fasteners provided. The cover plate is retained by the injection molded turnbars, which engage in the frames. (Note: all butt splices and factory made transitions to be installed in accordance with manufacturer's recommended sequencing.) For complete installation instructions, please visit [www.c-sgroup.com](http://www.c-sgroup.com).

MODEL	JOINT WIDTH	MINIMUM OPENING	MAXIMUM OPENING	EXPOSED SURFACE	BLOCKOUT WIDTH	BLOCKOUT HEIGHT
RJT-100	1.00" (25mm)	0.13" (3mm)	2.63" (67mm)	5.75" (146mm)	N/A	N/A
RJT-200	2.00" (51mm)	0.13" (3mm)	3.63" (92mm)	5.75" (146mm)	N/A	N/A
RJTW-100	1.00" (25mm)	0.13" (3mm)	2.38" (60mm)	3.88" (98mm)	N/A	N/A
RJTW-200	2.00" (51mm)	0.13" (3mm)	2.88" (73mm)	3.88" (98mm)	N/A	N/A

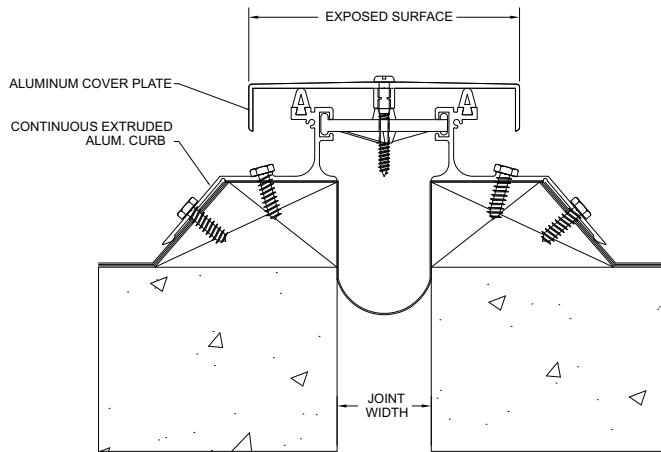

RJT (typ.)

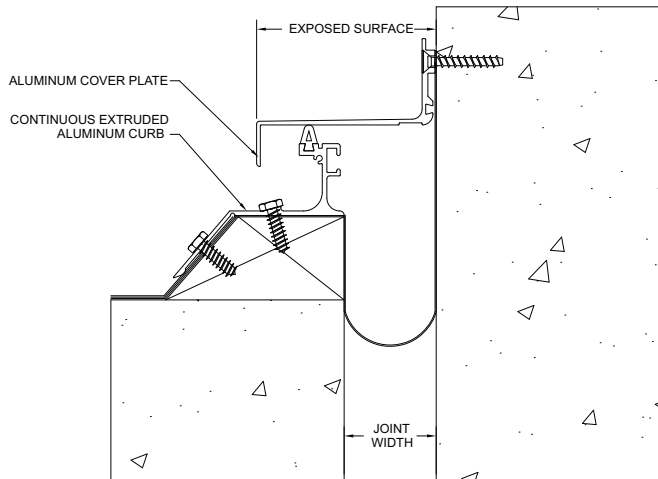

RJTW (typ.)