



Expansion Joint Covers

RJT-V & RJTW-V 100/200 Series

Technical Data:

Aluminum

- Extrusion – C/S uses multiple alloys & tempers which are established to be the most appropriate for the given use of individual parts. Will be one of the following: (6063-T5, T6, T52) (6061-T5, T6, T51) (6105-T5, T6) (6005-T5) (6005A-T5, T61)

Duroflex Gasket

- Single Durometer – 85 Shore A, ASTM D2000
- Color – Gray

Vapor Barrier

- Material – Polyethylene, ASTM E-1745-97
- Color – Black
- 3" Tensile Strength – 275 lbs., ASTM-882
- Puncture Strength – 72 lbs., ASTM-4833
- PPT Resistance – 45 lbs., ASTM-2582

Turnbar

- Injection Molded

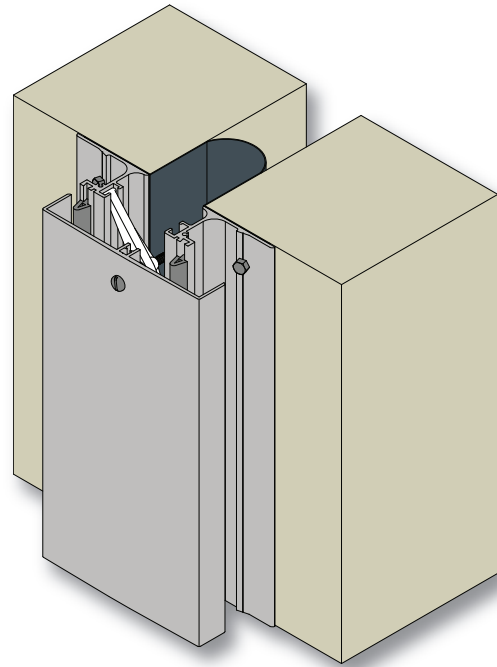

Product Description:

Aluminum wall covers comprised of extruded aluminum components, injection molded turnbar, duroflex gaskets and polyethylene vapor barrier.

Use This Cover For:

- Exterior wall joint applications.

Performance Characteristics:

Available for movement of up to 50% of joint width. Available with custom factory made transitions to ensure watertight results.

Standard Finishes:

Mill finish. Powder coated or Kynar® options available.

Installation Guidelines:

Install the frames with C/S supplied anchor bolts. The cover plate is retained by the injection molded turn bars, which engage in the frames. (Note: all butt splices and factory made transitions to be installed in accordance with manufacturer's recommended sequencing.) For complete installation instructions, please visit www.c-sgroup.com

MODEL	JOINT WIDTH	MINIMUM OPENING	MAXIMUM OPENING	EXPOSED SURFACE	BLOCKOUT WIDTH	BLOCKOUT HEIGHT
RJT-100	1.00" (25mm)	0.13" (3mm)	2.63" (67mm)	5.75" (146mm)	N/A	N/A
RJT-200	2.00" (51mm)	0.13" (3mm)	3.63" (92mm)	5.75" (146mm)	N/A	N/A
RJTW-100	1.00" (25mm)	0.13" (3mm)	2.38" (60mm)	3.88" (98mm)	N/A	N/A
RJTW-200	2.00" (51mm)	0.13" (3mm)	2.88" (73mm)	3.88" (98mm)	N/A	N/A

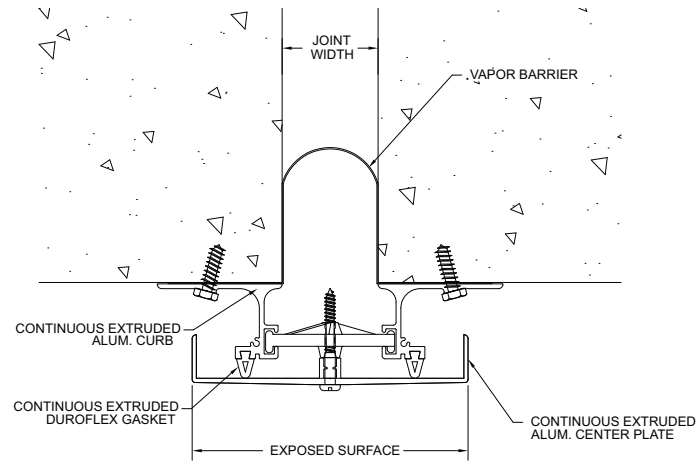

RJT-V (Typ.)

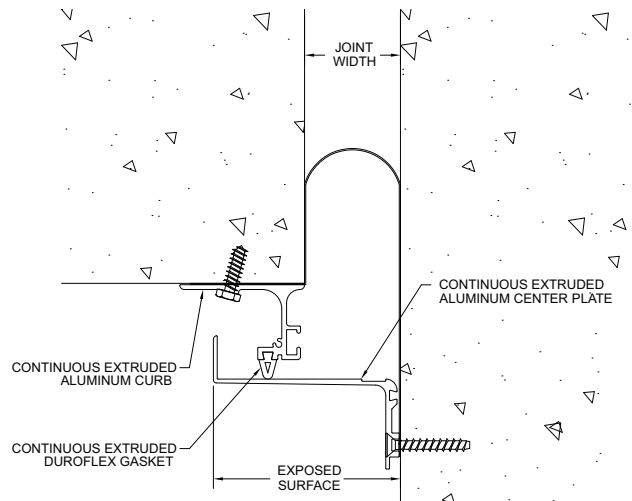

RJTW-V (Typ.)