



# Expansion Joint Covers

## HB 100/400 Series

### Technical Data:

#### Seal

- Material – EPDM
- Color – Black
- Durometer – 74 Shore A, ASTM D2240

#### Epoxy

- 2 part
- Gel Time – 35 minutes, ASTM C881
- Bond Strength (2 day cure) – 2,232 psi, ASTM C882
- Bond Strength (14 day cure) – 2,460 psi, ASTM C880
- Compressive Modulus – 250,100 psi, ASTM D695

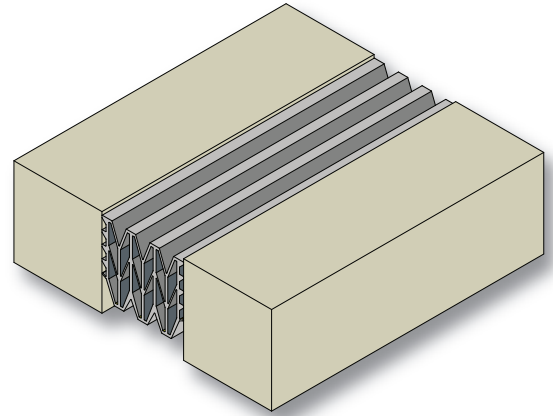

### Product Description:

The HB series expansion joint system is a one-piece, extruded EPDM elastomeric seal with integral epoxy reservoirs, bonded into a high-strength epoxy bedding, designed for use in parking deck and other watertight concrete deck applications. Proper installations will result in an extremely durable and watertight joint system, which achieves +/- 50% movement capability.

### Use This Cover For:

- Seismic applications in parking and other areas with vehicular access.

### Performance Characteristics:

The closed cell design allows this watertight joint system to achieve a +/- 50% movement capability.

### Standard Finishes:

Seal is available in black only.

### Installation Guidelines:

The joint must be sandblasted to expose new concrete and remove all form release agents and other foreign materials. The surface of the joint must be clean and free from any loose dust, dirt, debris and oils that would affect the installation of the seal, or adhesion of the epoxy. The two-part epoxy must be mixed in the field and has a gel time between 20 to 35 minutes (depending on the temperature outside). For complete installation instructions, please visit [www.c-sgroup.com](http://www.c-sgroup.com).

| MODEL  | JOINT WIDTH   | MINIMUM OPENING | MAXIMUM OPENING | EXPOSED SURFACE | BLOCKOUT WIDTH | BLOCKOUT HEIGHT |
|--------|---------------|-----------------|-----------------|-----------------|----------------|-----------------|
| HB-100 | 1.00" (25mm)  | 0.50" (13mm)    | 1.50" (38mm)    | 1.00" (25mm)    | N/A            | N/A             |
| HB-200 | 2.00" (51mm)  | 1.00" (25mm)    | 3.00" (76mm)    | 2.00" (51mm)    | N/A            | N/A             |
| HB-300 | 3.00" (76mm)  | 1.50" (38mm)    | 4.50" (114mm)   | 3.00" (76mm)    | N/A            | N/A             |
| HB-400 | 4.00" (102mm) | 2.00" (51mm)    | 6.00" (152mm)   | 4.00" (102mm)   | N/A            | N/A             |

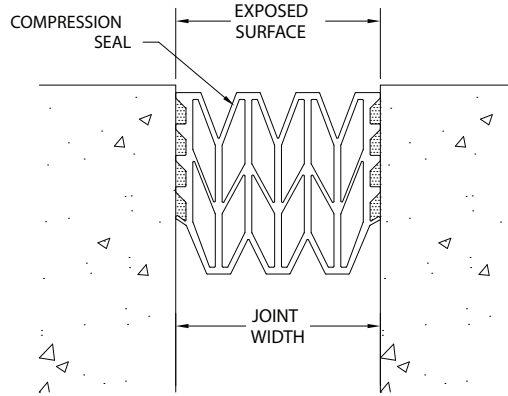

HB (TYP.)

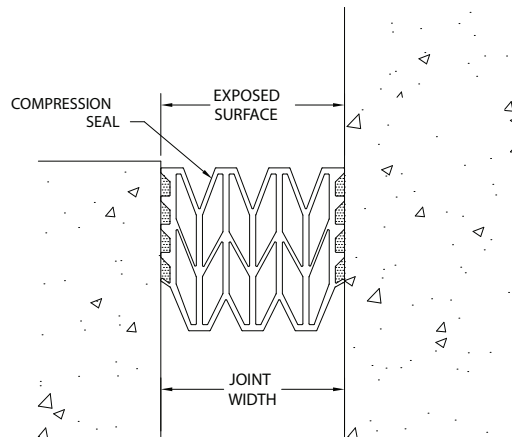

HB (TYP. - Corner)