



Expansion Joint Covers

GFS-W & GFSW-W Series

Technical Data:

Aluminum

- Extrusion – C/S uses multiple alloys & tempers which are established to be the most appropriate for the given use of individual parts. Will be one of the following:(6063-T5, T6, T52) (6061-T5, T6, T51) (6105-T5, T6) (6005-T5) (6005A-T5, T61)

Primary Seal

- Dual Durometer 65 Shore A, 90 Shore A, ASTM-D2000
- Available in 4 colors.

Product Description:

GFS-W / GFSW-W is a gasketed wall joint cover comprised of extruded aluminum frames and a TPR seal. The extruded aluminum wall frame is designed to provide a minimal bump in a surface-mounted application.

Use This Cover For:

- Applications with small, interior joints where minimal visual impact is preferred.
- Suitable for all wall finishes.
- Where hygiene is important.
- 1" and 2" joints.

Performance Characteristics:

The dual durometer thermoplastic gasket has rigid edges designed to lock into the aluminum side frames. This prevents hairline gaps from opening between the gasket and frame ensuring a hygienic seal. The softer center section of the gasket allows full movement without the need for grooves in the top surface which collect dirt.

Standard Finishes:

Mill finish. Gasket is available in Black, White, Gray, & Greige.

Installation Guidelines:

No blockouts required. System attaches to surface of substrate by using mechanical fasteners. For complete installation instructions, please visit www.c-sgroup.com.

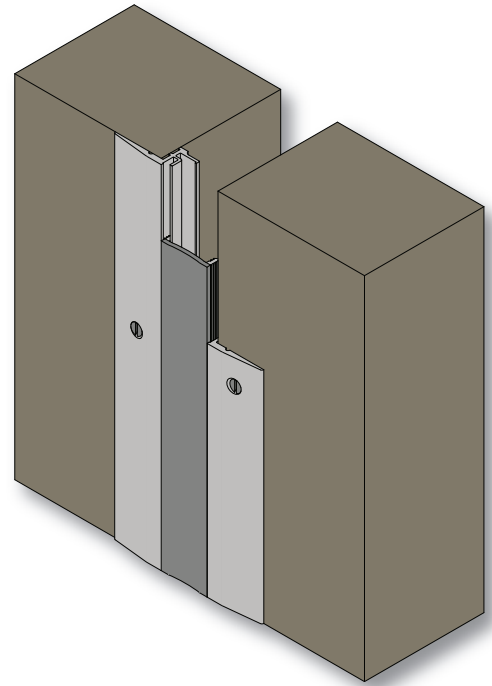

MODEL	JOINT WIDTH	MINIMUM OPENING	MAXIMUM OPENING	EXPOSED SURFACE	BLOCKOUT WIDTH	BLOCKOUT HEIGHT
GFS-100W	1.00" (25mm)	0.75" (19mm)	1.25" (32mm)	4.31" (109mm)	N/A	N/A
GFS-200W	2.00" (51mm)	1.50" (38mm)	2.50" (64mm)	5.13" (130mm)	N/A	N/A
GFSW-100W	1.00" (25mm)	0.75" (19mm)	1.25" (32mm)	2.66" (68mm)	N/A	N/A
GFSW-200W	2.00" (51mm)	1.50" (38mm)	2.50" (64mm)	3.56" (90mm)	N/A	N/A

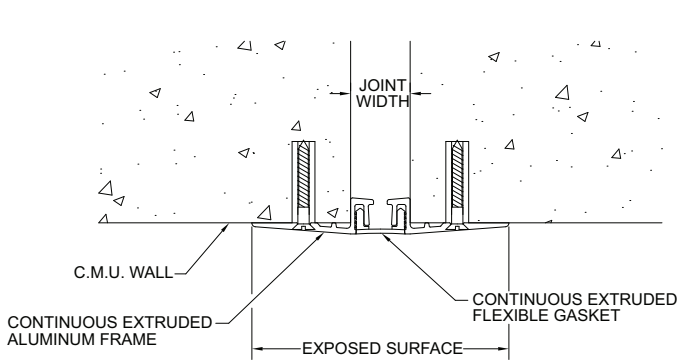

GFS-100W

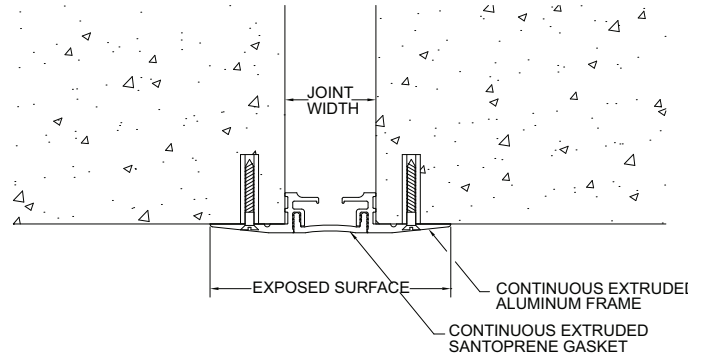

GFS-200W

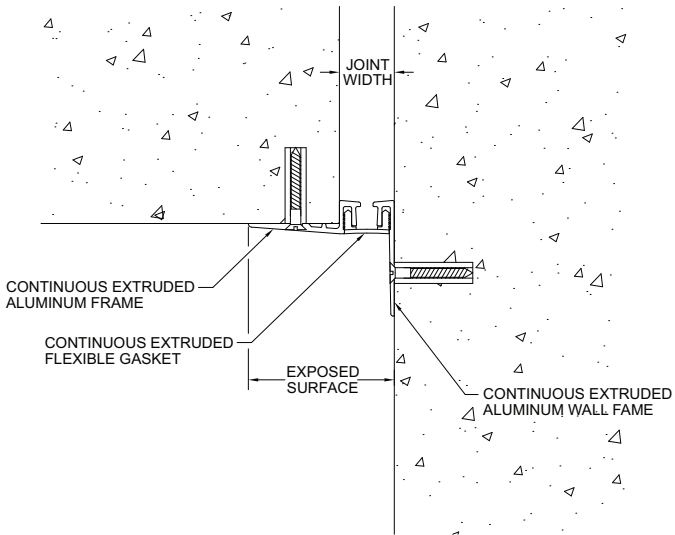

GFSW-100W

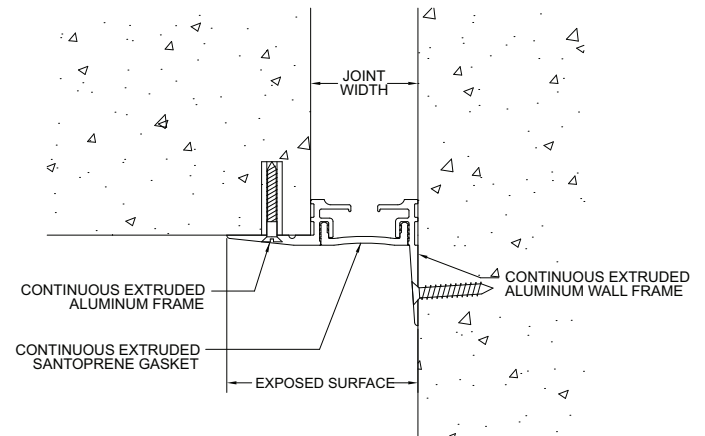

GFSW-200W