

Acrovyn® Doors

Tech Data Manual



Construction Specialties®

Table of Contents

Overview of Acrovyn Door Systems-----	4
Performance Attributes-----	5
LEED v4.0 Contributions-----	6
LEED 2009 v3.0 Contributions-----	7
Lite Kit Options-----	8
Lite Kit Options (Cont.)-----	9
Door Edge Options-----	10
Astragal Options-----	11
Standard Panel Door Designs-----	12
→ Panel Door Details-----	13 - 20

Product Data Sheets

Non-Rated Lightweight Core (FC5-NR)-----	21
Non-Rated Agrifiber (AF5-NR)-----	22
Non-Rated FSC Particleboard (FSC-PC5-NR)-----	23
Non-Rated Particleboard (PC5-NR)-----	24
Non-Rated SCL (SCL5-NR)-----	25
Non-Rated Panel Door (PN SCL5-NR)-----	26
Non-Rated Barrier Resistant (BR SCL5-NR)-----	27
Non-Rated Dutch Door (DD SCL5-NR)-----	28
Non-Rated STC30 (SCL5-NR STC 30)-----	29
Non-Rated STC43-46 (SCL5-NR STC 43-46)-----	30
20 Minute Rated Agrifiber (AF5-20PP)-----	31
20 Minute Rated FSC Particleboard (FSC PC5-20PP)-----	32
20 Minute Rated Particleboard (PC5-20PP)-----	33
20 Minute Rated SCL (SCL5-20PP)-----	34
20 Minute Rated Panel Door (PN SCL5-20PP)-----	35
20 Minute Rated Barrier Resistant (BR SCL5-20PP)-----	36
20 Minute Rated Dutch Door (DD SCL5-20PP)-----	37

Table of Contents

45 Minute Rated Mineral (FD5-45PP) -----	38
45 Minute Rated Mineral STC35/34 (FD5-45PP STC 35/34) -----	39
45 Minute Rated Panel Door (PN FD7-45PP) -----	40
60 Minute Rated Mineral (FD5-60PP) -----	41
60 Minute Rated Mineral STC35/34 (FD5-60PP STC 35/34) -----	42
60 Minute Rated Panel Door (PN FD7-60PP) -----	43
90 Minute Rated Mineral (FD5-90PP) -----	44
90 Minute Rated Mineral STC36 (FD5-90PP STC 36) -----	45
 Lead Lined, Non-Rated Agrifiber (LL AF7-NR) -----	 46
Lead Lined, Non-Rated FSC Particleboard (LL FSC7-NR) -----	47
Lead Lined, Non-Rated Particleboard (LL PC7-NR) -----	48
Lead Lined, Non-Rated SCL (LL SCL7-NR) -----	49
 Lead Lined, 20 Minute Rated FSC Particleboard (LL FSC7-20PP) -----	 50
Lead Lined, 20 Minute Rated Particleboard (LL PC7-20PP) -----	51
Lead Lined, 45 Minute Rated Mineral (LL FD7-45PP) -----	52
Lead Lined, 60 Minute Rated Mineral (LL FD7-60PP) -----	53
 <u>Additional Information</u>	
Bulletin: Concealed Closers/Stops -----	54
Concealed Closers/Stops Intumescent Installation -----	55

Overview of Acrovyn Door Systems

Features & Benefits

- Acrovyn Doors will not tear, chip, or crack. Key to the doors durability is the rugged Acrovyn face and edge material.
- Acrovyn is 5 times as abrasion resistant as wood and twice as resistant as HPL.
- Integrated Acrovyn or stainless steel radiused edge guards wrap around both door stiles to provide the ultimate damage protection
- If ever damaged, the Acrovyn Door's edge guards & stiles can be easily replaced in the field for a longer door life.*
- Contains no PBT's & is completely free of PVC
- Standard line of Acrovyn Doors are C2C certified at the Silver level

Acrovyn Face & Edge Finish Options

- 20 standard woodgrain & 2 metal Chameleon Acrovyn finishes available in a smooth suede texture
- 67 standard Acrovyn solid colors
- Stainless steel edges available in 20Ga type 304, #4 finish

Technical Data

- Standards: WDMA I.S.1-A Extra Heavy Duty Door
- Lites & Louvers: Cutouts, vision kits, glazing, and louvers available*
- Pre-machining available for all mortise hardware from manufacturer's templates & approved shop drawings
- Warranty: Limited Lifetime
- Top & bottom rails are factory sealed with an approved sealant.

*As noted on the individual product data sheets

Standard Construction



U.S. Patents:

7,621,102; 7,587,876; 7,775,013-B2; 7,886,501-B2.

U.S. Design Patents:

D512 785S; D515 713S; D517 224S; D517 701S; D518 185S

Performance Attributes

All Door Products*

- **Cycle Slam:** Extra Heavy Duty per WDMA TM-7, -2,000,000 cycles (2x the WDMA requirement)
- **Hinge Loading:** Extra Heavy Duty per WDMA TM-8
- **Screw Holding:** Extra Heavy Duty per WDMA TM-10
- **Door Finish Wear Index:** ASTM D4060-90 (Abrasion Resistance Testing)
- **Door Finish Chemical Resistance Testing:** ASTM D1308-93
- **Door Finish Impact Resistance:** ASTM D-4226
- **Warp Tolerance:** WDMA TM-2
- **Stain Resistance/Cleanability:** ASTM D1308-93 (Common Stains Easily Removed)
- **Resistance to Fungi:** ASTM G-21-96 – Zero Fungal Growth (On Acrovyn Sheet)
- **Resistance to Bacteria:** ASTM G-22-96 – Zero Bacterial Growth (On Acrovyn Sheet)
- **Resistance to Fungi:** ASTM G-21-2013 – Zero Fungal Growth (At Replaceable Edge Seam)
- **Resistance to Bacteria:** ASTM G-22-2013 – Zero Bacterial Growth (At Replaceable Edge Seam)

WDMA I.S.1A Flush Wood Door Minimum Performance Standards

Performance Attribute	Performance Duty Level		
	Extra Heavy Duty	Heavy Duty	Standard Duty
Adhesive Bond Durability, WDMA TM-6	Type I or Type II	Type I or Type II	Type I or Type II
Cycle Slam, WDMA TM-7	1,000,000 cycles	500,000 cycles	250,000 cycles
Hinge-Loading, WDMA TM-8	550 lbs. (2440 N)	475 lbs. (4110 N)	400 lbs. (1780 N)
Door Finishes Various ASTM test methods	TR-6/OP-6 or equal **	TR-4/OP-4 or equal **	TR-2/OP-2 or equal **
Screwholding, WDMA TM-10 Door Face (Blocked or unblocked) Vertical Door Edge Horizontal Door Edge	550 lbs. (2440 N)	475 lbs. (2110 N)	400 lbs. (1780 N)***
	550 lbs. (2440 N)	475 lbs. (2110 N)	400 lbs. (1780 N)
	300 lbs. (1330 N)	240 lbs. (1060 N)	180 lbs. (810 N)
Telegraph, Section T-1	Maximum 0.010 inch in any 3 inch span (0.25 mm in any 76 mm span)		
Warp Tolerance, Section T-2	Maximum 0.25 inch in any 3'-6" x 7'-0" (6.4 mm in any 1050 mm x 2100 mm) door section		
Squareness, Section T-3	Diagonal variance 1/8 inch (3.2 mm)		

* Acrovyn Door model FC5-NR, meets Extra Heavy Duty for all sections above with the exception of "Screwholding WDMA TM-10 (unblocked)"

** Other formulations may exhibit similar performance characteristics, but must meet or exceed the performance levels for the systems specified to be considered as equal.

*** If screw holding power is less than 400 lbs. (1780 N) in a Standard Duty door, blocking or thru-bolts are recommended for operable hardware.

LEED® v4 Contributions

	Building Product Disclosure and Optimization Credits				Indoor Environmental Quality Credits	
	Environment al Product Declarations	Raw Materials FSC/POST/PRE Recycled Content	Material Ingredients (3 rd party certification)	Regional Priority (manuf <100 miles away)	Low Emitting Materials (ULEF & NAF)	Emissions And Content (non- emitting)
<u>Non-Rated – Agrifiber</u>	C2C Silver	NO/0%/56%	C2C Silver	NO	YES	YES
<u>Non-Rated – SCL</u>	C2C Silver	NO/0%/0%	C2C Silver	NO	YES	YES
<u>Non-Rated – FSC-PB</u>	C2C Silver	YES/0%/100%	C2C Silver	NO	YES	YES
<u>Non-Rated – PB</u>	C2C Silver	NO/0%/58%	C2C Silver	NO	YES	YES
<u>Non-Rated – SCL-STC30</u>	C2C Silver	NO/0%/0%	C2C Silver	NO	YES	YES
<u>Non-Rated – SCL-STC43-46</u>	C2C Silver	NO/0%/0%	C2C Silver	NO	YES	YES
<u>20min – Agrifiber</u>	C2C Silver	NO/0%/0%	C2C Silver	NO	YES	YES
<u>20min – SCL</u>	C2C Silver	NO/0%/36%	C2C Silver	NO	YES	YES
<u>20min – FSC-PB</u>	C2C Silver	Yes/0%/0%	C2C Silver	NO	YES	YES
<u>20min – PB</u>	C2C Silver	No/0%/36%	C2C Silver	NO	YES	YES
<u>45min – Mineral</u>	C2C Silver	NO/0%/36%	C2C Silver	NO	YES	YES
<u>60min – Mineral</u>	C2C Silver	NO/0%/36%	C2C Silver	NO	YES	YES
<u>90min – Mineral</u>	C2C Silver	NO/0%/36%	C2C Silver	NO	YES	YES
<u>Lead Lined – NR – Agrifiber</u>	N/A	NO/0%/0%	N/A	NO	YES	YES
<u>Lead Lined – NR – SCL</u>	N/A	NO/0%/0%	N/A	NO	YES	YES
<u>Lead Lined – NR – FSC-PB</u>	N/A	YES/0%/56%	N/A	NO	YES	YES
<u>Lead Lined – NR – PB</u>	N/A	NO/0%/0%	N/A	NO	YES	YES
<u>Lead Lined – 20min – FSC-PB</u>	N/A	YES/0%/56%	N/A	NO	YES	YES
<u>Lead Lined – 20min – PB</u>	N/A	NO/0%/56%	N/A	NO	YES	YES

The U.S. Green Building Council's LEED® green building program is the preeminent program for the design, construction, maintenance and operations of high-performance green buildings. Learn more at usgbc.org/LEED.

LEED® 2009 v3.0 Contributions

	Materials & Resources Credits			Indoor Environmental Quality Credits
	MR 4 Recycled Content	MR6 Rapidly Renewable	MR 7 Certified Wood	IEQ 4.4 No added Urea Formaldehyde
<u>Non-Rated – Agrifiber</u>	X	X	X	X
<u>Non-Rated – SCL</u>			X	X
<u>Non-Rated – FSC-PB</u>	X		X	X
<u>Non-Rated – PB</u>	X			X
<u>Non-Rated – SCL-STC30</u>			X	X
<u>Non-Rated – SCL-STC43-46</u>				
<u>20min – Agrifiber</u>	X	X	X	X
<u>20min – SCL</u>			X	X
<u>20min – FSC-PB</u>	X		X	X
<u>20min – PB</u>	X			X
<u>45min – Mineral</u>				X
<u>60min – Mineral</u>				X
<u>90min – Mineral</u>				X
<u>Lead Lined – NR – Agrifiber</u>	X	X	X	X
<u>Lead Lined – NR – SCL</u>	X			X
<u>Lead Lined – NR – FSC-PB</u>	X		X	X
<u>Lead Lined – NR – PB</u>	X			X
<u>Lead Lined – 20min – FSC-PB</u>	X		X	X
<u>Lead Lined – 20min – PB</u>	X			X

The U.S. Green Building Council's LEED® green building program is the preeminent program for the design, construction, maintenance and operations of high-performance green buildings. Learn more at usgbc.org/LEED.

Lite Kit Options

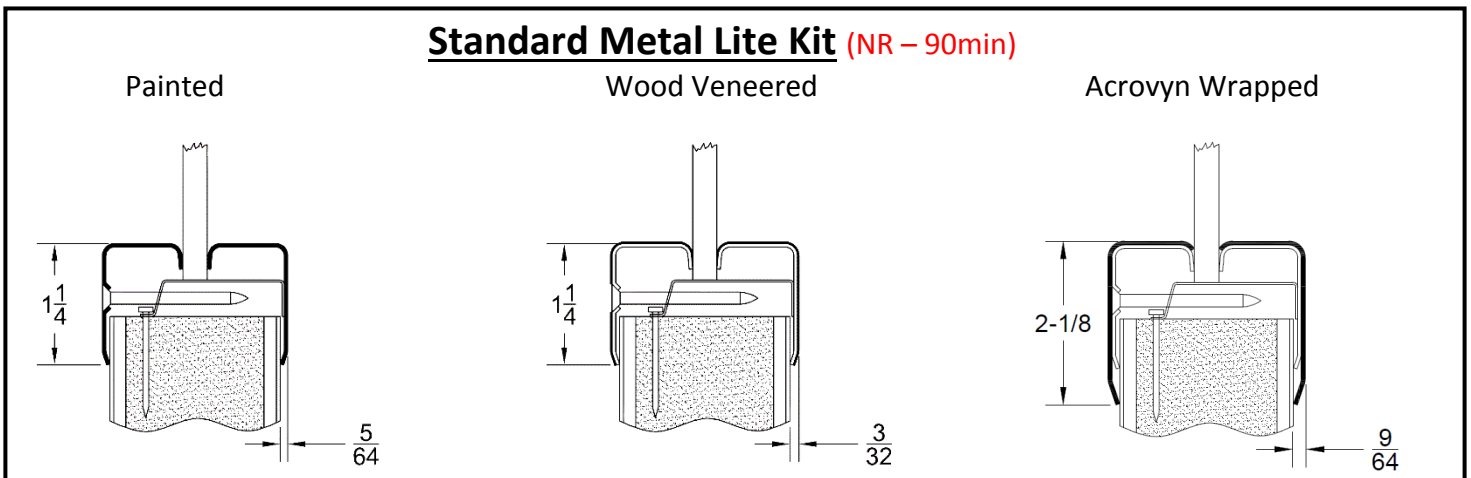
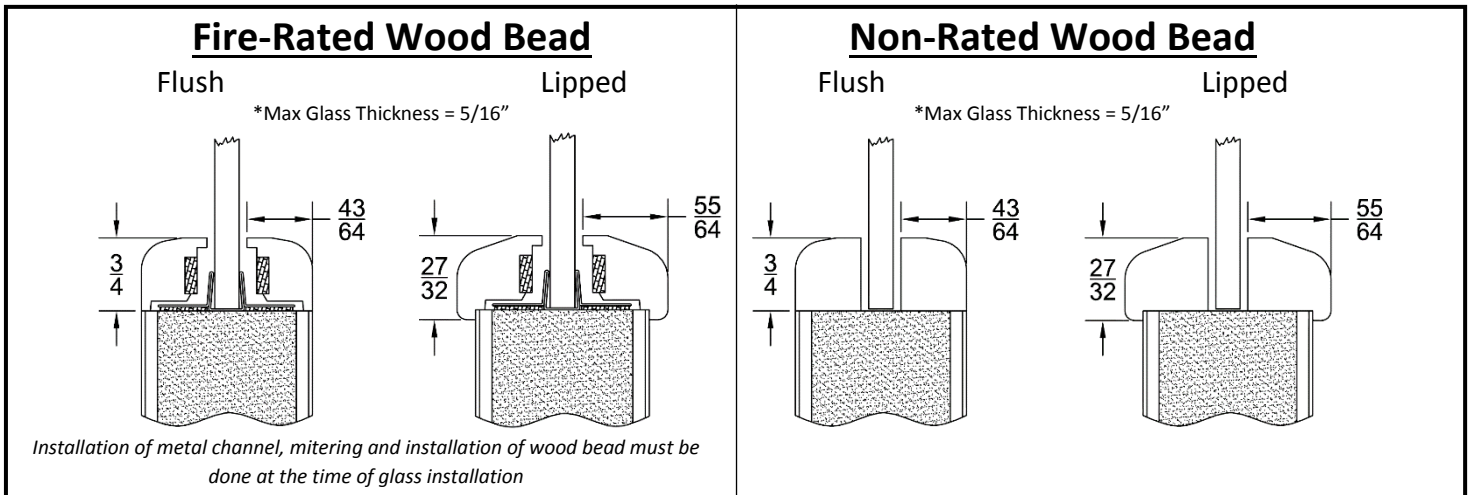

ALL DIMENSIONS NOTED ARE NOMINAL

- 8 -

3 Werner Way, Lebanon, NJ 08833 US, 800-416-6586

895 Lakefront Promenade, Mississauga, ON L5E 2C2 Canada, 905-274-3611

www.c-sgroup.com

© Copyright 2017 Construction Specialties, Inc. reserves the right to make any design changes or withdraw any design without notice.
(3/10/17)

Lite Kit Options (Cont.)

Lead-Lined Metal Lite Kit (NON RATED)

Painted

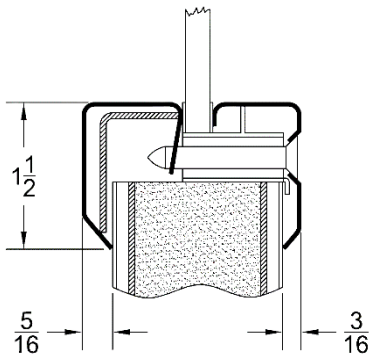

Wood Veneered

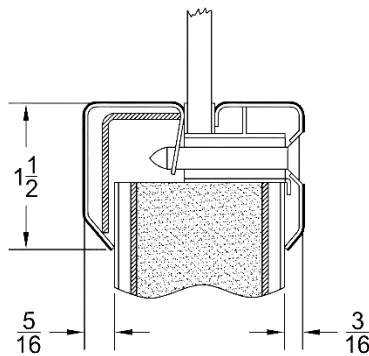

Acrovyn Wrapped

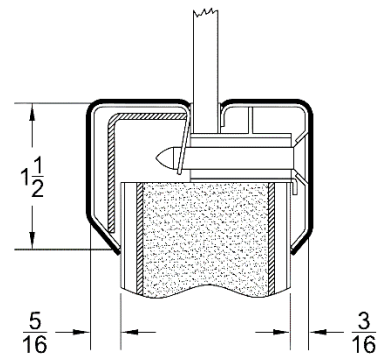

Lead-Lined Metal Lite Kit (FIRE RATED)

Painted

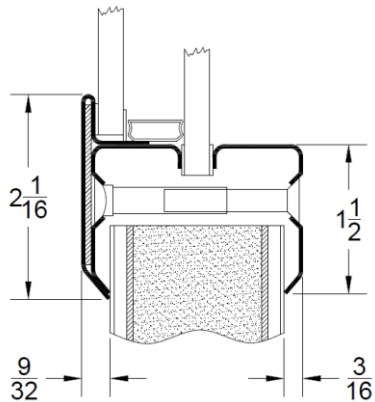

Wood Veneered

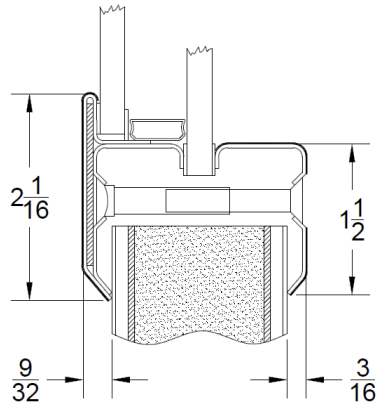

Acrovyn Wrapped

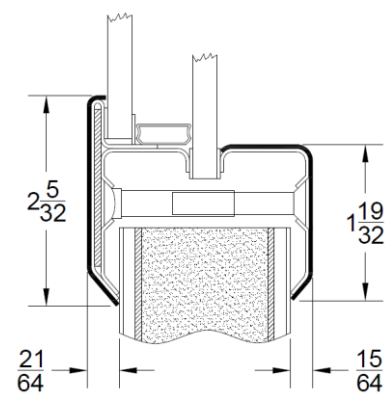

*Inner Pane = Fire Rated Glass

*Outer Pane = Lead Glass

ALL DIMENSIONS NOTED ARE NOMINAL

Door Edge Options

REPLACEABLE ACROVYN EDGE

STANDARD ON NR THRU 90 MINUTE DOORS*
REPLACEABLE IN FIELD

*Available in either Acrovyn (or) Stainless Steel
(Stainless Steel not available on Radius edge)
(Radius edge not available for fire rated doors)

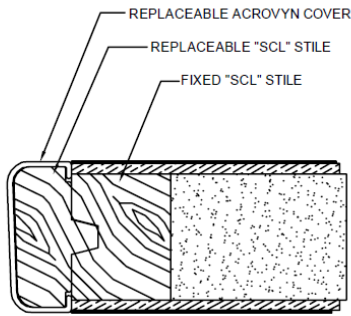

BEVELED EDGE

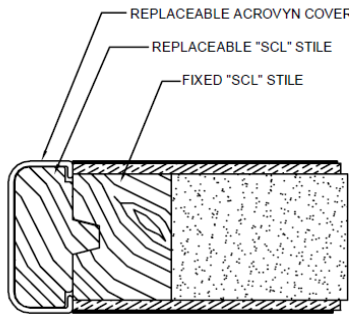

SQUARE EDGE

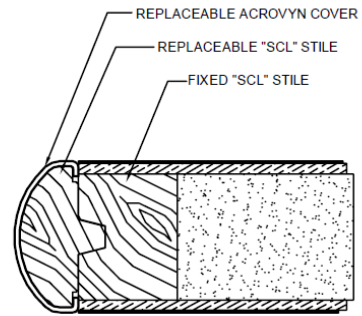

RADIUS EDGE

WRAPPED ACROVYN EDGE

STANDARD ON LL DOORS
REPLACEABLE IN FIELD

*Available in either Acrovyn (or) Stainless Steel

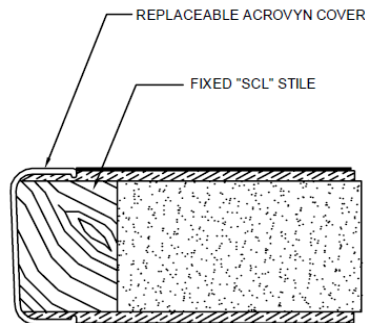

WRAPPED BEVELED EDGE

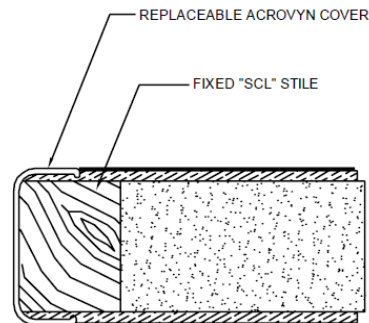

WRAPPED SQUARE EDGE

BANDED EDGE

AVAILABLE FOR SPECIAL REQUESTS ONLY
TYPICALLY USED ON HINGE EDGE WITH
EDGE GUARD TYPE HINGES

*Available only in Acrovyn

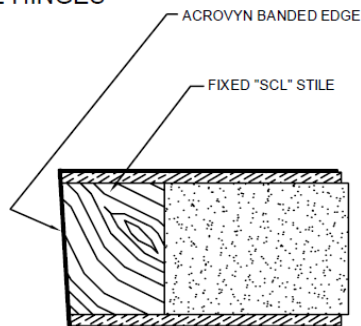

BANDED BEVELED EDGE

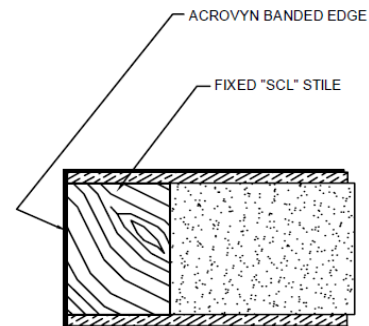

BANDED SQUARE EDGE

Astragal Options

Features:

- Field replaceable Acrovyn cover
- Made with the same durable Acrovyn sheet as the rest of the door
- Perfect color match to the door
- Offers a low profile “airfoil” design to deflect hard impacts
- Can be through bolted or attached using standard fasteners
- Offers a concealed fastener design (Unless through bolted)

Applications:

- Acrovyn Door pairs do not require the usage of Astragals to maintain fire rating
- To be used as a sight seal
- Lead lined option available for use on lead lined doors.

Acrovyn Wrapped

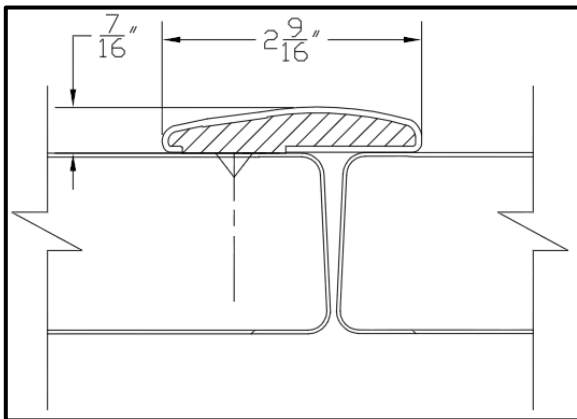

Acrovyn Wrapped (Lead)

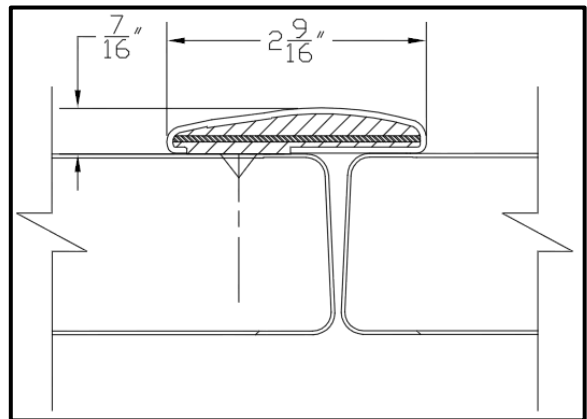

Standard Panel Door Designs

Montclair



Somerset



Madison



Summit



Berkeley



Chatham



Montgomery



Plymouth

Montclair Panel Door Details

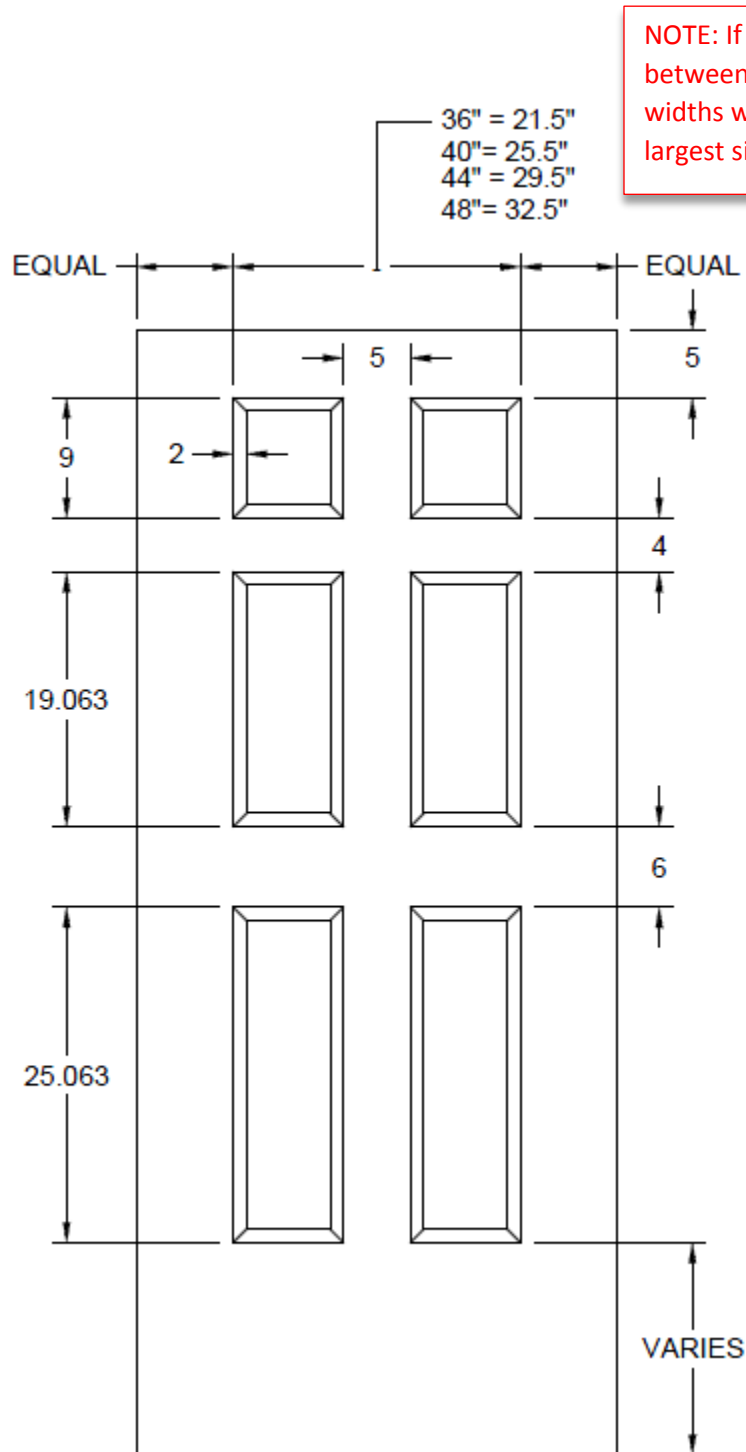

NOTE: If detailing door widths between the sizes noted, panel widths will be used from the next largest size

Somerset Panel Door Details

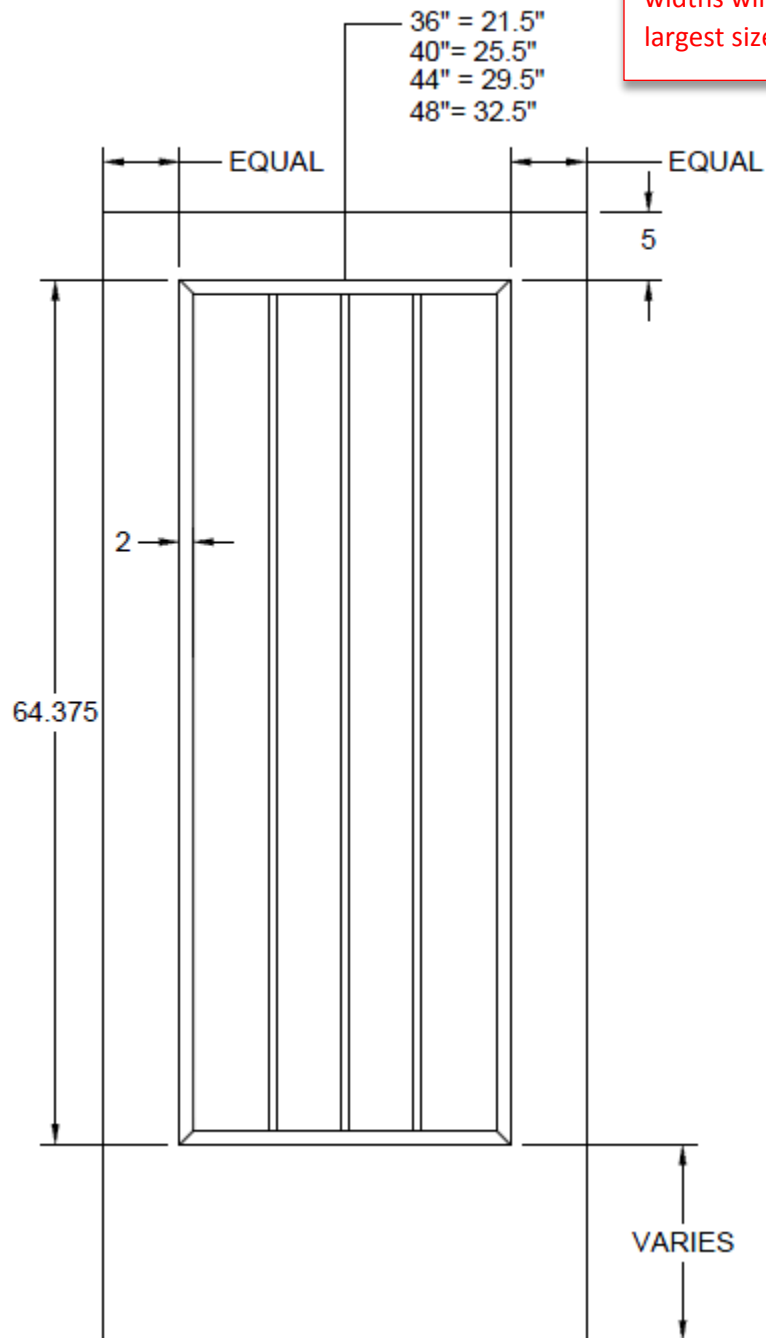

NOTE: If detailing door widths between the sizes noted, panel widths will be used from the next largest size

Madison Panel Door Details

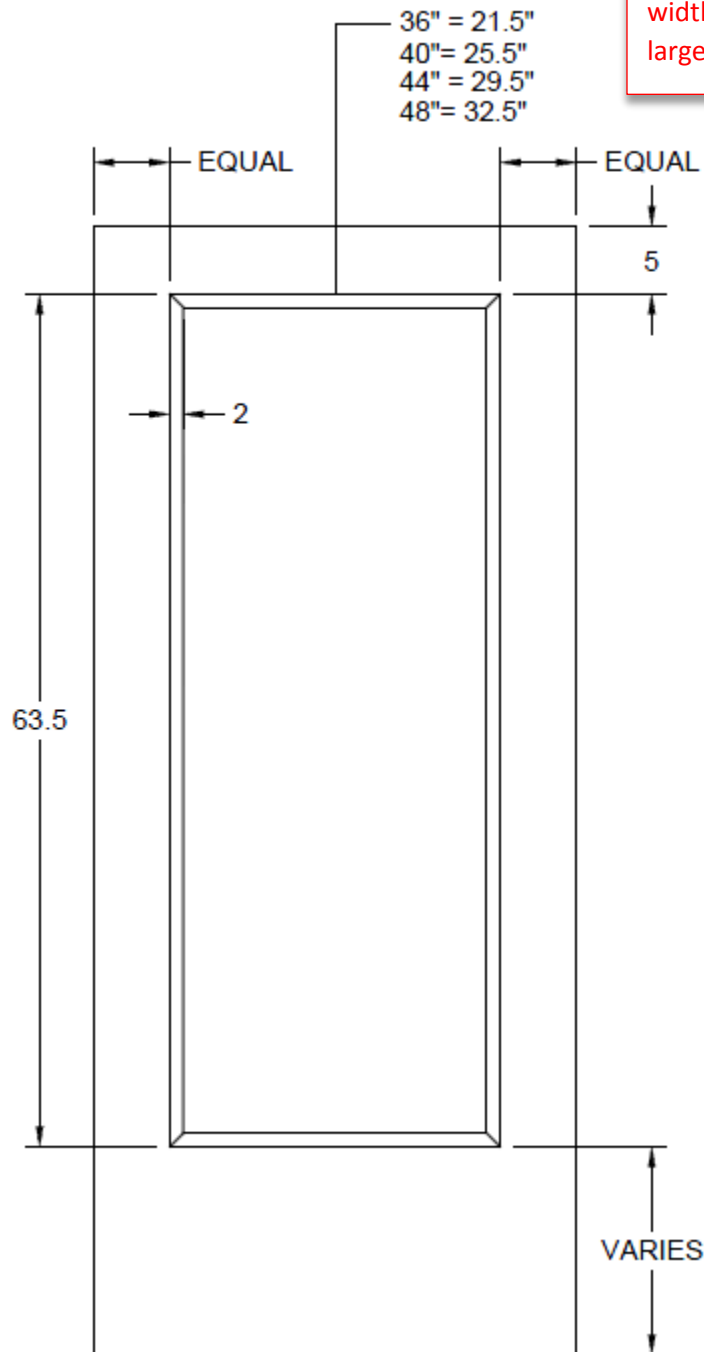

NOTE: If detailing door widths between the sizes noted, panel widths will be used from the next largest size

Summit Panel Door Details

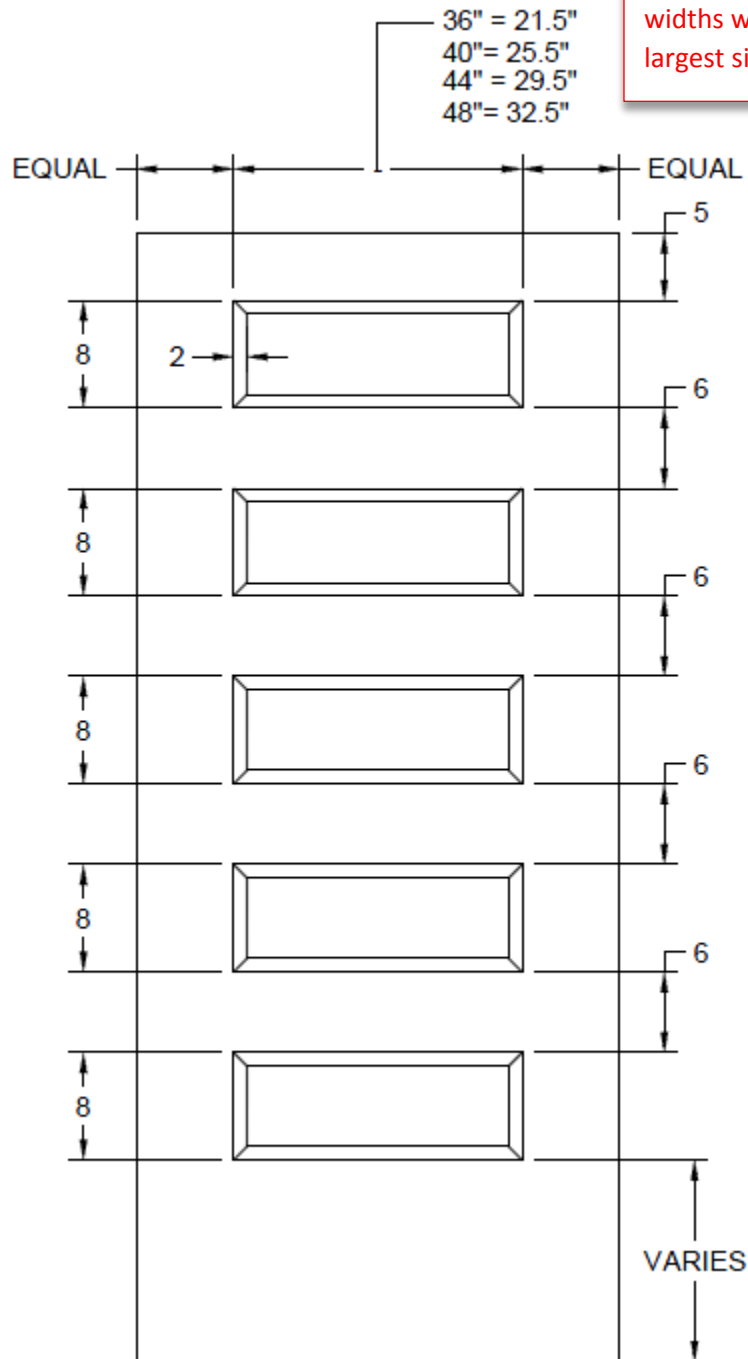

NOTE: If detailing door widths between the sizes noted, panel widths will be used from the next largest size

Berkeley Panel Door Details

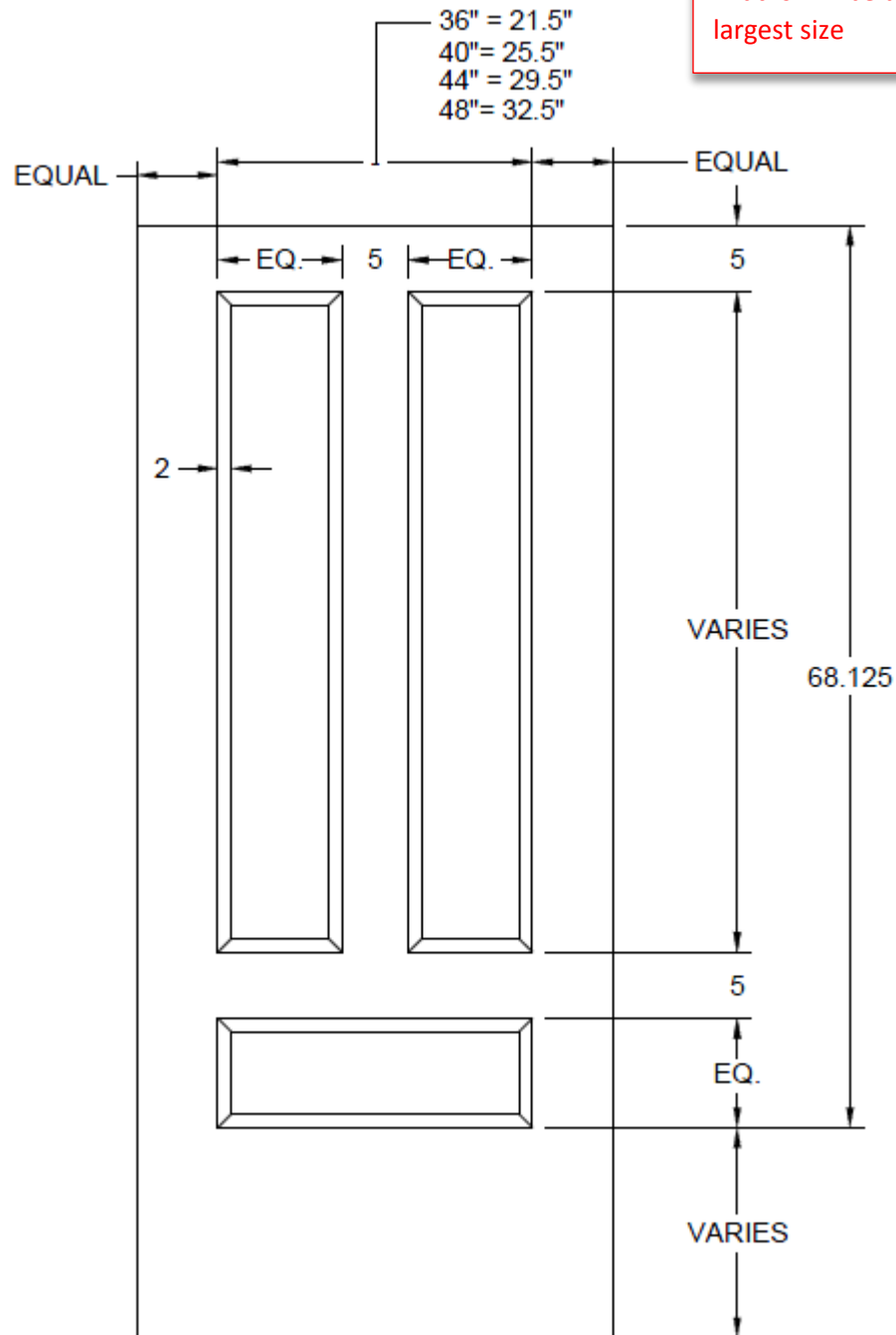

NOTE: If detailing door widths between the sizes noted, panel widths will be used from the next largest size

Chatham Panel Door Details

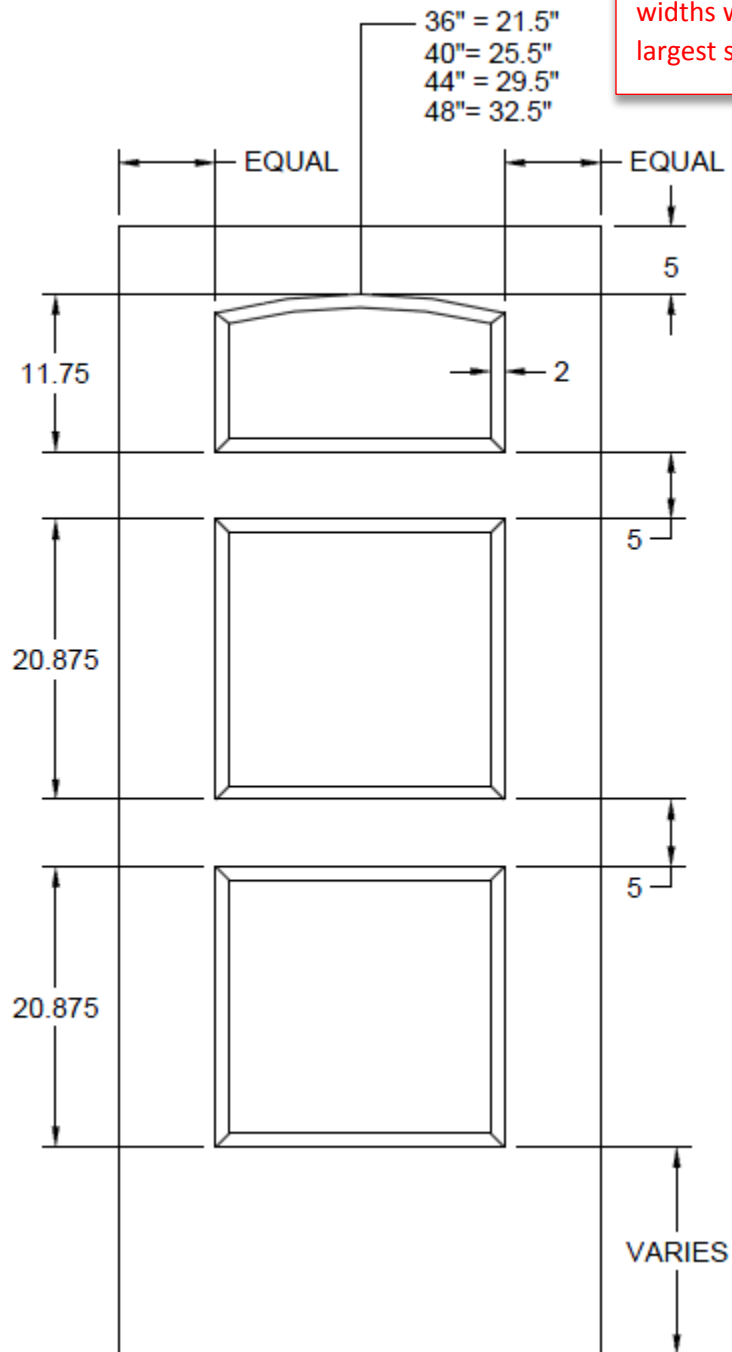

NOTE: If detailing door widths between the sizes noted, panel widths will be used from the next largest size

Montgomery Panel Door Details

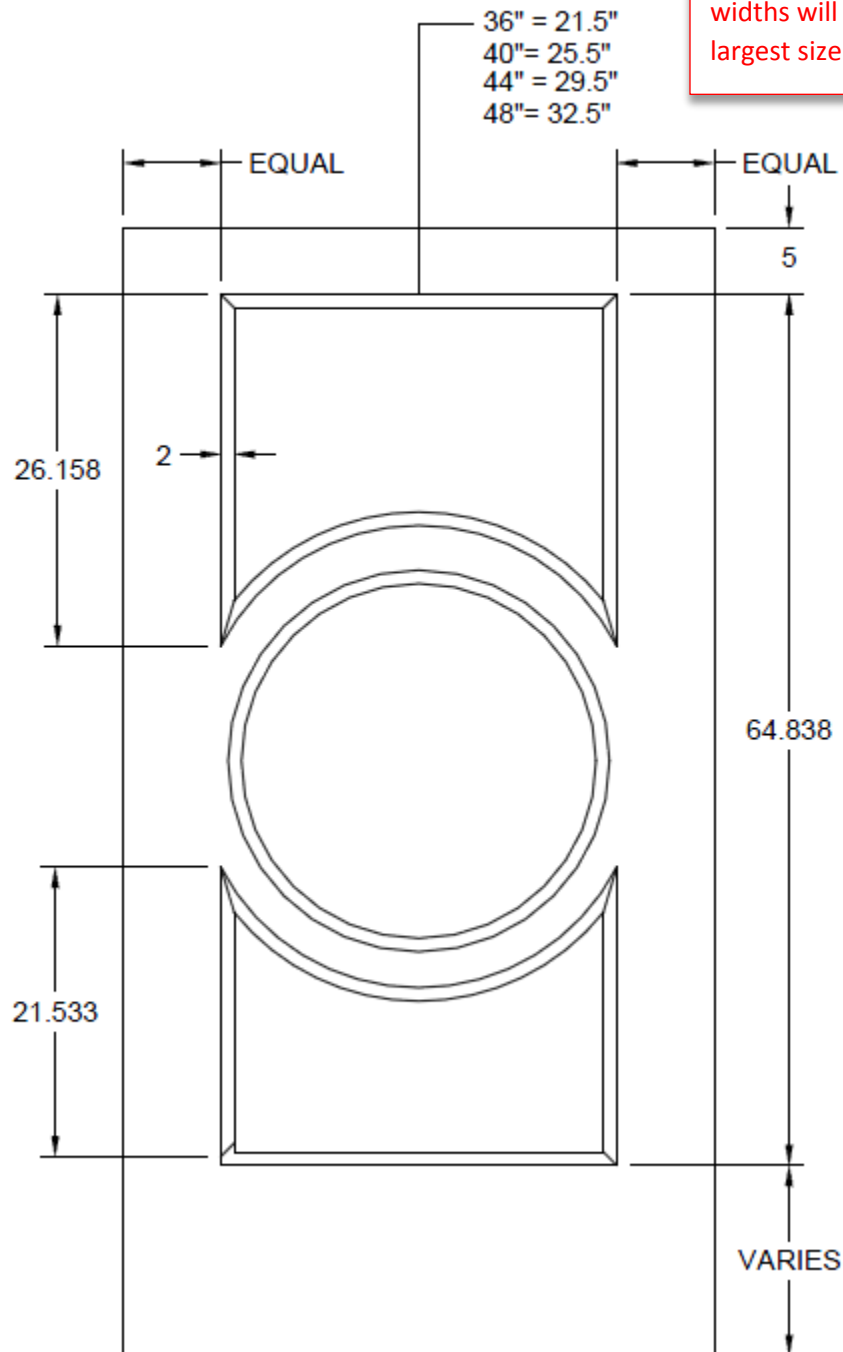

NOTE: If detailing door widths between the sizes noted, panel widths will be used from the next largest size

Plymouth Panel Door Details

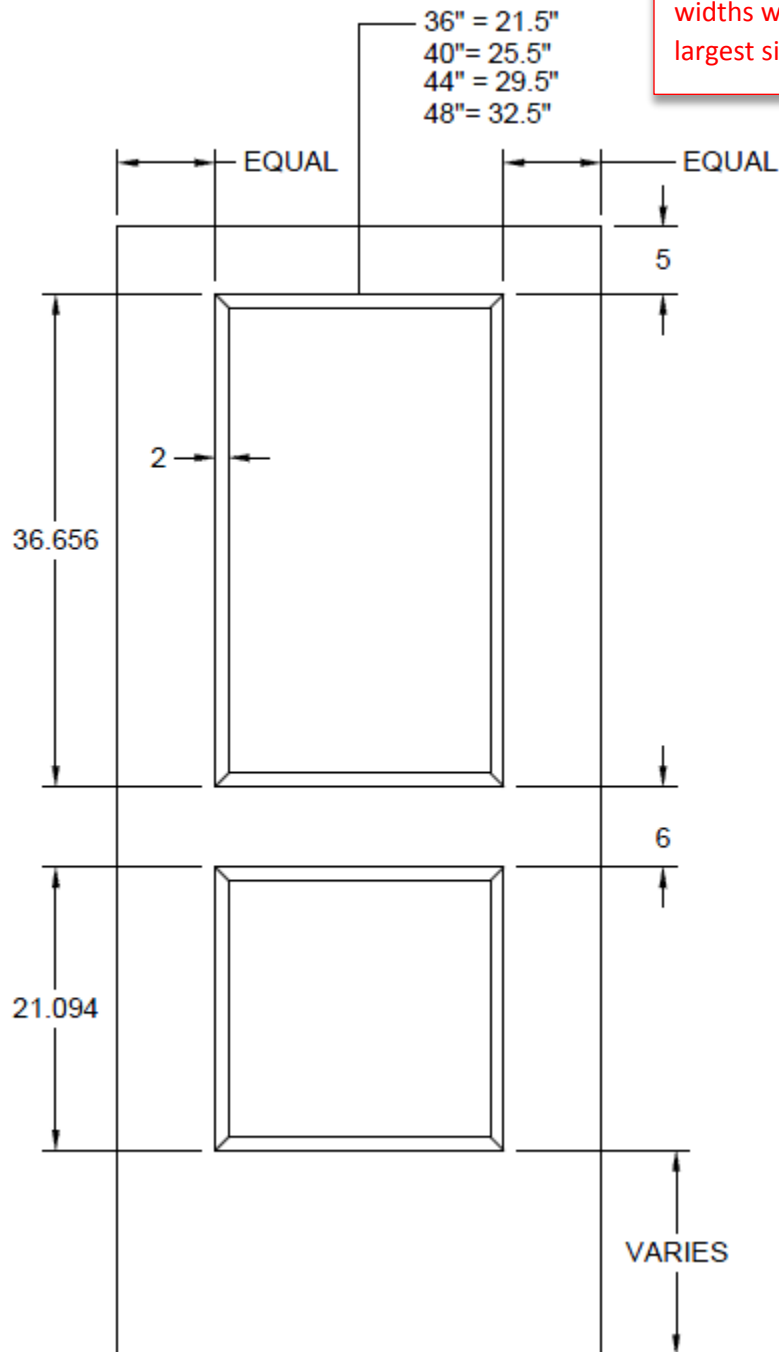

NOTE: If detailing door widths between the sizes noted, panel widths will be used from the next largest size

Non-Rated Lightweight Core (FC5-NR)

Bonded Lightweight Core, 5-Ply Construction

	Single Swing	Pair or Double Egress
Core Type & Standards	Composite: WDMA “Standard Duty”	
	*Meets WDMA “Extra Heavy Duty” for TM-6, TM-7, TM-8	
Complies with CARB Phase I & II Emission Standards		
Maximum Sizes	4’3” x 8’0”	8’6” x 8’0”
Protection Plates	Up to 48” (above bottom of door)	
Door Thickness	1-3/4” (+/- 1/16”)	
WDMA Prefit Tolerance	Width: (+/- 1/32”) Height & Thickness: (+/- 1/16”)	
Weight	2.30lb/ft ² (3070 Door = 48lbs) (4070 Door = 61lbs)	
Crossband	High Density FSC Fiberboard	
Blocking	(Standard) 5” top rail; 1” Bottom Rail; 1” Fixed Internal Stiles; Lock Blocks (Additional blocking upon request)	
Assembly Adhesive	Face: Type I (waterproof); Core: Type II (water-resistant)	
Replaceable Edge Stiles & Covers	Field Replaceable SCL Stiles. Acrovyn and/or 20GA #4 finish Stainless Steel Replaceable Covers	
Replaceable Edge Profile	Beveled, Square, Radius	
Lites	5” from edges, 1-1/2” from hardware or additional cutouts	
Max Lite Cutout Area	Up to 40% of door area. (If exceeded, SCL core required)	
Lite Frames	Metal – Painted, Wood Veneered, Acrovyn Wrapped	
Glazing	No restrictions	
Louvers	Up to 24” x 24”; 10” From Bottom of Door & 1-1/2” From Hardware or Additional Cutout	
Electronic Options	Not Available	
Hinges	Mortised, Surface & Continuous	
Pivots	Center hung & Offset w/intermediate	
Locks	Mortise & Cylindrical	
Exit Devices	Not Available	
Concealed Vertical Rod	Not Available	
Flushbolts	Must Be Extension Type (Metal Door)	
Closing Devices	Mortised or Surface Mounted	
Door Bottoms	Mortised or Surface Mounted	
Transoms	Available	

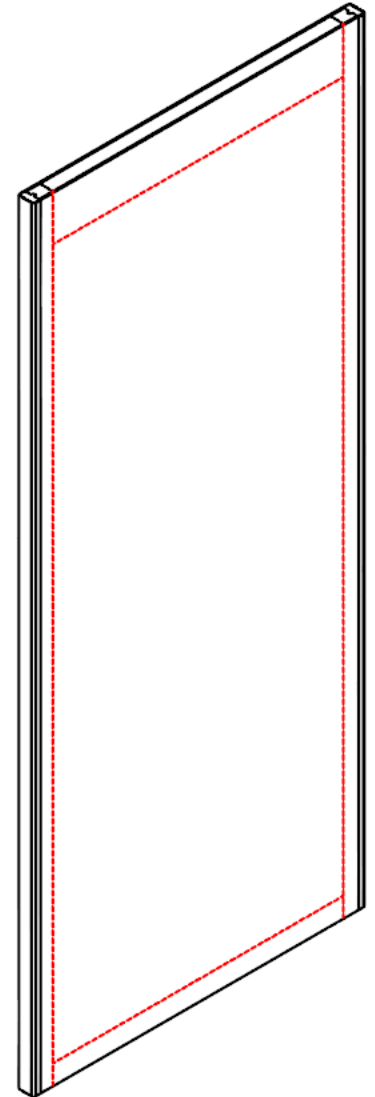

(Surface mounted hardware shall be through-bolted)



Non-Rated Agrifiber (AF5-NR)

Bonded Agrifiber Core, 5-Ply Construction

Single Swing		Pair or Double Egress
Core Type & Standards	Agrifiber: ANSI A208.1.2009 grade LD-1 (26-28 lb/ft³)	
Complies with CARB Phase I & II Emission Standards		
Maximum Sizes	4'3" x 9'0"	8'6" x 9'0"
Protection Plates	Up to 48" (above bottom of door)	
Door Thickness	1-3/4" OR 1-3/8" (+/- 1/16")	
WDMA Prefit Tolerance	Width: (+/- 1/32") Height & Thickness: (+/- 1/16")	
Weight	5.08lb/ft² (3070 Door = 107lbs) (4070 Door = 142lbs)	
Crossband	High Density FSC Fiberboard	
Blocking	(Standard) 5" top rail; 1" Bottom Rail; 1" Fixed Internal Stiles (Additional blocking upon request)	
Assembly Adhesive	Face: Type I (waterproof); Core: Type II (water-resistant)	
Replaceable Edge Stiles & Covers	Field Replaceable SCL Stiles. Acrovyn and/or 20GA #4 finish Stainless Steel Replaceable Covers	
Replaceable Edge Profile	Beveled, Square, Radius	
Lites	5" from edges, 1-1/2" from hardware or additional cutouts	
Max Lite Cutout Area	Up to 40% of door area. (If exceeded, SCL core required)	
Lite Frames	Wood beads; Metal – Painted, Wood Veneered, Acrovyn Wrapped	
Glazing	No restrictions	
Louvers	Up to 24" x 24"; 10" From Bottom of Door & 1-1/2" From Hardware or Additional Cutout	
Electronic Options	Electronic hardware & raceways Available	
Hinges	Mortised, Surface & Continuous	
Pivots	Center hung & Offset w/intermediate	
Locks	Mortise & Cylindrical	
Exit Devices	Surface Vertical Rod (Includes LBR), RIM & Mortised	
Concealed Vertical Rod	Not Available	
Flushbolts	Must Be Extension Type (Metal Door)	
Closing Devices	Mortised or Surface Mounted	
Door Bottoms	Mortised or Surface Mounted	
Transoms	Available	

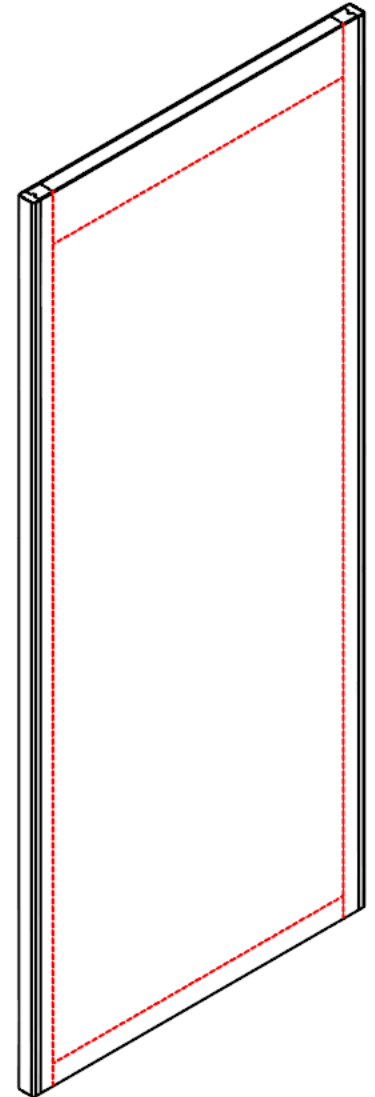

Non-Rated FSC Particleboard (FSC-PC5-NR)

Bonded FSC Particleboard Core, 5-Ply Construction

Single Swing		Pair or Double Egress
Core Type & Standards	FSC Certified Particleboard: ANSI A208.1.2009 grade LD-1 (32 lb/ft³)	
Complies with CARB Phase I & II Emission Standards		
Maximum Sizes	4'3" x 9'0"	8'6" x 9'0"
Protection Plates	Up to 48" (above bottom of door)	
Door Thickness	1-3/4" OR 1-3/8" (+/- 1/16")	
WDMA Prefit Tolerance	Width: (+/- 1/32") Height & Thickness: (+/- 1/16")	
Weight	5.22lb/ft² (3070 Door = 110lbs) (4070 Door = 147lbs)	
Crossband	High Density FSC Fiberboard	
Blocking	(Standard) 5" top rail; 1" Bottom Rail; 1" Fixed Internal Stiles (Additional blocking upon request)	
Assembly Adhesive	Face: Type I (waterproof); Core: Type II (water-resistant)	
Replaceable Edge Stiles & Covers	Field Replaceable SCL Stiles. Acrovyn and/or 20GA #4 finish Stainless Steel Replaceable Covers	
Replaceable Edge Profile	Beveled, Square, Radius	
Lites	5" from edges, 1-1/2" from hardware or additional cutouts	
Max Lite Cutout Area	Up to 40% of door area. (If exceeded, SCL core required)	
Lite Frames	Wood beads; Metal – Painted, Wood Veneered, Acrovyn Wrapped	
Glazing	No restrictions	
Louvers	Up to 24" x 24"; 10" From Bottom of Door & 1-1/2" From Hardware or Additional Cutout	
Electronic Options	Electronic hardware & raceways Available	
Hinges	Mortised, Surface & Continuous	
Pivots	Center hung & Offset w/intermediate	
Locks	Mortise & Cylindrical	
Exit Devices	Surface Vertical Rod (Includes LBR), RIM & Mortised	
Concealed Vertical Rod	Not Available	
Flushbolts	Must Be Extension Type (Metal Door)	
Closing Devices	Mortised or Surface Mounted	
Door Bottoms	Mortised or Surface Mounted	
Transoms	Available	

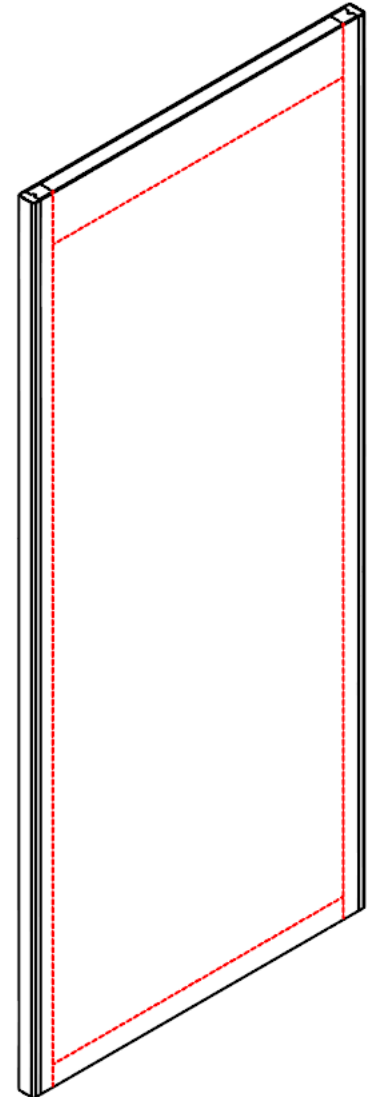

Non-Rated Particleboard (PC5-NR)

Bonded Particleboard Core, 5-Ply Construction

	Single Swing	Pair or Double Egress
Core Type & Standards	Particleboard: ANSI A208.1.2009 grade LD-1(32 lb/ft ³)	
Maximum Sizes	4'3" x 9'0"	8'6" x 9'0"
Protection Plates	Up to 48" (above bottom of door)	
Door Thickness	1-3/4" OR 1-3/8" (+/- 1/16")	
WDMA Prefit Tolerance	Width: (+/- 1/32") Height & Thickness: (+/- 1/16")	
Weight	5.27lb/ft ² (3070 Door = 111lbs) (4070 Door = 148lbs)	
Crossband	High Density FSC Fiberboard	
Blocking	(Standard) 5" top rail; 1" Bottom Rail; 1" Fixed Internal Stiles (Additional blocking upon request)	
Assembly Adhesive	Face: Type I (waterproof); Core: Type II (water-resistant)	
Replaceable Edge Stiles & Covers	Field Replaceable SCL Stiles. Acrovyn and/or 20GA #4 finish Stainless Steel Replaceable Covers	
Replaceable Edge Profile	Beveled, Square, Radius	
Lites	5" from edges, 1-1/2" from hardware or additional cutouts	
Max Lite Cutout Area	Up to 40% of door area. (If exceeded, SCL core required)	
Lite Frames	Wood beads; Metal – Painted, Wood Veneered, Acrovyn Wrapped	
Glazing	No restrictions	
Louvers	Up to 24" x 24"; 10" From Bottom of Door & 1-1/2" From Hardware or Additional Cutout	
Electronic Options	Electronic hardware & raceways Available	
Hinges	Mortised, Surface & Continuous	
Pivots	Center hung & Offset w/intermediate	
Locks	Mortise & Cylindrical	
Exit Devices	Surface Vertical Rod (Includes LBR), RIM & Mortised	
Concealed Vertical Rod	Not Available	
Flushbolts	Must Be Extension Type (Metal Door)	
Closing Devices	Mortised or Surface Mounted	
Door Bottoms	Mortised or Surface Mounted	
Transoms	Available	

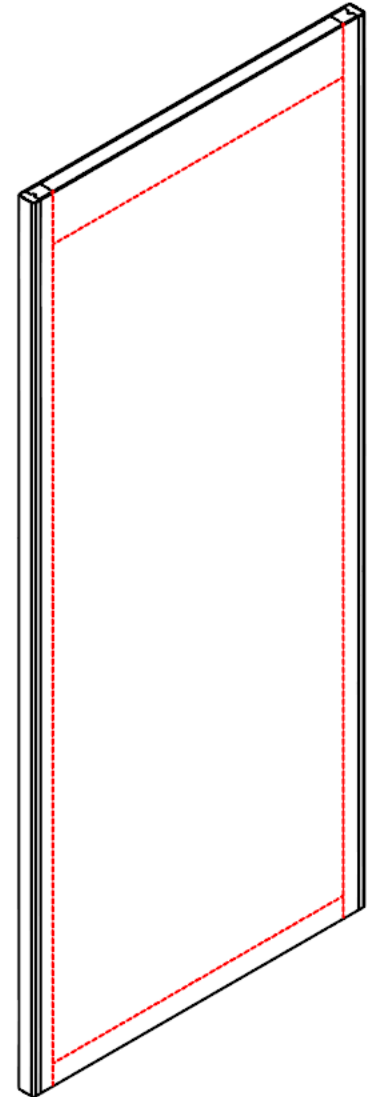

Non-Rated SCL (SCL5-NR)

Bonded SCL Core, 5-Ply Construction

	Single Swing	Pair or Double Egress
Core Type & Standards	Structural Composite Lumber: (38 lb/ft ³)	
Maximum Sizes	4'3" x 10'0"	8'6" x 10'0"
Protection Plates	Up to 48" (above bottom of door)	
Door Thickness	1-3/4" OR 1-3/8" (+/- 1/16")	
WDMA Prefit Tolerance	Width: (+/- 1/32") Height & Thickness: (+/- 1/16")	
Weight	6.87lb/ft ² (3070 Door = 144lbs) (4070 Door = 193lbs)	
Crossband	High Density FSC Fiberboard	
Blocking	(Standard) Full Core Blocking; 1" Fixed Internal Stiles	
Assembly Adhesive	Face: Type I (waterproof); Core: Type II (water-resistant)	
Replaceable Edge Stiles & Covers	Field Replaceable SCL Stiles. Acrovyn and/or 20GA #4 finish Stainless Steel Replaceable Covers	
Replaceable Edge Profile	Beveled, Square, Radius	
Lites	5" from edges, 1-1/2" from hardware or additional cutouts	
Max Lite Cutout Area	No restrictions	
Lite Frames	Wood beads; Metal – Painted, Wood Veneered, Acrovyn Wrapped	
Glazing	No restrictions	
Louvers	Up to 24" x 24"; 10" From Bottom of Door & 1-1/2" From Hardware or Additional Cutout	
Electronic Options	Electronic hardware & raceways Available	
Hinges	Mortised, Surface & Continuous	
Pivots	Center hung & Offset w/intermediate	
Locks	Mortise & Cylindrical	
Exit Devices	Surface Vertical Rod (Includes LBR), RIM & Mortised	
Concealed Vertical Rod	Available (Includes LBR)	
Flushbolts	Must Be Extension Type (Metal Door)	
Closing Devices	Mortised or Surface Mounted	
Door Bottoms	Mortised or Surface Mounted	
Transoms	Available	

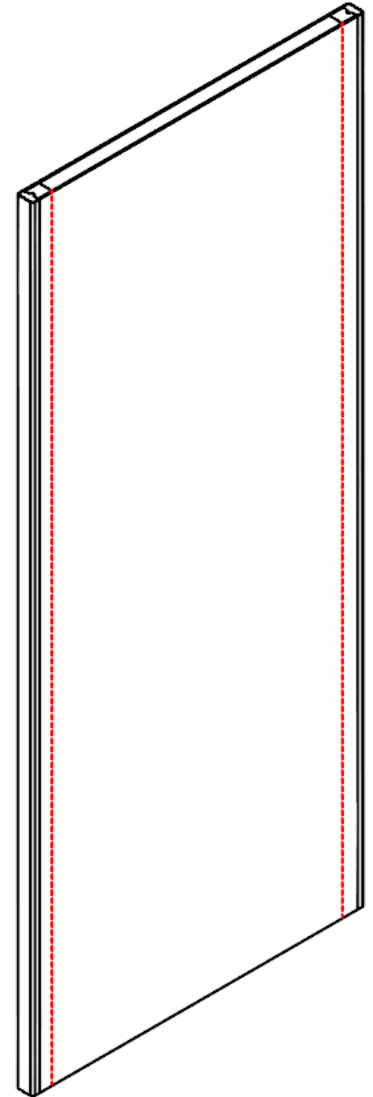

Non-Rated Panel Door (PN SCL5-NR)

Bonded SCL Core, 5-Ply Construction

	Single Swing	Pair or Double Egress
Core Type & Standards	Structural Composite Lumber: (38 lb/ft ³)	
Maximum Sizes	4'3" x 10'0"	8'6" x 10'0"
Protection Plates	Up to 48" (above bottom of door)	
Door Thickness	1-3/4" (+/- 1/16")	
WDMA Prefit Tolerance	Width: (+/- 1/32") Height & Thickness: (+/- 1/16")	
Weight	6.87lb/ft ² (3070 Door = 144lbs) (4070 Door = 193lbs)	
Crossband	High Density FSC Fiberboard	
Blocking	(Standard) Full Core Blocking; 1" Fixed Internal Stiles	
Assembly Adhesive	Face: Type I (waterproof); Core: Type II (water-resistant)	
Replaceable Edge Stiles & Covers	Field Replaceable SCL Stiles. Acrovyn and/or 20GA #4 finish Stainless Steel Replaceable Covers	
Replaceable Edge Profile	Beveled, Square, Radius	
Lites	5" from edges, 1-1/2" from hardware or additional cutouts	
Max Lite Cutout Area	Lite cutout must replace one entire panel	
Lite Frames	Wood beads; Metal – Painted, Wood Veneered, Acrovyn Wrapped	
Glazing	No restrictions	
Louvers	Up to 24" x 24"; 10" From Bottom of Door & 1-1/2" From Hardware or Additional Cutout	
Electronic Options	Electronic Hardware & Raceways Available, Except Behind Recessed Portions of the Panels	
Hinges	Mortised, Surface & Continuous	
Pivots	Center hung & Offset w/intermediate	
Locks	Mortise & Cylindrical	
Exit Devices	Surface Vertical Rod (Includes LBR), RIM & Mortised	
Concealed Vertical Rod	Not Available	
Flushbolts	Must Be Extension Type (Metal Door)	
Closing Devices	Mortised or Surface Mounted	
Door Bottoms	Mortised or Surface Mounted	
Transoms	Available	
Panel Design Options	8 standard options (See Pages 10 - 18)	

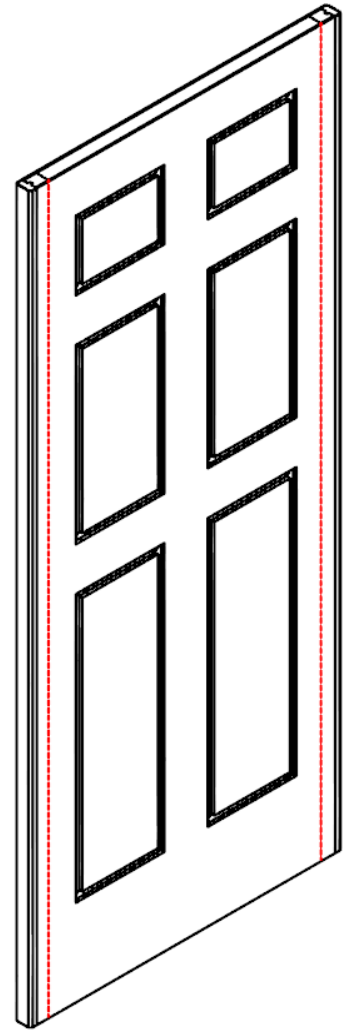

Non-Rated Barrier Resistant (BR SCL5-NR)

Bonded SCL Core, 5-Ply Construction

Single Swing ONLY	
Core Type & Standards	Structural Composite Lumber: (38 Lb/Ft ³)
Maximum Sizes	4'3" X 10'0" Minimum Width: 2'8"
Wicket Door Size	Standard: 16" X 60", Max Width: 14" LESS main door
Wicket Door Location	Centered in width; 10" From Bottom of Door
Protection Plates	Up To 48" (Above Bottom Of Door)
Door Thickness	1-3/4" (+/- 1/16")
WDMA Prefit Tolerance	Width: (+/- 1/32") Height & Thickness: (+/- 1/16")
Weight	6.87lb/Ft ² (3070 Door = 144lbs) (4070 Door = 193lbs)
Crossband	High Density FSC Fiberboard
Blocking	(Standard) Full Core Blocking; 1" Fixed Internal Stiles
Assembly Adhesive	Face: Type I (Waterproof); Core: Type II (Water-Resistant)
Face Matching	Continuous Grain Match Not Available
Replaceable Edge Stiles & Covers	Field Replaceable SCL Stiles. Acrovyn and/or 20GA #4 finish Stainless Steel Replaceable Covers
Replaceable Edge Profile	Beveled, Square, Radius
Wicket Door Edge	Beveled Rabbeted Design
Lites	5" from edges, 1-1/2" from hardware or additional cutouts
Max Lite Cutout Area	Lite cutout Max width = 6" ; Max Height = 35"
Lite Frames	Wood Beads; Metal – Painted, Wood Veneered, Acrovyn Wrapped
Glazing	No restrictions
Louvers	Not Available
Electronic Options	Electronic Hardware & Raceways Available
Hinges (Main Door)	Mortised, Surface & Continuous
Hinges (Wicket Door)	(2) Tectus TE-340-3d, Included By CS
Pivots (Main Door)	Offset w/Intermediate
Locks (Main Door)	Mortise & Cylindrical
Locks (Wicket Door)	Recommended: Circular drive-in latch, single sided deadbolt
Exit Devices	Not Available
Concealed Vertical Rod	Not Available
Flushbolts	Not Available
Closing Devices	Mortised or Surface Mounted
Door Bottoms	Mortised or Surface Mounted
Transoms	Not Available

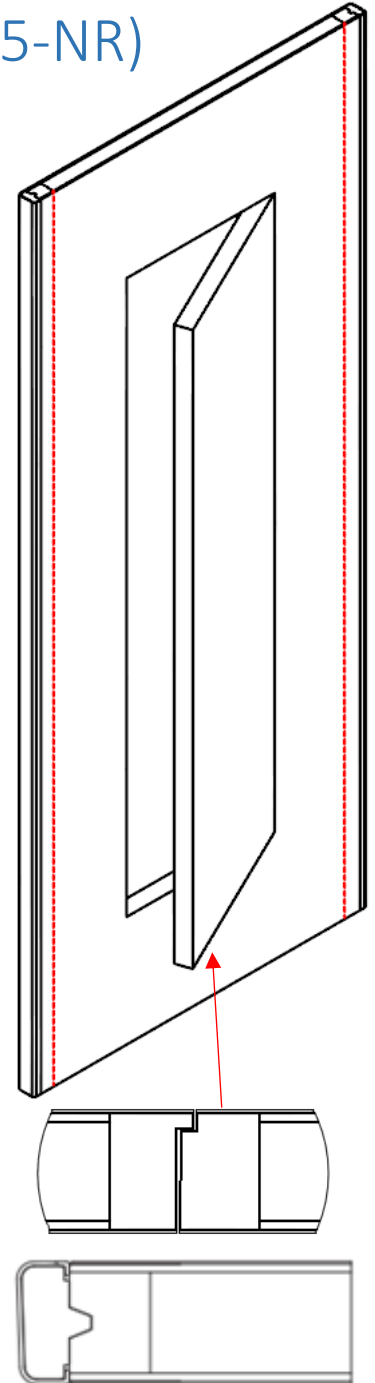

(Not Tested For Detention Application)



Non-Rated Dutch Door (DD SCL5-NR)

Bonded SCL Core, 5-Ply Construction

	Single Swing	Pair or Double Egress
Core Type & Standards	Structural Composite Lumber: (38 lb/ft ³)	
Maximum Sizes	4'3" x 10'0"	8'6" x 10'0"
Protection Plates	Up to 48" (above bottom of door)	
Door Thickness	1-3/4" (+/- 1/16")	
WDMA Prefit Tolerance	Width: (+/- 1/32") Height & Thickness: (+/- 1/16")	
Weight	6.87lb/ft ² (3070 Door = 144lbs) (4070 Door = 193lbs)	
Crossband	High Density FSC Fiberboard	
Blocking	(Standard) Full Core Blocking; 1" Fixed Internal Stiles	
Assembly Adhesive	Face: Type I (waterproof); Core: Type II (water-resistant)	
Replaceable Edge Stiles & Covers	Field Replaceable SCL Stiles. Acrovyn and/or 20GA #4 finish Stainless Steel Replaceable Covers	
Replaceable Edge Profile	Beveled, Square, Radius	
Lites	5" from edges, 1-1/2" from hardware or additional cutouts	
Max Lite Cutout Area	No restrictions	
Lite Frames	Wood beads; Metal – Painted, Wood Veneered, Acrovyn Wrapped	
Glazing	No restrictions	
Louvers	Up to 24" x 24"; 10" From Bottom of Door & 1-1/2" From Hardware or Additional Cutout	
Electronic Options	Electronic hardware & raceways Available	
Hinges	Mortised, Surface & Continuous	
Pivots	Center hung & Offset w/intermediate	
Locks	Mortise & Cylindrical	
Exit Devices	Surface Vertical Rod (Includes LBR), RIM & Mortised	
Concealed Vertical Rod	Available (Includes LBR)	
Flushbolts	Must Be Extension Type (Metal Door)	
Closing Devices	Mortised or Surface Mounted	
Door Bottoms	Mortised or Surface Mounted	
Transoms	Available	
Shelf Options	Optional – Single or Double sided, with or without gussets Max shelf overhang – 6 inches.	

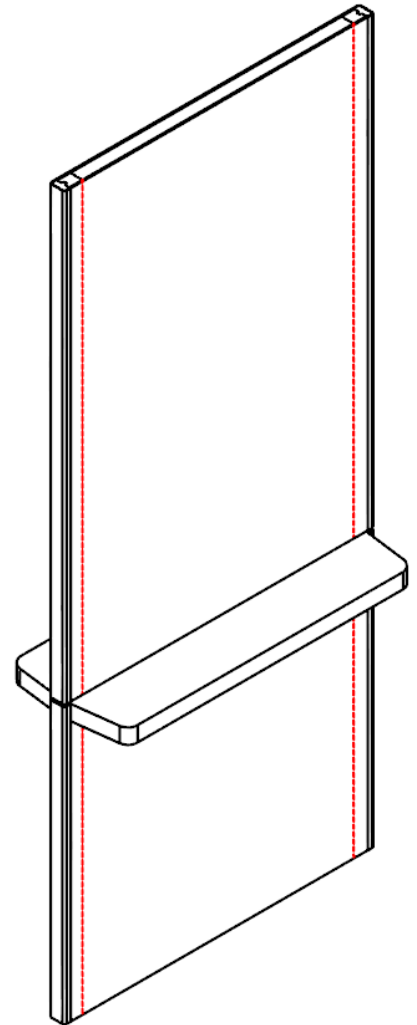

3 Werner Way, Lebanon, NJ 08833 US, 800-416-6586
895 Lakefront Promenade, Mississauga, ON L5E 2C2 Canada, 905-274-3611
www.c-sgroup.com

© Copyright 2017 Construction Specialties, Inc. reserves the right to make any design changes or withdraw any design without notice.
(3/10/17)

Non-Rated STC30 (SCL5-NR STC 30)

Bonded SCL Core, 5-Ply Construction

	Single Swing	Pair or Double Egress
Core Type & Standards	Structural Composite Lumber: (38 lb/ft ³)	
Maximum Sizes	4'0" x 8'0"	N/A
Protection Plates	Up to 48" (above bottom of door)	
Door Thickness	1-3/4" (+/- 1/16")	
WDMA Prefit Tolerance	Width: (+/- 1/32") Height & Thickness: (+/- 1/16")	
Weight	6.87lb/ft ² (3070 Door = 144lbs) (4070 Door = 193lbs)	
Crossband	High Density FSC Fiberboard	
Blocking	(Standard) Full Core Blocking; 1" Fixed Internal Stiles	
Assembly Adhesive	Face: Type I (waterproof); Core: Type II (water-resistant)	
Replaceable Edge Stiles & Covers	Non-Replaceable SCL Stiles. Acrovyn and/or 20GA #4 finish Stainless Steel Replaceable Covers	
Replaceable Edge Profile	Beveled, Square	
Lites	Not Available	
Lite Frames	Not Available	
Louvers	Not Available	
Electronic Options	Electronic hardware & raceways Available	
Hinges	Mortised, Surface & Continuous	
Pivots	Center hung & Offset w/intermediate	
Locks	Mortise & Cylindrical	
Exit Devices	Surface Vertical Rod (Includes LBR), RIM & Mortised	
Concealed Vertical Rod	Not Available	
Flushbolts	Must Be Extension Type (Metal Door)	
Closing Devices	Mortised or Surface Mounted	
Door Bottoms	Mortised or Surface Mounted	
Transoms	Available	
STC-30 Operable (Required Gasketing)	Top & Edge of Door: NGP 107NA; Bottom: NGP 420N	

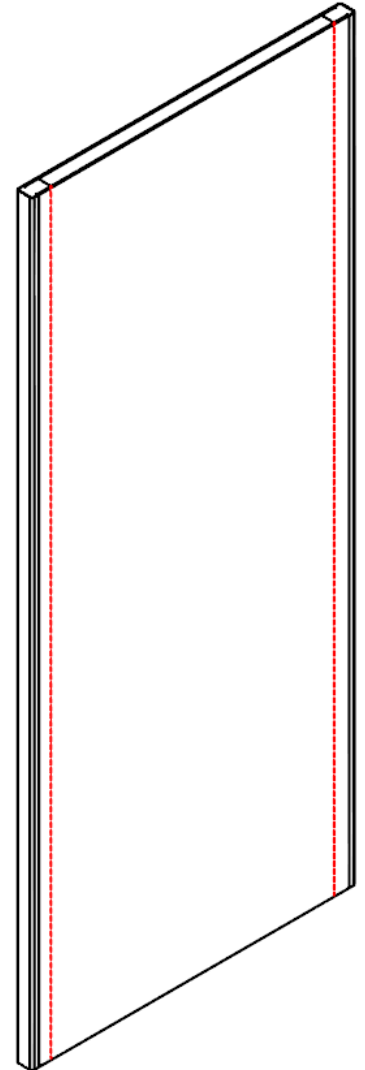

Non-Rated STC43-46 (SCL5-NR STC 43-46)

Bonded SCL Core, 5-Ply Construction

	Single Swing	Pair or Double Egress
Core Type & Standards	Structural Composite Lumber: (38 lb/ft ³)	
Maximum Sizes	4'0" x 8'0"	N/A
Protection Plates	Up to 48" (above bottom of door)	
Door Thickness	1-3/4" (+/- 1/16")	
WDMA Prefit Tolerance	Width: (+/- 1/32") Height & Thickness: (+/- 1/16")	
Weight	6.87lb/ft ² (3070 Door = 144lbs) (4070 Door = 193lbs)	
Crossband	High Density FSC Fiberboard	
Blocking	(Standard) Full Core Blocking; 1" Fixed Internal Stiles	
Assembly Adhesive	Face: Type I (waterproof); Core: Type II (water-resistant)	
Replaceable Edge Stiles & Covers	Non-Replaceable SCL Stiles. Acrovyn and/or 20GA #4 finish Stainless Steel Replaceable Covers	
Replaceable Edge Profile	Beveled, Square	
Lites	Not Available	
Lite Frames	Not Available	
Louvers	Not Available	
Electronic Options	Electronic hardware & raceways Available	
Hinges	Mortised, Surface & Continuous	
Pivots	Center hung & Offset w/intermediate	
Locks	Mortise & Cylindrical	
Exit Devices	Surface Vertical Rod (Includes LBR), RIM & Mortised	
Concealed Vertical Rod	Not Available	
Flushbolts	Must Be Extension Type (Metal Door)	
Closing Devices	Mortised or Surface Mounted	
Door Bottoms	Mortised or Surface Mounted	
Transoms	Available	
STC-43 Operable (Required Gasketing)	Top & Edge of Door: Pemko Model S88, S773 & S771; Bottom: Zero 367	
STC-44 Operable (Required Gasketing)	Top & Edge of Door: Pemko Model 188 & 119; Bottom: Zero 367	
STC-45 Operable (Required Gasketing)	Top & Edge of Door: Pemko Model 475 & 119; Bottom: Zero 367	
STC-46 Operable (Required Gasketing)	Top & Edge of Door: Pemko Model 475 & 119; Bottom: Zero 367, Zero 328 door sweep, & Zero 63A door Threshold	

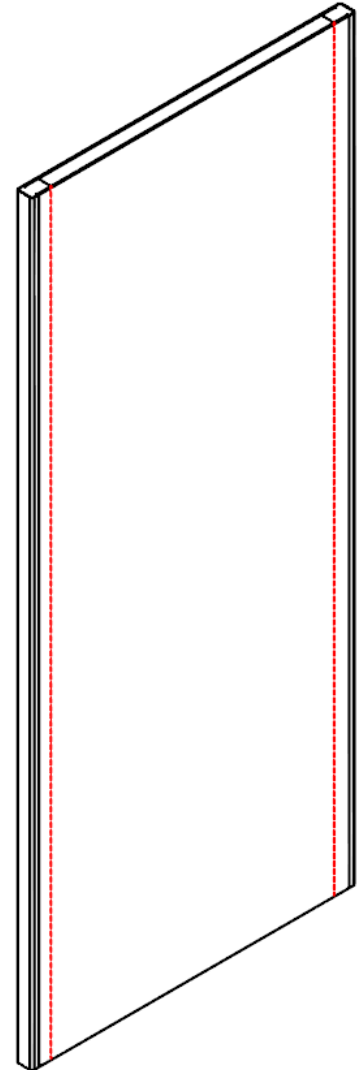

20 Minute Rated Agrifiber (AF5-20PP)

Bonded Agrifiber Core, 5-Ply Construction, Cat. A, PP

(Fire Test Standards – IBC, UL-10C, CAN/ULC S104, & NFPA 252)

	Single Swing	Pair or Double Egress
Core Type & Standards	Agrifiber: ANSI A208.1.2009 grade LD-1 (26-28 lb/ft³)	
Complies with CARB Phase I & II Emission Standards		
Maximum Sizes	4'3" x 9'0"	8'0" x 9'0"
Protection Plates	Up to 48" (above bottom of door)	
Door Thickness	1-3/4" (+/- 1/16")	
WDMA Prefit Tolerance	Width: (+/- 1/32") Height & Thickness: (+/- 1/16")	
Weight	5.11lb/ft² (3070 Door = 107lbs) (4070 Door = 143lbs)	
Crossband	High Density FSC Fiberboard	
Blocking	(Standard) 5" top rail; 1" Bottom Rail; 1" Fixed Internal Stiles (Additional blocking upon request)	
Assembly Adhesive	Face: Type I (waterproof); Core: Type II (water-resistant)	
Replaceable Edge Stiles & Covers	Field Replaceable SCL Stiles. Acrovyn and/or 20GA #4 finish Stainless Steel Replaceable Covers	
Replaceable Edge Profile	Beveled, Square	
Lites	5" from edges, 1-1/2" from hardware or additional cutouts	
Max Visible Glass Area	1296 in²	
Lite Frames	Wood beads; Metal – Painted, Wood Veneered, Acrovyn Wrapped	
Glazing	Any listed & labeled (20min or greater)	
Louvers	Not Available	
Electronic Options	Electronic hardware & raceways Available	
Hinges	Per NFPA 80 "Table 6.4.3.1"	
Points of Latching	Singles = 1pt	Pairs & DE w/ No Hose Stream = 2pts Double Egress w/ Hose Stream = 4pts
Pivots	Offset w/intermediate (Center hung not allowed)	
Locks	Mortise & Cylindrical (Max 5" Backset)	
Exit Devices	Surface Vertical Rod (Includes LBR), RIM & Mortised	
Concealed Vertical Rod	Not Available (Must use SCL core)	
Flushbolts	Must Be Extension Type (Metal Door)	
Closing Devices	Mortised or Surface Mounted	
Door Bottoms	Mortised or Surface Mounted	
Transoms	Available – Max opening size 4' x 9'	

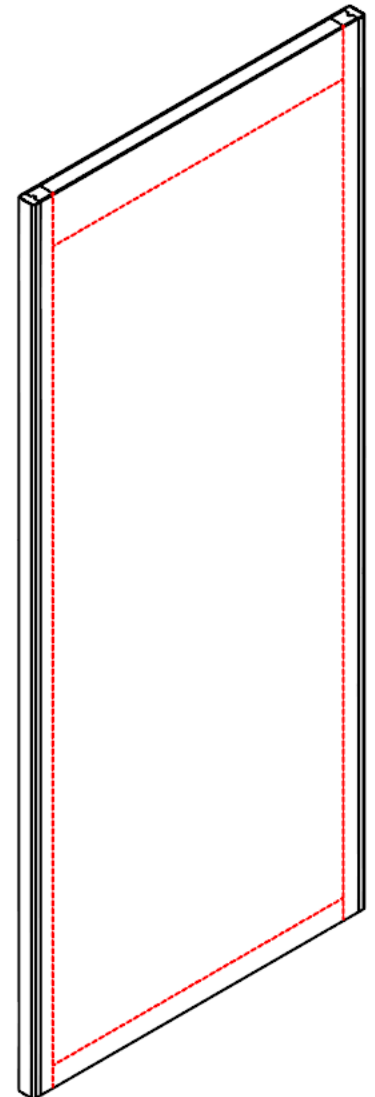

(Alternate)



Standard



31 -

3 Werner Way, Lebanon, NJ 08833 US, 800-416-6586

895 Lakefront Promenade, Mississauga, ON L5E 2C2 Canada, 905-274-3611

www.c-sgroup.com

© Copyright 2017 Construction Specialties, Inc. reserves the right to make any design changes or withdraw any design without notice.
(3/10/17)

20 Minute Rated FSC Particleboard (FSC PC5-20PP)

Bonded FSC Particleboard Core, 5-Ply Construction, Cat. A, PP

(Fire Test Standards – IBC, UL-10C, CAN/ULC S104, & NFPA 252)

Single Swing			Pair or Double Egress		
Core Type & Standards		FSC Certified Particleboard : ANSI A208.1.2009 grade LD-1 (32 lb/ft³)			
Complies with CARB Phase I & II Emission Standards					
Maximum Sizes		4'3" x 9'0"		8'0" x 9'0"	
Protection Plates		Up to 48" (above bottom of door)			
Door Thickness		1-3/4" (+/- 1/16")			
WDMA Prefit Tolerance		Width: (+/- 1/32") Height & Thickness: (+/- 1/16")			
Weight		5.26lb/ft² (3070 Door = 110lbs) (4070 Door = 147lbs)			
Crossband		High Density FSC Fiberboard			
Blocking		(Standard) 5" top rail; 1" Bottom Rail; 1" Fixed Internal Stiles (Additional blocking upon request)			
Assembly Adhesive		Face: Type I (waterproof); Core: Type II (water-resistant)			
Replaceable Edge Stiles & Covers		Field Replaceable SCL Stiles. Acrovyn and/or 20GA #4 finish Stainless Steel Replaceable Covers			
Replaceable Edge Profile		Beveled, Square			
Lites		5" from edges, 1-1/2" from hardware or additional cutouts			
Max Visible Glass Area		1296 in²			
Lite Frames		Wood beads; Metal – Painted, Wood Veneered, Acrovyn Wrapped			
Glazing		Any listed & labeled (20min or greater)			
Louvers		Not Available			
Electronic Options		Electronic hardware & raceways Available			
Hinges		Per NFPA 80 "Table 6.4.3.1"			
Points of Latching		Singles = 1pt		Pairs & DE w/ No Hose Stream = 2pts Double Egress w/ Hose Stream = 4pts	
Pivots		Offset w/intermediate (Center hung not allowed)			
Locks		Mortise & Cylindrical (Max 5" Backset)			
Exit Devices		Surface Vertical Rod (Includes LBR), RIM & Mortised			
Concealed Vertical Rod		Not Available (Must use SCL core)			
Flushbolts		Must Be Extension Type (Metal Door)			
Closing Devices		Mortised or Surface Mounted			
Door Bottoms		Mortised or Surface Mounted			
Transoms		Available – Max opening size 4' x 9'			

(Alternate)

Standard

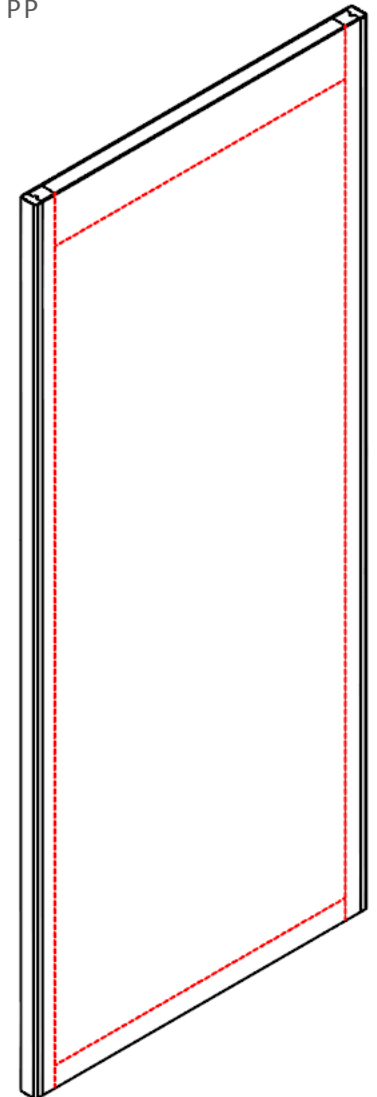

3 Werner Way, Lebanon, NJ 08833 US, 800-416-6586
895 Lakefront Promenade, Mississauga, ON L5E 2C2 Canada, 905-274-3611
www.c-sgroup.com

© Copyright 2017 Construction Specialties, Inc. reserves the right to make any design changes or withdraw any design without notice.
(3/10/17)

20 Minute Rated Particleboard (PC5-20PP)

Bonded Particleboard Core, 5-Ply Construction, Cat. A, PP

(Fire Test Standards – IBC, UL-10C, CAN/ULC S104, & NFPA 252)

	Single Swing	Pair or Double Egress
Core Type & Standards	Particleboard : ANSI A208.1.2009 grade LD-1 (32 lb/ft ³)	
Complies with CARB Phase I & II Emission Standards		
Maximum Sizes	4'3" x 9'0"	8'0" x 9'0"
Protection Plates	Up to 48" (above bottom of door)	
Door Thickness	1-3/4" (+/- 1/16")	
WDMA Prefit Tolerance	Width: (+/- 1/32") Height & Thickness: (+/- 1/16")	
Weight	5.30lb/ft ² (3070 Door = 111lbs) (4070 Door = 148lbs)	
Crossband	High Density FSC Fiberboard	
Blocking	(Standard) 5" top rail; 1" Bottom Rail; 1" Fixed Internal Stiles (Additional blocking upon request)	
Assembly Adhesive	Face: Type I (waterproof); Core: Type II (water-resistant)	
Replaceable Edge Stiles & Covers	Field Replaceable SCL Stiles. Acrovyn and/or 20GA #4 finish Stainless Steel Replaceable Covers	
Replaceable Edge Profile	Beveled, Square	
Lites	5" from edges, 1-1/2" from hardware or additional cutouts	
Max Visible Glass Area	1296 in ²	
Lite Frames	Wood beads; Metal – Painted, Wood Veneered, Acrovyn Wrapped	
Glazing	Any listed & labeled (20min or greater)	
Louvers	Not Available	
Electronic Options	Electronic hardware & raceways Available	
Hinges	Per NFPA 80 "Table 6.4.3.1"	
Points of Latching	Singles = 1pt	Pairs & DE w/ No Hose Stream = 2pts Double Egress w/ Hose Stream = 4pts
Pivots	Offset w/intermediate (Center hung not allowed)	
Locks	Mortise & Cylindrical (Max 5" Backset)	
Exit Devices	Surface Vertical Rod (Includes LBR), RIM & Mortised	
Concealed Vertical Rod	Not Available (Must use SCL core)	
Flushbolts	Must Be Extension Type (Metal Door)	
Closing Devices	Mortised or Surface Mounted	
Door Bottoms	Mortised or Surface Mounted	
Transoms	Available – Max opening size 4' x 9'	

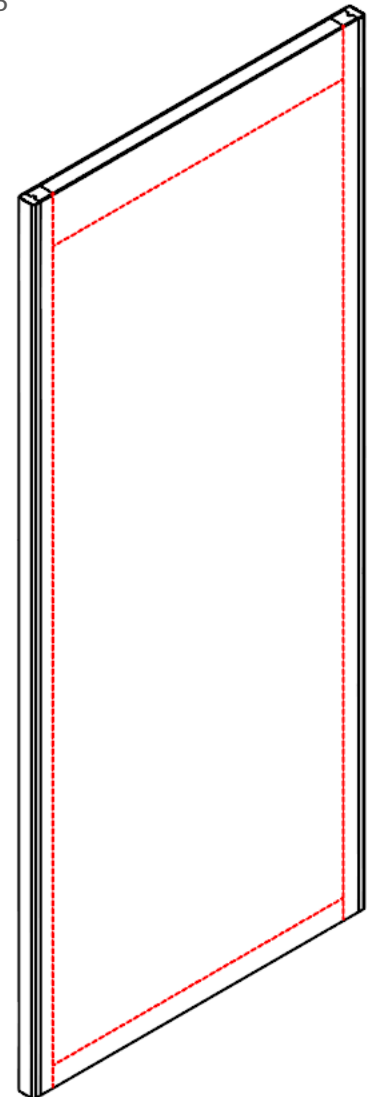

20 Minute Rated SCL (SCL5-20PP)

Bonded SCL Core, 5-Ply Construction, Cat. A, PP

(Fire Test Standards – IBC, UL-10C, CAN/ULC S104, & NFPA 252)

	Single Swing	Pair or Double Egress
Core Type & Standards	Structural Composite Lumber: (38 lb/ft ³)	
Maximum Sizes	4'3" x 10'0"	8'0" x 10'0"
Protection Plates	Up to 48" (above bottom of door)	
Door Thickness	1-3/4" (+/- 1/16")	
WDMA Prefit Tolerance	Width: (+/- 1/32") Height & Thickness: (+/- 1/16")	
Weight	6.92lb/ft ² (3070 Door = 145lbs) (4070 Door = 193lbs)	
Crossband	High Density FSC Fiberboard	
Blocking	(Standard) 5" top rail; 1" Bottom Rail; 1" Fixed Internal Stiles (Additional blocking upon request)	
Assembly Adhesive	Face: Type I (waterproof); Core: Type II (water-resistant)	
Replaceable Edge Stiles & Covers	Field Replaceable SCL Stiles. Acrovyn and/or 20GA #4 finish Stainless Steel Replaceable Covers	
Replaceable Edge Profile	Beveled, Square	
Lites	5" from edges, 1-1/2" from hardware or additional cutouts	
Max Visible Glass Area	1296 in ² w/ Hose Stream; 2814in ² w/ No Hose Stream	
Lite Frames	Wood beads; Metal – Painted, Wood Veneered, Acrovyn Wrapped	
Glazing	Any listed & labeled (20min or greater)	
Louvers	Not Available	
Electronic Options	Electronic hardware & raceways Available	
Hinges	Per NFPA 80 "Table 6.4.3.1"	
Points of Latching	Singles = 1pt	Pairs & DE w/ No Hose Stream = 2pts Double Egress w/ Hose Stream = 4pts
Pivots	Offset w/intermediate (Center hung not allowed)	
Locks	Mortise & Cylindrical (Max 5" Backset)	
Exit Devices	Surface Vertical Rod (Includes LBR), RIM & Mortised	
Concealed Vertical Rod	Available (With concealed 5" metal channel at latch edge)	
Flushbolts	Must Be Extension Type (Metal Door)	
Closing Devices	Mortised or Surface Mounted	
Door Bottoms	Mortised or Surface Mounted	
Transoms	Available – Max opening size 4' x 9'	

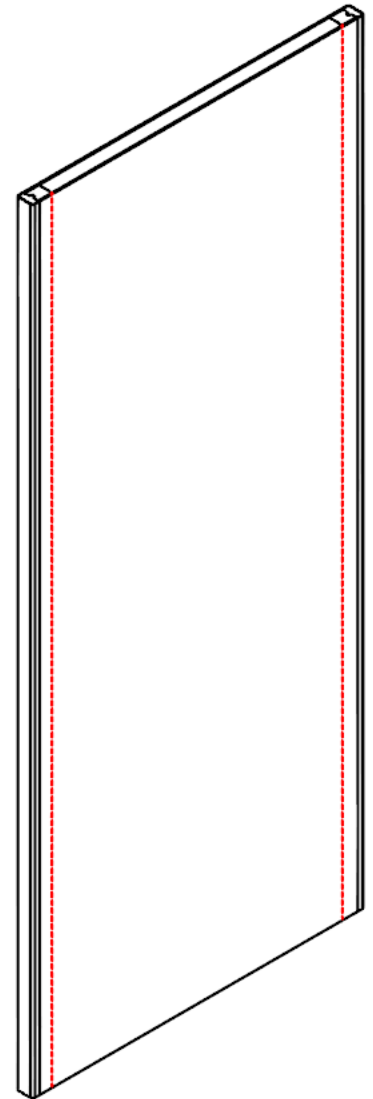

20 Minute Rated Panel Door (PN SCL5-20PP)

Bonded SCL Core, 5-Ply Construction, Cat. A, PP

(Fire Test Standards – IBC, UL-10C, CAN/ULC S104, & NFPA 252)

	Single Swing	Pair or Double Egress
Core Type & Standards	Structural Composite Lumber: (38 lb/ft ³)	
Maximum Sizes	4'0" x 10'0"	8'0" x 10'0"
Protection Plates	Up to 48" (above bottom of door)	
Door Thickness	1-3/4" (+/- 1/16")	
WDMA Prefit Tolerance	Width: (+/- 1/32") Height & Thickness: (+/- 1/16")	
Weight	6.92lb/ft ² (3070 Door = 145lbs) (4070 Door = 193lbs)	
Crossband	High Density FSC Fiberboard	
Blocking	(Standard) 5" top rail; 1" Bottom Rail; 1" Fixed Internal Stiles (Additional blocking upon request)	
Assembly Adhesive	Face: Type I (waterproof); Core: Type II (water-resistant)	
Replaceable Edge Stiles & Covers	Field Replaceable SCL Stiles. Acrovyn and/or 20GA #4 finish Stainless Steel Replaceable Covers	
Replaceable Edge Profile	Beveled, Square	
Lites	5" from edges, 1-1/2" from hardware or additional cutouts	
Max Visible Glass Area	1296 in ² w/ Hose Stream; 2814in ² w/ No Hose Stream	
Lite Frames	Wood beads; Metal – Painted, Wood Veneered, Acrovyn Wrapped	
Glazing	Any listed & labeled (20min or greater)	
Louvers	Not Available	
Electronic Options	Electronic hardware & raceways Available	
Hinges	Per NFPA 80 "Table 6.4.3.1"	
Points of Latching	Singles = 1pt	Pairs & DE w/ No Hose Stream = 2pts Double Egress w/ Hose Stream = 4pts
Pivots	Offset w/intermediate (Center hung not allowed)	
Locks	Mortise & Cylindrical (Max 5" Backset)	
Exit Devices	Surface Vertical Rod (Includes LBR), RIM & Mortised	
Concealed Vertical Rod	Available (With concealed 5" metal channel at latch edge)	
Flushbolts	Must Be Extension Type (Metal Door)	
Closing Devices	Mortised or Surface Mounted	
Door Bottoms	Mortised or Surface Mounted	
Transoms	Available – Max opening size 4' x 9'	
Panel Design Options	8 standard options (See Pages 10 - 18)	
Max Recess of Panel	3/8"	

(Alternate)

Standard

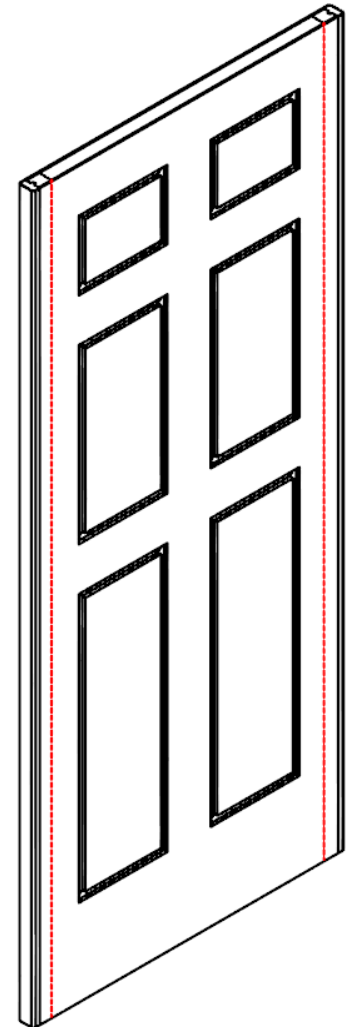

3 Werner Way, Lebanon, NJ 08833 US, 800-416-6586
895 Lakefront Promenade, Mississauga, ON L5E 2C2 Canada, 905-274-3611
www.c-sgroup.com

© Copyright 2017 Construction Specialties, Inc. reserves the right to make any design changes or withdraw any design without notice.
(3/10/17)

20 Minute Rated Barrier Resistant (BR SCL5-20PP)

Bonded SCL Core, 5-Ply Construction, Cat. A, PP

(Fire Test Standards – IBC, UL-10C, CAN/ULC S104, & NFPA 252)

Single Swing ONLY	
Core Type & Standards	Structural Composite Lumber: (38 Lb/Ft ³)
Maximum Sizes	4'3" X 10'0" Minimum Width: 2'8"
Wicket Door Size	Standard: 16" X 60", Max Width: 14" LESS main door (Up to 31-3/4"), Max Height: 75-3/4"
Wicket Door Location	Centered in width; 10" From Bottom of Door
Protection Plates	Up To 48" (Above Bottom Of Door)
Door Thickness	1-3/4" (+/- 1/16")
WDMA Prefit Tolerance	Width: (+/- 1/32") Height & Thickness: (+/- 1/16")
Weight	6.92lb/Ft ² (3070 Door = 145lbs) (4070 Door = 193lbs)
Crossband	High Density FSC Fiberboard
Blocking	(Standard) Full Core Blocking; 1" Fixed Internal Stiles
Assembly Adhesive	Face: Type I (Waterproof); Core: Type II (Water-Resistant)
Face Matching	Continuous Grain Match Not Available
Replaceable Edge Stiles & Covers	Field Replaceable SCL Stiles. Acrovyn and/or 20GA #4 finish Stainless Steel Replaceable Covers
Replaceable Edge Profile	Beveled, Square
Wicket Door Edge	Beveled Rabbeted Design
Lites	5" From Edges, 1-1/2" From Hardware Or Additional Cutouts
Max Visible Glass Area	100 in ² (Max width = 4" ; Max Height = 33")
Lite Frames	Wood Beads; Metal – Painted, Wood Veneered, Acrovyn Wrapped
Glazing	Any listed & labeled (20min or greater)
Louvers	Not Available
Electronic Options	Electronic Hardware & Raceways Available
Hinges (Main Door)	Per NFPA 80 "Table 6.4.3.1"
Hinges (Wicket Door)	(2) Tectus TE-340-3d, Included By CS
Pivots (Main Door)	Offset w/Intermediate
Locks (Main Door)	Mortise & Cylindrical
Locks (Wicket Door)	Recommended: Circular drive-in latch, single sided deadbolt
Exit Devices	Not Available
Concealed Vertical Rod	Not Available
Flushbolts	Not Available
Closing Devices	Mortised or Surface Mounted
Door Bottoms	Mortised or Surface Mounted
Transoms	Not Available

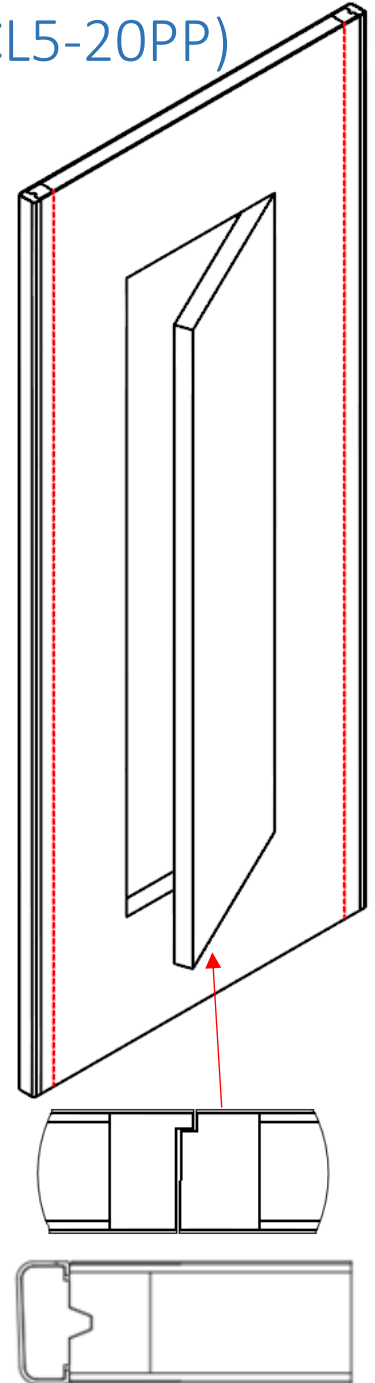

(Alternate)



Standard



(Not Tested For Detention Application)



20 Minute Rated Dutch Door (DD SCL5-20PP)

Bonded SCL Core, 5-Ply Construction, Cat. A, PP

(Fire Test Standards – IBC, UL-10C, CAN/ULC S104, & NFPA 252)

Single Swing	
Core Type & Standards	Structural Composite Lumber: (38 lb/ft ³)
Maximum Sizes	4'0" x 8'0"
Protection Plates	Up to 48" (above bottom of door)
Door Thickness	1-3/4" (+/- 1/16")
WDMA Prefit Tolerance	Width: (+/- 1/32") Height & Thickness: (+/- 1/16")
Weight	6.92lb/ft ² (3070 Door = 145lbs) (4070 Door = 193lbs)
Crossband	High Density FSC Fiberboard
Blocking	(Standard) 5" top rail; 1" Bottom Rail; 1" Fixed Internal Stiles (Additional blocking upon request)
Assembly Adhesive	Face: Type I (waterproof); Core: Type II (water-resistant)
Replaceable Edge Stiles & Covers	Field Replaceable SCL Stiles. Acrovyn and/or 20GA #4 finish Stainless Steel Replaceable Covers
Replaceable Edge Profile	Beveled, Square
Lites	5" from edges, 1-1/2" from hardware or additional cutouts
Max Visible Glass Area	1296 in ² (Top leaf only) Max Visible Glass width = 36"
Lite Frames	Wood beads; Metal – Painted, Wood Veneered, Acrovyn Wrapped
Glazing	Any listed & labeled (20min or greater)
Louvers	Not Available
Electronic Options	Electronic hardware & raceways Available
Hinges	Per NFPA 80 "Table 6.4.3.1"
Points of Latching	Singles = 2pts Each leaf must latch into the frame
Pivots	Offset w/intermediate (Center hung not allowed)
Locks	Mortise & Cylindrical (Max 5" Backset)
Exit Devices	Surface Vertical Rod (Includes LBR), RIM & Mortised
Concealed Vertical Rod	Available (With concealed 5" metal channel at latch edge)
Flushbolts	Must Be Extension Type (Metal Door)
Closing Devices	Mortised or Surface Mounted
Door Bottoms	Mortised or Surface Mounted
Transoms	Available – Max opening size 4' x 9'
Shelf Options	Optional – Single or Double sided, with or without gussets Max shelf overhang – 6 inches.

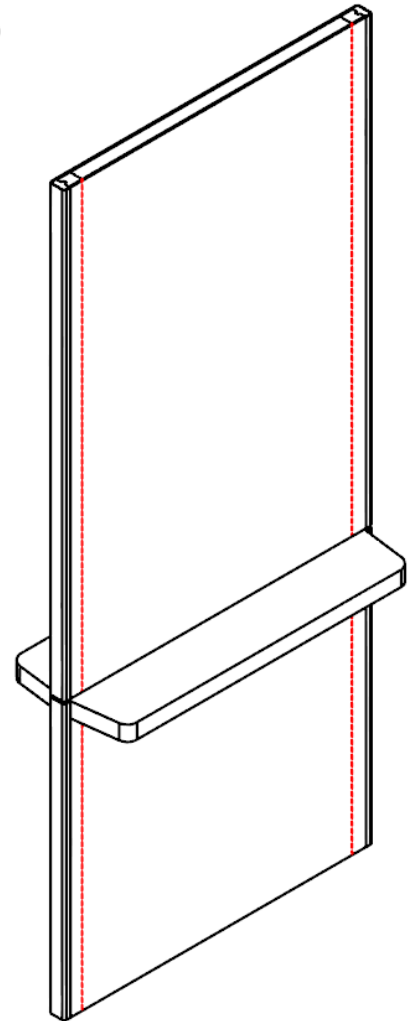

45 Minute Rated Mineral (FD5-45PP)

Bonded Mineral Core, 5-Ply Construction, Cat. A, PP

(Fire Test Standards – IBC, UL-10C, CAN/ULC S104, & NFPA 252)

	Single Swing	Pair or Double Egress
Core Type & Standards	Mineral Composite: (28-35 lb/ft ³)	
Maximum Sizes	4'0" x 9'0"	8'0" x 9'0"
Protection Plates	Up to 48" (above bottom of door)	
Door Thickness	1-3/4" (+/- 1/16")	
WDMA Prefit Tolerance	Width: (+/- 1/32") Height & Thickness: (+/- 1/16")	
Weight	6.20lb/ft ² (3070 Door = 130lbs) (4070 Door = 173lbs)	
Crossband	High Density FSC Fiberboard	
Blocking	(Standard) 5" top rail; 1" Bottom Rail; 1" Fixed Internal Stiles (Additional blocking upon request)	
Assembly Adhesive	Face: Type I (waterproof); Core: Type II (water-resistant)	
Replaceable Edge Stiles & Covers	Field Replaceable Mineral/SCL Stiles. Acrovyn and/or 20GA #4 finish Stainless Steel Replaceable Covers	
Replaceable Edge Profile	Beveled, Square	
Lites	6" from edges, 5" from hardware or additional cutouts	
Max Visible Glass Area	1296 in ²	
Lite Frames	Wood beads; Metal – Painted, Wood Veneered, Acrovyn Wrapped	
Glazing	Any listed & labeled (45min or greater)	
Louvers	Not Available	
Electronic Options	Electronic hardware & raceways Available	
Hinges	Per NFPA 80 "Table 6.4.3.1"	
Points of Latching	Singles = 1pt	Pairs = 3pts (2pts w/ Blue Core) DE Pairs = 4pts (2pts w/ Blue Core)
Pivots	Offset w/intermediate (Center hung not allowed)	
Locks	Mortise & Cylindrical (Max 5" Backset)	
Exit Devices	Surface Vertical Rod (Includes LBR), RIM & Mortised	
Concealed Vertical Rod	Available (With concealed 5" metal channel at latch edge)	
Flushbolts	Must Be Extension Type (Metal Door)	
Closing Devices	Mortised or Surface Mounted	
Door Bottoms	Mortised or Surface Mounted	
Transoms	Not Available	

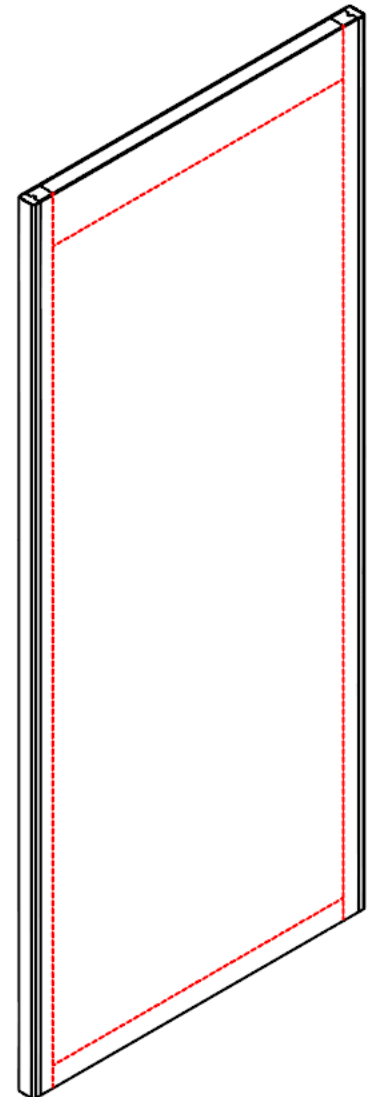

45 Minute Rated Mineral STC35/34 (FD5-45PP STC 35/34)

Bonded Mineral Core, 5-Ply Construction, Cat. A, PP

(Fire Test Standards – IBC, UL-10C, CAN/ULC S104, & NFPA 252)

	Single Swing (STC35)	Pair or Double Egress (STC34)
Core Type & Standards	Mineral Composite: (28-35 lb/ft ³)	
Maximum Sizes	4'0" x 9'0"	8'0" x 9'0"
Protection Plates	Up to 48" (above bottom of door)	
Door Thickness	1-3/4" (+/- 1/16")	
WDMA Prefit Tolerance	Width: (+/- 1/32") Height & Thickness: (+/- 1/16")	
Weight	6.20lb/ft ² (3070 Door = 130lbs) (4070 Door = 173lbs)	
Crossband	High Density FSC Fiberboard	
Blocking	(Standard) 5" top rail; 1" Bottom Rail; 1" Fixed Internal Stiles (Additional blocking upon request)	
Assembly Adhesive	Face: Type I (waterproof); Core: Type II (water-resistant)	
Replaceable Edge Stiles & Covers	Non-Replaceable Mineral/SCL Stiles. Acrovyn and/or 20GA #4 finish Stainless Steel Replaceable Covers	
Replaceable Edge Profile	Beveled, Square	
Lites	Not Available	
Louvers	Not Available	
Electronic Options	Electronic hardware & raceways Available	
Hinges	Per NFPA 80 "Table 6.4.3.1"	
Points of Latching	Singles = 1pt	Pairs = 3pts (2pts w/ Blue Core) DE Pairs = 4pts (2pts w/ Blue Core)
Pivots	Offset w/intermediate (Center hung not allowed)	
Locks	Mortise & Cylindrical (Max 5" Backset)	
Exit Devices	Surface Vertical Rod (Includes LBR), RIM & Mortised	
Concealed Vertical Rod	Not Available	
Flushbolts	Must Be Extension Type (Metal Door)	
Closing Devices	Surface Mounted	
Door Bottoms	Mortised or Surface Mounted	
STC-35 Operable (Singles) (Required Gaskets Option 1)	Pemko: S773 on head & jambs at stop face. S44 at head and jambs at outside rabbet, and 3692APK773	
STC-35 Operable (Singles) (Required Gaskets Option 2)	Pemko: S773 on head & jambs at stop face. S44 at head and jambs at outside rabbet. S771 lock stile at edge of leaf, and 3692APK773	
STC-34 Operable (Pairs) (Required Gasketing)	Pemko: S773 on head, jambs, strike stile & bottom rail. S44 on head & jambs. S1125 on lock & strike stile, 357 astragal, PDB411, and ACP112	

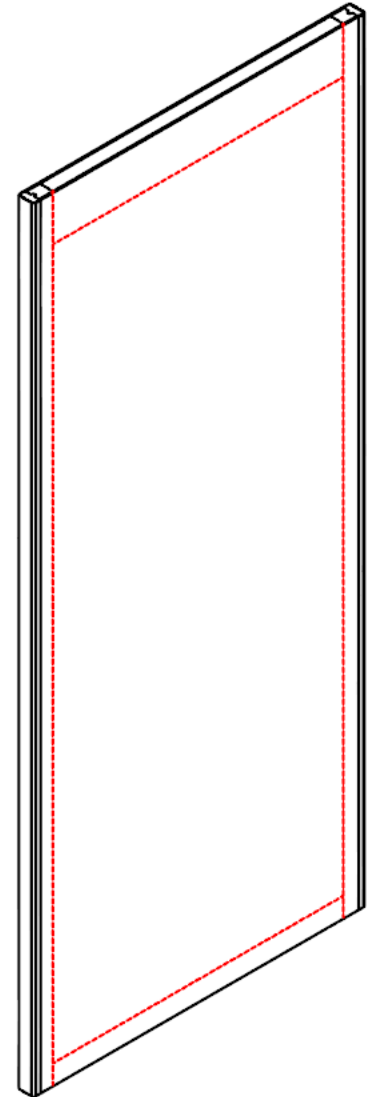

45 Minute Rated Panel Door (PN FD7-45PP)

Bonded SCL Hybrid Core, 7-Ply Construction, Cat. A, PP

(Fire Test Standards – IBC, UL-10C, CAN/ULC S104, & NFPA 252)

	Single Swing	Pair or Double Egress
Core Type & Standards	SCL Hybrid: (60 lb/ft ³)	
Maximum Sizes	4'0" x 9'0"	8'0" x 9'0"
Protection Plates	Up to 48" (above bottom of door)	
Door Thickness	1-3/4" (+/- 1/16")	
WDMA Prefit Tolerance	Width: (+/- 1/32") Height & Thickness: (+/- 1/16")	
Weight	6.92lb/ft ² (3070 Door = 145lbs) (4070 Door = 193lbs)	
Crossband	High Density FSC Fiberboard	
Blocking	(Standard) 5" top rail; 2" Bottom Rail; 5" Fixed Internal Stiles (Additional blocking upon request)	
Assembly Adhesive	Face: Type I (waterproof); Core: Type II (water-resistant)	
Replaceable Edge Stiles & Covers	Field Replaceable Mineral/SCL Stiles. Acrovyn and/or 20GA #4 finish Stainless Steel Replaceable Covers	
Replaceable Edge Profile	Beveled, Square	
Lites	Not Available	
Max Visible Glass Area	Not Available	
Lite Frames	Not Available	
Louvers	Not Available	
Electronic Options	Not Available	
Hinges	Per NFPA 80 "Table 6.4.3.1"	
Points of Latching	Singles = 1pt	Pairs = 2pts DE Pairs = 3pts
Pivots	Offset w/intermediate (Center hung not allowed)	
Locks	Mortise & Cylindrical (Max 5" Backset)	
Exit Devices	Surface Vertical Rod (Includes LBR), RIM & Mortised	
Concealed Vertical Rod	Not Available	
Flushbolts	Must Be Extension Type (Metal Door)	
Closing Devices	Surface Mounted	
Door Bottoms	Mortised or Surface Mounted	
Transoms	Not Available	
Panel Design Options	8 standard options (See Pages 10 - 18)	
Max Recess of Panel	3/8"	

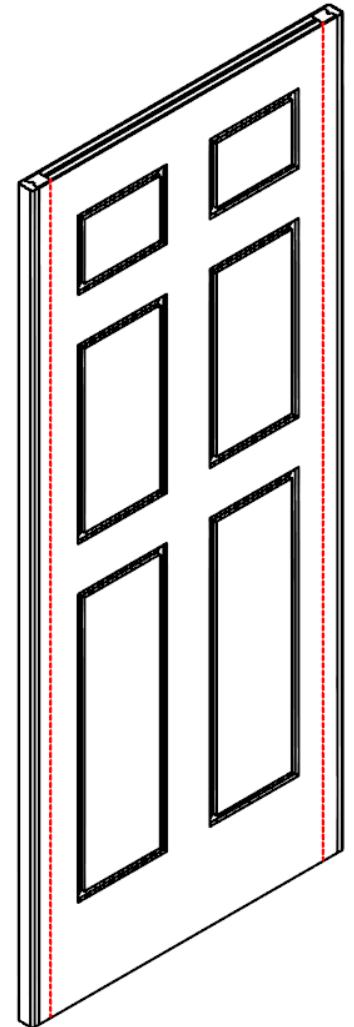

60 Minute Rated Mineral (FD5-60PP)

Bonded Mineral Core, 5-Ply Construction, Cat. A, PP

(Fire Test Standards – IBC, UL-10C, CAN/ULC S104, & NFPA 252)

	Single Swing	Pair or Double Egress
Core Type & Standards	Mineral Composite: (28-35 lb/ft ³)	
Maximum Sizes	4'0" x 9'0"	8'0" x 9'0"
Protection Plates	Up to 48" (above bottom of door)	
Door Thickness	1-3/4" (+/- 1/16")	
WDMA Prefit Tolerance	Width: (+/- 1/32") Height & Thickness: (+/- 1/16")	
Weight	6.20lb/ft ² (3070 Door = 130lbs) (4070 Door = 173lbs)	
Crossband	High Density FSC Fiberboard	
Blocking	(Standard) 5" top rail; 1" Bottom Rail; 1" Fixed Internal Stiles (Additional blocking upon request)	
Assembly Adhesive	Face: Type I (waterproof); Core: Type II (water-resistant)	
Replaceable Edge Stiles & Covers	Field Replaceable Mineral/SCL Stiles. Acrovyn and/or 20GA #4 finish Stainless Steel Replaceable Covers	
Replaceable Edge Profile	Beveled, Square	
Lites	6" from edges, 5" from hardware or additional cutouts	
Max Visible Glass Area	100 in ²	
Lite Frames	Wood beads; Metal – Painted, Wood Veneered, Acrovyn Wrapped	
Glazing	Any listed & labeled (60min or greater)	
Louvers	Not Available	
Electronic Options	Electronic hardware & raceways Available	
Hinges	Per NFPA 80 "Table 6.4.3.1"	
Points of Latching	Singles = 1pt	Pairs = 4pts (2pts w/ GP Blue Core) DE Pairs = 4pts (2pts w/ GP Blue Core)
Pivots	Offset w/intermediate (Center hung not allowed)	
Locks	Mortise & Cylindrical (Max 5" Backset)	
Exit Devices	Surface Vertical Rod (Includes LBR), RIM & Mortised	
Concealed Vertical Rod	Available (With concealed 5" metal channel at latch edge)	
Flushbolts	Must Be Extension Type (Metal Door)	
Closing Devices	Mortised or Surface Mounted	
Door Bottoms	Mortised or Surface Mounted	
Transoms	Not Available	

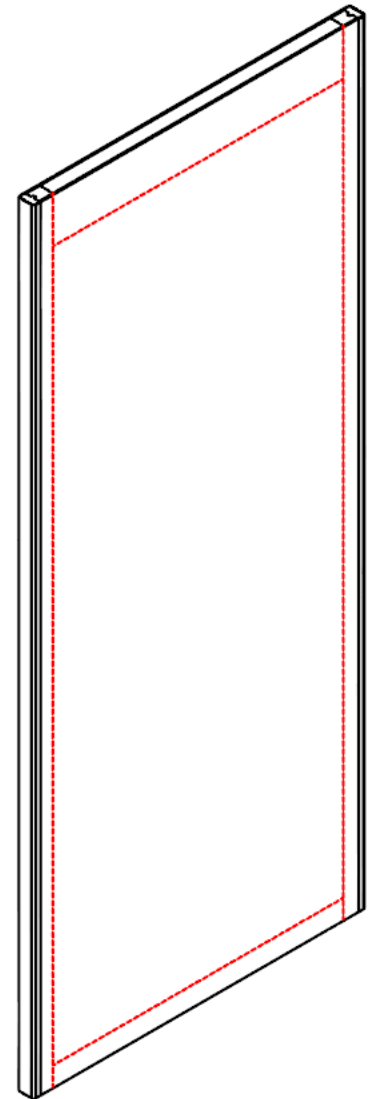

3 Werner Way, Lebanon, NJ 08833 US, 800-416-6586
895 Lakefront Promenade, Mississauga, ON L5E 2C2 Canada, 905-274-3611
www.c-sgroup.com

© Copyright 2017 Construction Specialties, Inc. reserves the right to make any design changes or withdraw any design without notice.
(3/10/17)

60 Minute Rated Mineral STC35/34 (FD5-60PP STC 35/34)

Bonded Mineral Core, 5-Ply Construction, Cat. A, PP

(Fire Test Standards – IBC, UL-10C, CAN/ULC S104, & NFPA 252)

	Single Swing (STC35)	Pair or Double Egress (STC34)
Core Type & Standards	Mineral Composite: (28-35 lb/ft ³)	
Maximum Sizes	4'0" x 9'0"	8'0" x 9'0"
Protection Plates	Up to 48" (above bottom of door)	
Door Thickness	1-3/4" (+/- 1/16")	
WDMA Prefit Tolerance	Width: (+/- 1/32") Height & Thickness: (+/- 1/16")	
Weight	6.20lb/ft ² (3070 Door = 130lbs) (4070 Door = 173lbs)	
Crossband	High Density FSC Fiberboard	
Blocking	(Standard) 5" top rail; 1" Bottom Rail; 1" Fixed Internal Stiles (Additional blocking upon request)	
Assembly Adhesive	Face: Type I (waterproof); Core: Type II (water-resistant)	
Replaceable Edge Stiles & Covers	Non-Replaceable Mineral/SCL Stiles. Acrovyn and/or 20GA #4 finish Stainless Steel Replaceable Covers	
Replaceable Edge Profile	Beveled, Square	
Lites	Not Available	
Louvers	Not Available	
Electronic Options	Electronic hardware & raceways Available	
Hinges	Per NFPA 80 "Table 6.4.3.1"	
Points of Latching	Singles = 1pt	Pairs = 3pts (2pts w/ Blue Core) DE Pairs = 4pts (2pts w/ Blue Core)
Pivots	Offset w/intermediate (Center hung not allowed)	
Locks	Mortise & Cylindrical (Max 5" Backset)	
Exit Devices	Surface Vertical Rod (Includes LBR), RIM & Mortised	
Concealed Vertical Rod	Not Available	
Flushbolts	Must Be Extension Type (Metal Door)	
Closing Devices	Surface Mounted	
Door Bottoms	Mortised or Surface Mounted	
STC-35 Operable (Singles) (Required Gaskets Option 1)	Pemko: S773 on head & jambs at stop face. S44 at head and jambs at outside rabbet, and 3692APK773	
STC-35 Operable (Singles) (Required Gaskets Option 2)	Pemko: S773 on head & jambs at stop face. S44 at head and jambs at outside rabbet. S771 lock stile at edge of leaf, and 3692APK773	
STC-34 Operable (Pairs) (Required Gasketing)	Pemko: S773 on head, jambs, strike stile & bottom rail. S44 on head & jambs. S1125 on lock & strike stile, 357 astragal, PDB411, and ACP112	

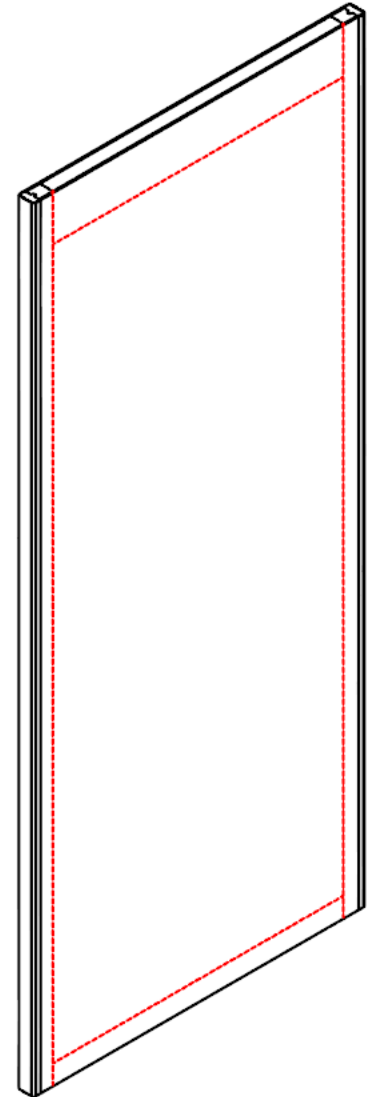

3 Werner Way, Lebanon, NJ 08833 US, 800-416-6586
895 Lakefront Promenade, Mississauga, ON L5E 2C2 Canada, 905-274-3611
www.c-sgroup.com

© Copyright 2017 Construction Specialties, Inc. reserves the right to make any design changes or withdraw any design without notice.
(3/10/17)

60 Minute Rated Panel Door (PN FD7-60PP)

Bonded SCL Hybrid Core, 7-Ply Construction, Cat. A, PP

(Fire Test Standards – IBC, UL-10C, CAN/ULC S104, & NFPA 252)

	Single Swing	Pair or Double Egress
Core Type & Standards	SCL Hybrid: (60 lb/ft ³)	
Maximum Sizes	4'0" x 9'0"	8'0" x 9'0"
Protection Plates	Up to 48" (above bottom of door)	
Door Thickness	1-3/4" (+/- 1/16")	
WDMA Prefit Tolerance	Width: (+/- 1/32") Height & Thickness: (+/- 1/16")	
Weight	6.92lb/ft ² (3070 Door = 145lbs) (4070 Door = 193lbs)	
Crossband	High Density FSC Fiberboard	
Blocking	(Standard) 5" top rail; 2" Bottom Rail; 5" Fixed Internal Stiles (Additional blocking upon request)	
Assembly Adhesive	Face: Type I (waterproof); Core: Type II (water-resistant)	
Replaceable Edge Stiles & Covers	Field Replaceable Mineral/SCL Stiles. Acrovyn and/or 20GA #4 finish Stainless Steel Replaceable Covers	
Replaceable Edge Profile	Beveled, Square	
Lites	Not Available	
Max Visible Glass Area	Not Available	
Lite Frames	Not Available	
Louvers	Not Available	
Electronic Options	Not Available	
Hinges	Per NFPA 80 "Table 6.4.3.1"	
Points of Latching	Singles = 1pt	Pairs = 3pts DE Pairs = 2pts
Pivots	Offset w/intermediate (Center hung not allowed)	
Locks	Mortise & Cylindrical (Max 5" Backset)	
Exit Devices	Surface Vertical Rod (Includes LBR), RIM & Mortised	
Concealed Vertical Rod	Not Available	
Flushbolts	Must Be Extension Type (Metal Door)	
Closing Devices	Surface Mounted	
Door Bottoms	Mortised or Surface Mounted	
Transoms	Not Available	
Panel Design Options	8 standard options (See Pages 10 - 18)	
Max Recess of Panel	3/8"	

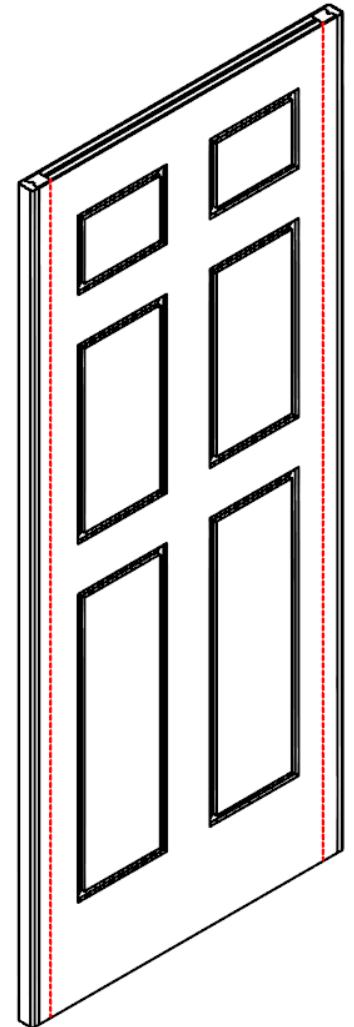

3 Werner Way, Lebanon, NJ 08833 US, 800-416-6586
 895 Lakefront Promenade, Mississauga, ON L5E 2C2 Canada, 905-274-3611
www.c-sgroup.com

© Copyright 2017 Construction Specialties, Inc. reserves the right to make any design changes or withdraw any design without notice.
 (3/10/17)

90 Minute Rated Mineral (FD5-90PP)

Bonded Mineral Core, 5-Ply Construction, Cat. A, PP

(Fire Test Standards – IBC, UL-10C, CAN/ULC S104, & NFPA 252)

	Single Swing	Pair or Double Egress
Core Type & Standards	GP Blue Core: (28-35 lb/ft ³)	
Maximum Sizes	4'0" x 9'0"	8'0" x 9'0"
Protection Plates	Up to 48" (above bottom of door)	
Door Thickness	1-3/4" (+/- 1/16")	
WDMA Prefit Tolerance	Width: (+/- 1/32") Height & Thickness: (+/- 1/16")	
Weight	6.58lb/ft ² (3070 Door = 137lbs) (4070 Door = 184lbs)	
Crossband	High Density FSC Fiberboard	
Blocking	(Standard) 5" top rail; 2" Bottom Rail; 5" Fixed Internal Stiles (Additional blocking upon request)	
Assembly Adhesive	Face: Type I (waterproof); Core: Type II (water-resistant)	
Replaceable Edge Stiles & Covers	Field Replaceable Mineral/SCL Stiles. Acrovyn and/or 20GA #4 finish Stainless Steel Replaceable Covers	
Replaceable Edge Profile	Beveled, Square	
Lites	6" from edges, 5" from hardware or additional cutouts	
Max Visible Glass Area	100 in ²	
Lite Frames	Wood beads; Metal – Painted, Wood Veneered, Acrovyn Wrapped	
Glazing	Any listed & labeled (90min or greater)	
Louvers	Not Available	
Electronic Options	Electronic hardware & raceways Available	
Hinges	Per NFPA 80 "Table 6.4.3.1"	
Points of Latching	Singles = 1pt	Pairs = 2pts DE Pairs = 2pts
Pivots	Offset w/intermediate (Center hung not allowed)	
Locks	Mortise & Cylindrical (Max 5" Backset)	
Exit Devices	Surface Vertical Rod (Includes LBR), RIM & Mortised	
Concealed Vertical Rod	Available (With concealed 5" metal channel at latch edge)	
Flushbolts	Must Be Extension Type (Metal Door)	
Closing Devices	Mortised or Surface Mounted	
Door Bottoms	Mortised or Surface Mounted	
Transoms	Not Available	

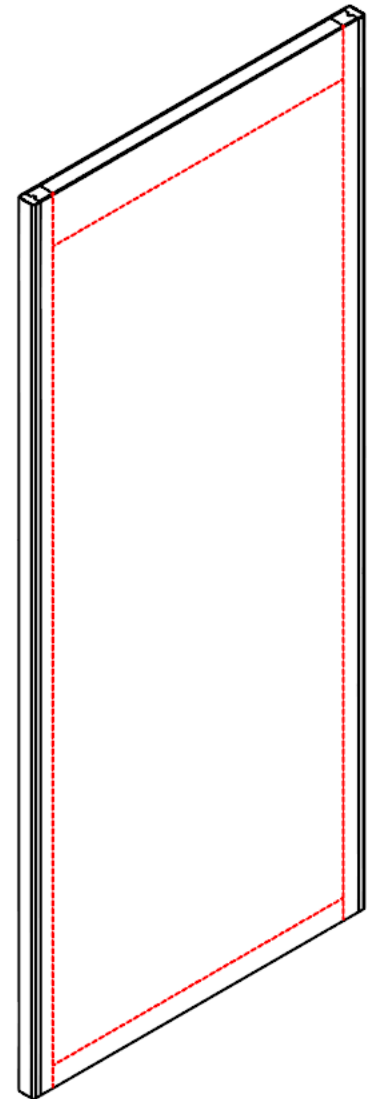

3 Werner Way, Lebanon, NJ 08833 US, 800-416-6586
895 Lakefront Promenade, Mississauga, ON L5E 2C2 Canada, 905-274-3611
www.c-sgroup.com

© Copyright 2017 Construction Specialties, Inc. reserves the right to make any design changes or withdraw any design without notice.
(3/10/17)

90 Minute Rated Mineral STC36 (FD5-90PP STC 36)

Bonded Mineral Core, 5-Ply Construction, Cat. A, PP

(Fire Test Standards – IBC, UL-10C, CAN/ULC S104, & NFPA 252)

	Single Swing
Core Type & Standards	GP Blue Core: (28-35 lb/ft ³)
Maximum Sizes	4'0" x 9'0"
Protection Plates	Up to 48" (above bottom of door)
Door Thickness	1-3/4" (+/- 1/16")
WDMA Prefit Tolerance	Width: (+/- 1/32") Height & Thickness: (+/- 1/16")
Weight	6.58lb/ft ² (3070 Door = 137lbs) (4070 Door = 184lbs)
Crossband	High Density FSC Fiberboard
Blocking	(Standard) 5" top rail; 2" Bottom Rail; 5" Fixed Internal Stiles (Additional blocking upon request)
Assembly Adhesive	Face: Type I (waterproof); Core: Type II (water-resistant)
Replaceable Edge Stiles & Covers	Non-Replaceable Mineral/SCL Stiles. Acrovyn and/or 20GA #4 finish Stainless Steel Replaceable Covers
Replaceable Edge Profile	Beveled, Square
Lites	Not Available
Louvers	Not Available
Electronic Options	Electronic hardware & raceways Available
Hinges	Per NFPA 80 "Table 6.4.3.1"
Points of Latching	Singles = 1pt
Pivots	Offset w/intermediate (Center hung not allowed)
Locks	Mortise & Cylindrical (Max 5" Backset)
Exit Devices	Surface Vertical Rod (Includes LBR), RIM & Mortised
Concealed Vertical Rod	Not Available
Flushbolts	Must Be Extension Type (Metal Door)
Closing Devices	Surface Mounted
Door Bottoms	Mortised or Surface Mounted
Transoms	Not Available
STC-36 Operable (Required Gaskets Option 1)	Pemko: S773 on head & jambs at stop face. S44 at head and jambs at outside rabbet, and 3692APK773
STC-36 Operable (Required Gaskets Option 2)	Pemko: S773 on head & jambs at stop face. S44 at head and jambs at outside rabbet. S771 lock stile at edge of leaf, and 3692APK773
STC-36 Operable (Required Gaskets Option 3)	Pemko: S44 on head & jambs at stop face. S44 at head & jambs at outside rabbet. S771 lock stile at edge of leaf, and 3692APK773

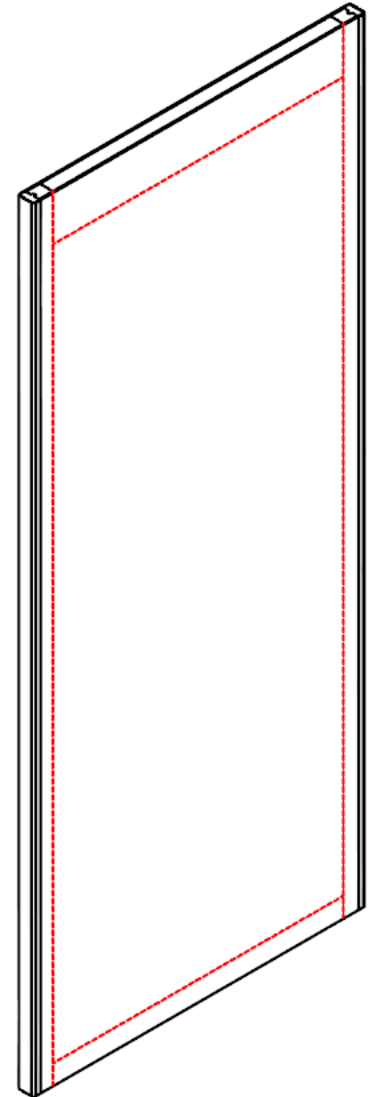

Lead Lined, Non-Rated Agrifiber (LL AF7-NR)

Bonded Agrifiber Core, 7-Ply Construction

Single Swing		Pair or Double Egress
Core Type & Standards	Agrifiber: ANSI A208.1.2009 grade LD-1 (26-28 lb/ft³)	
Complies with CARB Phase I & II Emission Standards		
Maximum Sizes	4'0" x 8'0"	8'0" x 8'0" (Requires Lead Astragal)
Protection Plates	Up to 48" (above bottom of door)	
Door Thickness	1-3/4" (+/- 1/16")	
Lead Thickness	1/16" (4lb) or 1/8" (8lb), Balanced Construction	
WDMA Prefit Tolerance	Width: (+/- 1/32") Height & Thickness: (+/- 1/16")	
Weight	1/16" Lead – 9.01lb/ft² (3070 = 187lbs) (4070 = 252lbs) 1/8" Lead – 12.84lb/ft² (3070 = 267lbs) (4070 = 360lbs)	
Crossband	High Density FSC Fiberboard	
Blocking	(Standard) 5" top rail; 1" Bottom Rail; 1" Fixed Internal Stiles (Additional blocking upon request)	
Assembly Adhesive	Face: Type I (waterproof); Core: Type II (water-resistant)	
Replaceable Edge Stiles & Covers	Non-Replaceable SCL Stiles. Acrovyn and/or 20GA #4 finish Stainless Steel Replaceable Covers	
Replaceable Edge Profile	Beveled, Square	
Lites	5" from edges, 1-1/2" from hardware or additional cutouts	
Lite Frames	Metal Lead Lined– Painted, Wood Veneered, Acrovyn Wrapped	
Glazing	Any appropriate lead equivalency	
Louvers	Not Available	
Electronic Options	Electronic hardware & raceways Available	
Hinges	Mortised, Surface & Continuous	
Pivots	Center hung & Offset w/intermediate	
Locks	Mortise & Cylindrical	
Exit Devices	Surface Vertical Rod (Includes LBR), RIM & Mortised	
Concealed Vertical Rod	Not Available	
Flushbolts	Must Be Extension Type (Metal Door)	
Closing Devices	Mortised or Surface Mounted (Mortised will affect lead)	
Door Bottoms	Mortised or Surface Mounted (Mortised will affect lead)	
Transoms	Not Available	

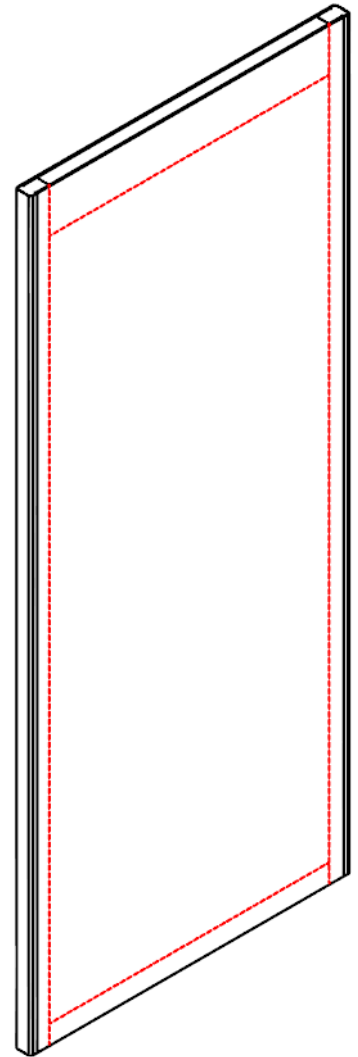

3 Werner Way, Lebanon, NJ 08833 US, 800-416-6586
895 Lakefront Promenade, Mississauga, ON L5E 2C2 Canada, 905-274-3611
www.c-sgroup.com

© Copyright 2017 Construction Specialties, Inc. reserves the right to make any design changes or withdraw any design without notice.
(3/10/17)

Lead Lined, Non-Rated FSC Particleboard (LL FSC7-NR)

Bonded FSC Particleboard Core, 7-Ply Construction

Single Swing		Pair or Double Egress
Core Type & Standards	FSC Particleboard: ANSI A208.1.2009 grade LD-1 (32 lb/ft³)	
Complies with CARB Phase I & II Emission Standards		
Maximum Sizes	4'0" x 8'0"	8'0" x 8'0" (Requires Lead Astragal)
Protection Plates	Up to 48" (above bottom of door)	
Door Thickness	1-3/4" (+/- 1/16")	
Lead Thickness	1/16" (4lb) or 1/8" (8lb), Balanced Construction	
WDMA Prefit Tolerance	Width: (+/- 1/32") Height & Thickness: (+/- 1/16")	
Weight	1/16" Lead – 8.96lb/ft² (3070 = 186lbs) (4070 = 251lbs) 1/8" Lead – 12.79lb/ft² (3070 = 265lbs) (4070 = 358lbs)	
Crossband	High Density FSC Fiberboard	
Blocking	(Standard) 5" top rail; 1" Bottom Rail; 1" Fixed Internal Stiles (Additional blocking upon request)	
Assembly Adhesive	Face: Type I (waterproof); Core: Type II (water-resistant)	
Replaceable Edge Stiles & Covers	Non-Replaceable SCL Stiles. Acrovyn and/or 20GA #4 finish Stainless Steel Replaceable Covers	
Replaceable Edge Profile	Beveled, Square	
Lites	5" from edges, 1-1/2" from hardware or additional cutouts	
Lite Frames	Metal Lead Lined– Painted, Wood Veneered, Acrovyn Wrapped	
Glazing	Any appropriate lead equivalency	
Louvers	Not Available	
Electronic Options	Electronic hardware & raceways Available	
Hinges	Mortised, Surface & Continuous	
Pivots	Center hung & Offset w/intermediate	
Locks	Mortise & Cylindrical	
Exit Devices	Surface Vertical Rod (Includes LBR), RIM & Mortised	
Concealed Vertical Rod	Not Available	
Flushbolts	Must Be Extension Type (Metal Door)	
Closing Devices	Mortised or Surface Mounted (Mortised will affect lead)	
Door Bottoms	Mortised or Surface Mounted (Mortised will affect lead)	
Transoms	Not Available	

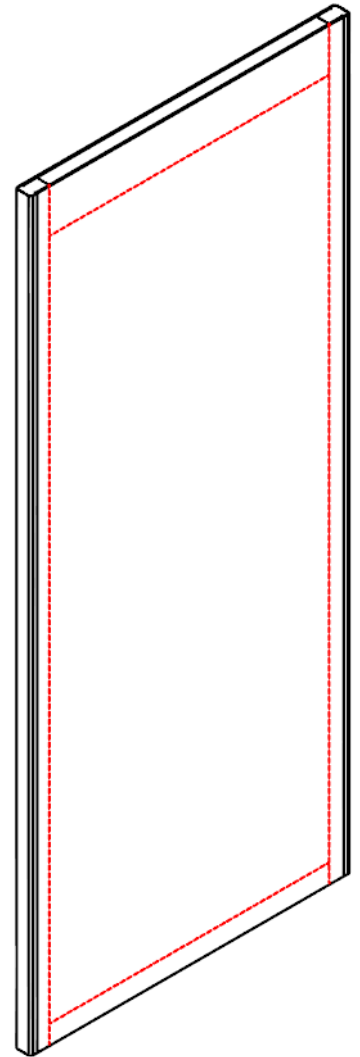

Lead Lined, Non-Rated Particleboard (LL PC7-NR)

Bonded Particleboard Core, 7-Ply Construction

	Single Swing	Pair or Double Egress
Core Type & Standards	Particleboard: ANSI A208.1.2009 grade LD-1 (32 lb/ft ³)	
Maximum Sizes	4'0" x 8'0"	8'0" x 8'0" (Requires Lead Astragal)
Protection Plates	Up to 48" (above bottom of door)	
Door Thickness	1-3/4" (+/- 1/16")	
Lead Thickness	1/16" (4lb) or 1/8" (8lb), Balanced Construction	
WDMA Prefit Tolerance	Width: (+/- 1/32") Height & Thickness: (+/- 1/16")	
Weight	1/16" Lead – 9.01lb/ft ² (3070 = 187lbs) (4070 = 252lbs) 1/8" Lead – 12.84lb/ft ² (3070 = 267lbs) (4070 = 360lbs)	
Crossband	High Density FSC Fiberboard	
Blocking	(Standard) 5" top rail; 1" Bottom Rail; 1" Fixed Internal Stiles (Additional blocking upon request)	
Assembly Adhesive	Face: Type I (waterproof); Core: Type II (water-resistant)	
Replaceable Edge Stiles & Covers	Non-Replaceable SCL Stiles. Acrovyn and/or 20GA #4 finish Stainless Steel Replaceable Covers	
Replaceable Edge Profile	Beveled, Square	
Lites	5" from edges, 1-1/2" from hardware or additional cutouts	
Lite Frames	Metal Lead Lined– Painted, Wood Veneered, Acrovyn Wrapped	
Glazing	Any appropriate lead equivalency	
Louvers	Not Available	
Electronic Options	Electronic hardware & raceways Available	
Hinges	Mortised, Surface & Continuous	
Pivots	Center hung & Offset w/intermediate	
Locks	Mortise & Cylindrical	
Exit Devices	Surface Vertical Rod (Includes LBR), RIM & Mortised	
Concealed Vertical Rod	Not Available	
Flushbolts	Must Be Extension Type (Metal Door)	
Closing Devices	Mortised or Surface Mounted (Mortised will affect lead)	
Door Bottoms	Mortised or Surface Mounted (Mortised will affect lead)	
Transoms	Not Available	

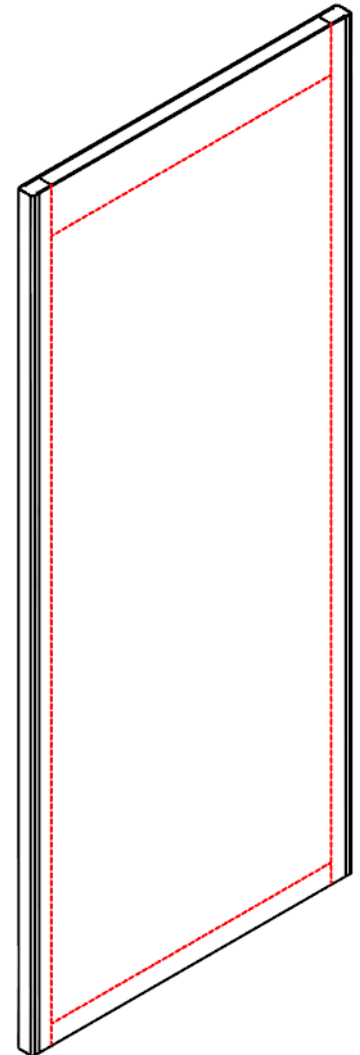

Lead Lined, Non-Rated SCL (LL SCL7-NR)

Bonded SCL Core, 7-Ply Construction

	Single Swing	Pair or Double Egress
Core Type & Standards	Structural Composite Lumber: (39 Lb/Ft ³)	
Maximum Sizes	4'0" x 8'0"	8'0" x 8'0" (Requires Lead Astragal)
Protection Plates	Up to 48" (above bottom of door)	
Door Thickness	1-3/4" (+/- 1/16")	
Lead Thickness	1/16" (4lb) or 1/8" (8lb), Balanced Construction	
WDMA Prefit Tolerance	Width: (+/- 1/32") Height & Thickness: (+/- 1/16")	
Weight	1/16" Lead – 10.63lb/ft ² (3070 = 221lbs) (4070 = 298lbs) 1/8" Lead – 14.46lb/ft ² (3070 = 300lbs) (4070 = 405lbs)	
Crossband	High Density FSC Fiberboard	
Blocking	(Standard) 5" top rail; 1" Bottom Rail; 1" Fixed Internal Stiles (Additional blocking upon request)	
Assembly Adhesive	Face: Type I (waterproof); Core: Type II (water-resistant)	
Replaceable Edge Stiles & Covers	Non-Replaceable SCL Stiles. Acrovyn and/or 20GA #4 finish Stainless Steel Replaceable Covers	
Replaceable Edge Profile	Beveled, Square	
Lites	5" from edges, 1-1/2" from hardware or additional cutouts	
Lite Frames	Metal Lead Lined– Painted, Wood Veneered, Acrovyn Wrapped	
Glazing	Any appropriate lead equivalency	
Louvers	Not Available	
Electronic Options	Electronic hardware & raceways Available	
Hinges	Mortised, Surface & Continuous	
Pivots	Center hung & Offset w/intermediate	
Locks	Mortise & Cylindrical	
Exit Devices	Surface Vertical Rod (Includes LBR), RIM & Mortised	
Concealed Vertical Rod	Not Available	
Flushbolts	Must Be Extension Type (Metal Door)	
Closing Devices	Mortised or Surface Mounted (Mortised will affect lead)	
Door Bottoms	Mortised or Surface Mounted (Mortised will affect lead)	
Transoms	Not Available	

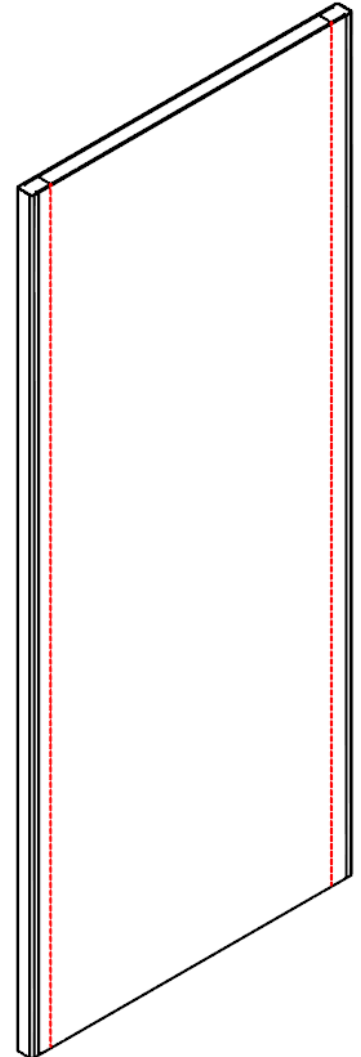

Lead Lined, 20 Minute Rated FSC Particleboard (LL FSC7-20PP)

Bonded FSC Particleboard Core, 7-Ply Construction, Cat. A, PP

	Single Swing	Pair or Double Egress
Core Type & Standards	FSC Particleboard: ANSI A208.1.2009 grade LD-1 (32 lb/ft³)	
Complies with CARB Phase I & II Emission Standards		
Maximum Sizes	4'0" x 8'0"	8'0" x 8'0" (Requires Lead Astragal)
Protection Plates	Up to 48" (above bottom of door)	
Door Thickness	1-3/4" (+/- 1/16")	
Lead Thickness	1/16" (4lb), Balanced Construction	
WDMA Prefit Tolerance	Width: (+/- 1/32") Height & Thickness: (+/- 1/16")	
Weight	1/16" Lead – 8.96lb/ft² (3070 = 186lbs) (4070 = 251lbs)	
Crossband	High Density FSC Fiberboard	
Blocking	(Standard) 5" top rail; 1" Bottom Rail; 1" Fixed Internal Stiles (Additional blocking upon request)	
Assembly Adhesive	Face: Type I (waterproof); Core: Type II (water-resistant)	
Replaceable Edge Stiles & Covers	Non-Replaceable SCL Stiles. Acrovyn and/or 20GA #4 finish Stainless Steel Replaceable Covers	
Replaceable Edge Profile	Beveled, Square	
Lites	5" from edges, 1-1/2" from hardware or additional cutouts	
Lite Frames	Metal Lead Lined– Painted, Wood Veneered	
Glazing	Any appropriate lead equivalency Any listed & labeled (20min or greater)	
Louvers	Not Available	
Electronic Options	Electronic hardware & raceways Available	
Hinges	Per NFPA 80 "Table 6.4.3.1"	
Pivots	Offset w/intermediate (Center hung – Not Available)	
Locks	Mortise & Cylindrical	
Exit Devices	Surface Vertical Rod (Includes LBR), RIM & Mortised	
Concealed Vertical Rod	Not Available	
Flushbolts	Must Be Extension Type (Metal Door)	
Closing Devices	Mortised or Surface Mounted (Mortised will affect lead)	
Door Bottoms	Mortised or Surface Mounted (Mortised will affect lead)	
Transoms	Not Available	

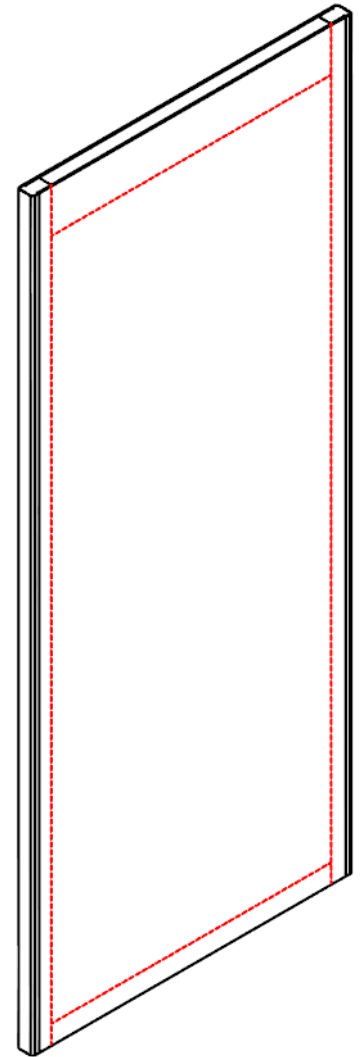

Lead Lined, 20 Minute Rated Particleboard (LL PC7-20PP)

Bonded Particleboard Core, 7-Ply Construction, Cat. A, PP

	Single Swing	Pair or Double Egress
Core Type & Standards	Particleboard: ANSI A208.1.2009 grade LD-1 (32 lb/ft ³)	
Maximum Sizes	4'0" x 8'0"	8'0" x 8'0" (Requires Lead Astragal)
Protection Plates	Up to 48" (above bottom of door)	
Door Thickness	1-3/4" (+/- 1/16")	
Lead Thickness	1/16" (4lb), Balanced Construction	
WDMA Prefit Tolerance	Width: (+/- 1/32") Height & Thickness: (+/- 1/16")	
Weight	1/16" Lead – 8.96lb/ft ² (3070 = 186lbs) (4070 = 251lbs)	
Crossband	High Density FSC Fiberboard	
Blocking	(Standard) 5" top rail; 1" Bottom Rail; 1" Fixed Internal Stiles (Additional blocking upon request)	
Assembly Adhesive	Face: Type I (waterproof); Core: Type II (water-resistant)	
Replaceable Edge Stiles & Covers	Non-Replaceable SCL Stiles. Acrovyn and/or 20GA #4 finish Stainless Steel Replaceable Covers	
Replaceable Edge Profile	Beveled, Square	
Lites	5" from edges, 1-1/2" from hardware or additional cutouts	
Lite Frames	Metal Lead Lined– Painted, Wood Veneered	
Glazing	Any appropriate lead equivalency Any listed & labeled (20min or greater)	
Louvers	Not Available	
Electronic Options	Electronic hardware & raceways Available	
Hinges	Per NFPA 80 "Table 6.4.3.1"	
Pivots	Offset w/intermediate (Center hung – Not Available)	
Locks	Mortise & Cylindrical	
Exit Devices	Surface Vertical Rod (Includes LBR), RIM & Mortised	
Concealed Vertical Rod	Not Available	
Flushbolts	Must Be Extension Type (Metal Door)	
Closing Devices	Mortised or Surface Mounted (Mortised will affect lead)	
Door Bottoms	Mortised or Surface Mounted (Mortised will affect lead)	
Transoms	Not Available	

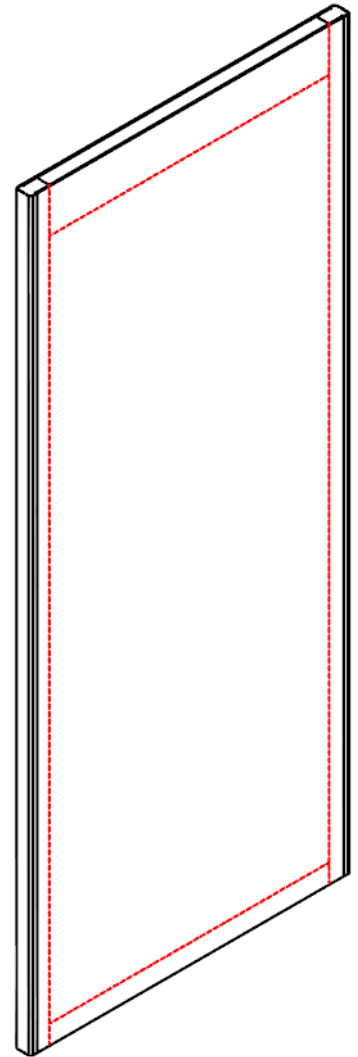

Lead Lined, 45 Minute Rated Mineral (LL FD7-45PP)

Bonded Mineral Core, 7-Ply Construction, Cat. A, PP

	Single Swing	Pair or Double Egress
Core Type & Standards	Mineral Composite: (28-35 lb/ft ³)	
Maximum Sizes	4'0" x 9'0"	8'0" x 9'0" (Requires Lead Astragal)
Protection Plates	Up to 48" (above bottom of door)	
Door Thickness	1-3/4" (+/- 1/16")	
Lead Thickness	1/16" (4lb) or 1/8" (8lb), Balanced Construction	
WDMA Prefit Tolerance	Width: (+/- 1/32") Height & Thickness: (+/- 1/16")	
Weight	1/16" Lead – 10.63lb/ft ² (3070 = 206lbs) (4070 = 277lbs) 1/8" Lead – 14.46lb/ft ² (3070 = 286lbs) (4070 = 385lbs)	
Crossband	High Density FSC Fiberboard	
Blocking	(Standard) 5" top rail; 1" Bottom Rail; 1" Fixed Internal Stiles (Additional blocking upon request)	
Assembly Adhesive	Face: Type I (waterproof); Core: Type II (water-resistant)	
Replaceable Edge Stiles & Covers	Non-Replaceable SCL Stiles. Acrovyn and/or 20GA #4 finish Stainless Steel Replaceable Covers	
Replaceable Edge Profile	Beveled, Square	
Lites	6" from edges, 5" from hardware or additional cutouts	
Max Visible Glass Area	1296 in ²	
Lite Frames	Metal Lead Lined– Painted, Wood Veneered	
Glazing	Any appropriate lead equivalency Any listed & labeled (45min or greater)	
Louvers	Not Available	
Electronic Options	Electronic hardware & raceways Available	
Hinges	Per NFPA 80 "Table 6.4.3.1"	
Points of Latching	Singles = 1pt	Pairs = 3pts (2pts w/ GP Blue Core) DE Pairs = 4pts (2pts w/ GP Blue Core)
Pivots	Offset w/intermediate (Center hung – Not Available)	
Locks	Mortise & Cylindrical	
Exit Devices	Surface Vertical Rod (Includes LBR), RIM & Mortised	
Concealed Vertical Rod	Not Available	
Flushbolts	Must Be Extension Type (Metal Door)	
Closing Devices	Mortised or Surface Mounted (Mortised will affect lead)	
Door Bottoms	Mortised or Surface Mounted (Mortised will affect lead)	
Transoms	Not Available	

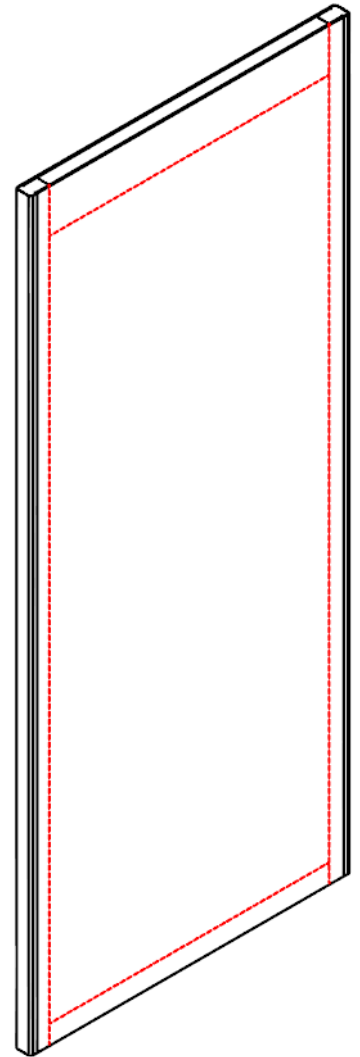

Lead Lined, 60 Minute Rated Mineral (LL FD7-60PP)

Bonded Mineral Core, 7-Ply Construction, Cat. A, PP

	Single Swing	Pair or Double Egress
Core Type & Standards	Mineral Composite: (28-35 lb/ft ³)	
Maximum Sizes	4'0" x 9'0"	8'0" x 9'0" (Requires Lead Astragal)
Protection Plates	Up to 48" (above bottom of door)	
Door Thickness	1-3/4" (+/- 1/16")	
Lead Thickness	1/16" (4lb) or 1/8" (8lb), Balanced Construction	
WDMA Prefit Tolerance	Width: (+/- 1/32") Height & Thickness: (+/- 1/16")	
Weight	1/16" Lead – 10.63lb/ft ² (3070 = 206lbs) (4070 = 277lbs) 1/8" Lead – 14.46lb/ft ² (3070 = 286lbs) (4070 = 385lbs)	
Crossband	High Density FSC Fiberboard	
Blocking	(Standard) 5" top rail; 1" Bottom Rail; 1" Fixed Internal Stiles (Additional blocking upon request)	
Assembly Adhesive	Face: Type I (waterproof); Core: Type II (water-resistant)	
Replaceable Edge Stiles & Covers	Non-Replaceable SCL Stiles. Acrovyn and/or 20GA #4 finish Stainless Steel Replaceable Covers	
Replaceable Edge Profile	Beveled, Square	
Lites	6" from edges, 5" from hardware or additional cutouts	
Max Visible Glass Area	100 in ²	
Lite Frames	Metal Lead Lined– Painted, Wood Veneered	
Glazing	Any appropriate lead equivalency Any listed & labeled (60min or greater)	
Louvers	Not Available	
Electronic Options	Electronic hardware & raceways Available	
Hinges	Per NFPA 80 "Table 6.4.3.1"	
Points of Latching	Singles = 1pt	Pairs = 4pts (2pts w/ GP Blue Core) DE Pairs = 4pts (2pts w/ GP Blue Core)
Pivots	Offset w/intermediate (Center hung – Not Available)	
Locks	Mortise & Cylindrical	
Exit Devices	Surface Vertical Rod (Includes LBR), RIM & Mortised	
Concealed Vertical Rod	Not Available	
Flushbolts	Must Be Extension Type (Metal Door)	
Closing Devices	Mortised or Surface Mounted (Mortised will affect lead)	
Door Bottoms	Mortised or Surface Mounted (Mortised will affect lead)	
Transoms	Not Available	

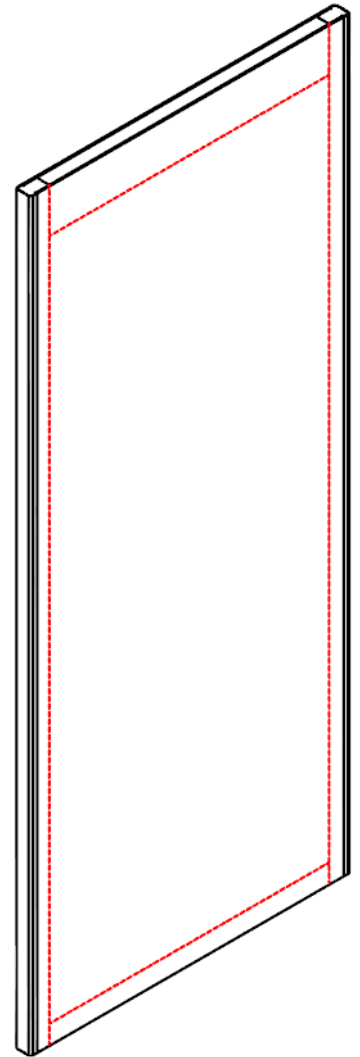

Bulletin: Concealed Closers/Stops

CS Acrovyn Doors has approval to machine for listed and approved concealed overhead closers and/or stops in doors rated 20 through 90-minutes. Concealed holders are not allowed in labeled doors unless they include an automatic release function when fire is detected. The specific approvals include:

- **Track in Door: WHI / Guardian (20 through 90-minute labeled doors) the cutout dimension cannot exceed 1-1/2" in depth, 1-5/16" in width or 23-5/8" in length.**

CS Acrovyn Doors will not warranty doors that exceed the following:

Doors with concealed closers deeper than 2" or wider than 1-1/4" or machined pockets that leave less than 1/4" thick cavity walls.

Due to the large cutouts required for this hardware, a frame (header) applied intumescent will be required to be installed above the cutout (*Such as Technofire 2000/2006*). By definition, this makes the opening Category B from a code perspective. Whereas the door is constructed (as Category A) with intumescent stiles and rail, the only additional field-applied intumescent required will be over the hardware cutout. This rule applies to 20 through 90 minute applications.

(See intumescent installation instructions on following page)

Concealed Closers/Stops Intumescent Installation Instructions

Due to the large cutouts required for this hardware, a frame (header) applied intumescent will be required to be installed above the cutout (*Such as Technofire 2000/2006*).

Installation of the frame applied intumescent:

1. Locate the intumescent CS Acrovyn Doors has supplied with your doors for your convenience. If Technofire Intumescent has become damaged or lost, it is your responsibility to replace it.
2. Thoroughly clean the frame surface where intumescent will be applied. Ensure surface is clean and dry before continuing.
3. Technofire Intumescent may need trimmed to fit the frame opening. If it does, the product may be cut with scissors. Notching or trimming for hardware in the frame header may also need to be completed.
4. Remove the adhesive backer from the backside of the Technofire Intumescent strip and firmly attach it to the header of the frame directly above the door.
5. At this point installation of the Technofire Intumescent is complete.
 - a. If you would like to paint over the surface of the Technofire Intumescent, you may do so.

(Failure to apply the intumescent will compromise the fire rating)

