

**NOTES:**

1. MATERIALS MUST REACH 65°F (18°C) MIN TO 75°F (24°C) MAX 24 HOURS PRIOR TO INSTALLATION. THIS IS ESSENTIAL TO MINIMIZE EXPANSION AND CONTRACTION OF MATERIAL.
2. FOR DRYWALL/PLASTER WALL CONSTRUCTION, IT IS RECOMMENDED FOR FASTENERS TO BE ENGAGED INTO METAL/WOOD STUDS TO MAINTAIN MAXIMUM PULL-OUT STRENGTH.

WALL CONDITION	SPECIFIED FASTENER	DRILL DIAMETERS		C/S PART NUMBER
		WALL	RETAINER	
STEEL STUD/GYPSUM WALL	#6 X 1-5/8" BUGLE HEAD SMS	N/A	3/16"	90H079002
CONCRETE/CONC. BLOCK	AF-6 ALLIGATOR ANCHOR #10 X 1-1/2" PHILLIPS PAN HD. SMS	1/4"	9/32"	90H039004 90H189002
WOOD STUD/GYPSUM WALL	#6 X 1-5/8" BUGLE HEAD SMS	N/A	3/16"	90H079002

# INSTALLATION INSTRUCTIONS

## DEMOUNTABLE Z-CLIP ACROVYN WALL PANEL SYSTEM

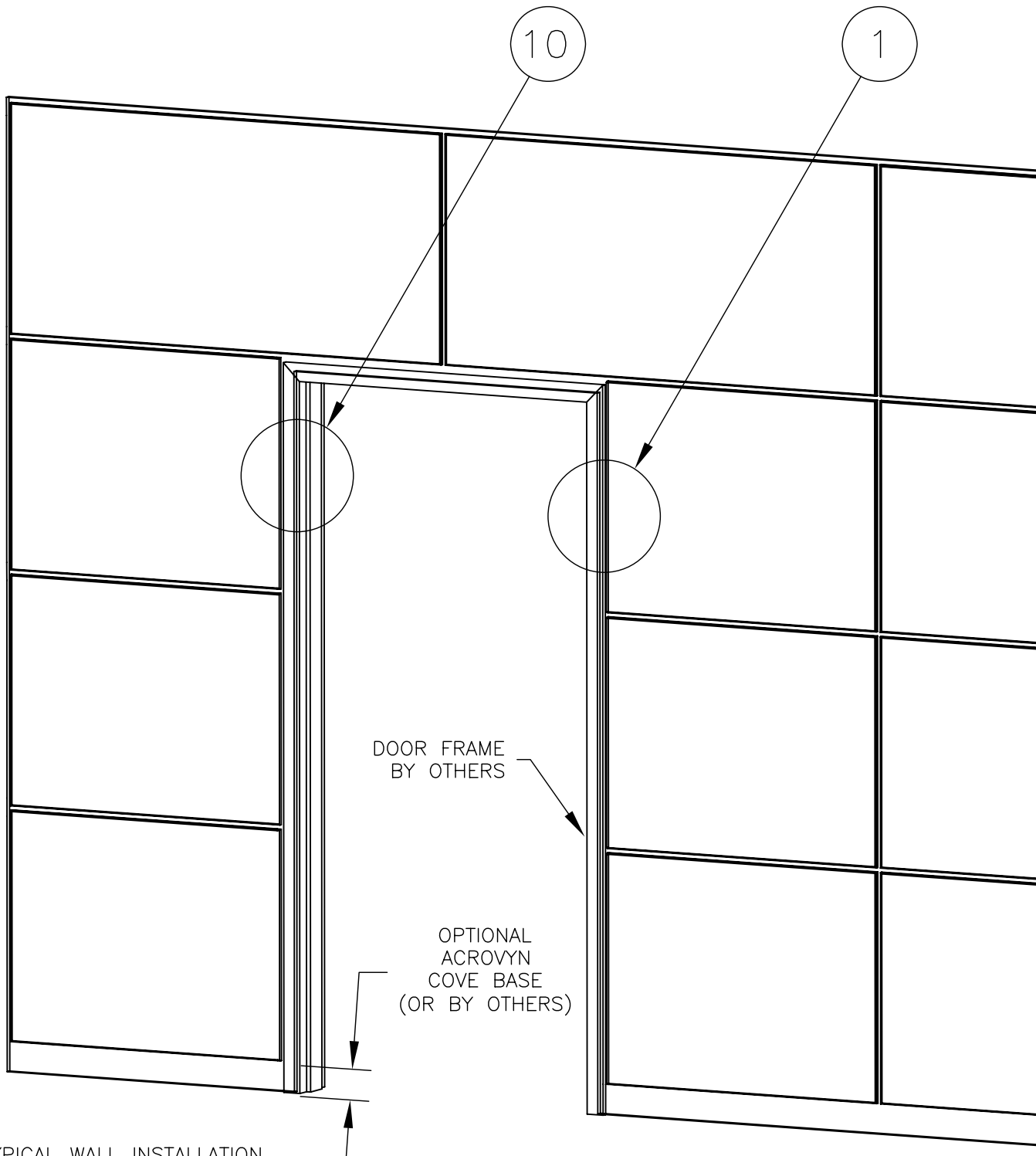

TYPICAL WALL INSTALLATION.

NOTE: NUMBERS POINTING TO AREAS OF THE DRAWING REFER TO DETAILS USED THROUGHOUT THE INSTRUCTIONS.

STEP 1:  
MEASURE WALLS TO DETERMINE LAYOUT AND PLACEMENT OF WALL PANELS. THIS  
SYSTEM IS DESIGNED TO COVER FIELD CUT PANEL EDGES THAT END AT DOOR  
FRAMES AND INSIDE/OUTSIDE CORNERS.

21B

**REFER TO DRAFTING DETAILS FOR SPECIFIED REVEAL WIDTH AND  
WALL MOUNTING CLIP LOCATION.**

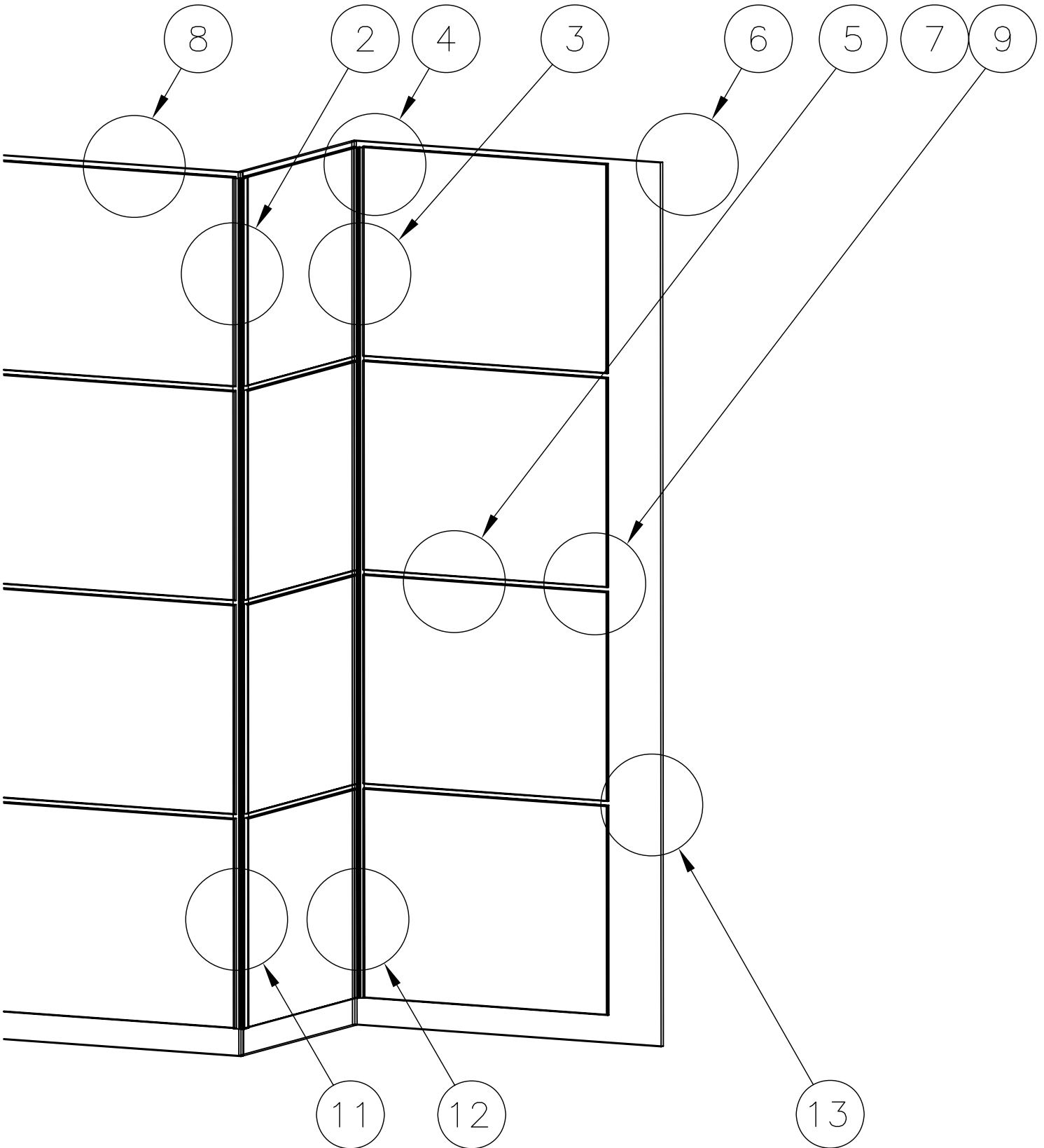

# INSTALLATION INSTRUCTIONS

## DEMOUNTABLE Z-CLIP ACROVYN WALL PANEL SYSTEM

### STEP 2:

CUT TO SIZE AND INSTALL ALL OF THE FOLLOWING ALUMINUM RETAINERS: EDGE, OUTSIDE CORNER AND INSIDE CORNER. SEE DETAILS 1, 2, AND 3. ALLOW A 2 1/2 INCH GAP BETWEEN THE CEILING AND THE TOP OF THE CORNER EXTRUSIONS. SEE DETAIL 4, PAGE 5. BE SURE ALL PIECES ARE LEVEL AND PLUMB. SHIM IF NECESSARY. NOTE: ALL ALUMINUM EXTRUSIONS HAVE A SMALL "V" GROOVE FOR LOCATING FASTENERS. FOR TYPE OF FASTENER AND PILOT HOLE SIZE USED IN ALUMINUM RETAINER, REFERENCE CHART LOCATED AT BOTTOM OF FRONT COVER.

OPTIONAL: IF ANY OF THESE THREE RETAINERS CANNOT BE ATTACHED DIRECTLY TO A STUD, INSTALL AS AN ASSEMBLY WITH THE EDGE / REVEAL MOLDING (SEE PAGE 8, STEP 5). SNAP FIT EDGE / REVEAL MOLDING TO AN ALUMINUM RETAINER AND CUT TO SIZE AS AN ASSEMBLY. ADD A 3/8" (10mm) CLEARANCE HOLE IN THE EDGE / REVEAL MOLDING IN LINE WITH THE RETAINER'S PILOT HOLE. BE SURE MOUNTING HOLES ARE ONLY LOCATED IN AREAS COVERED BY WALL PANELS.

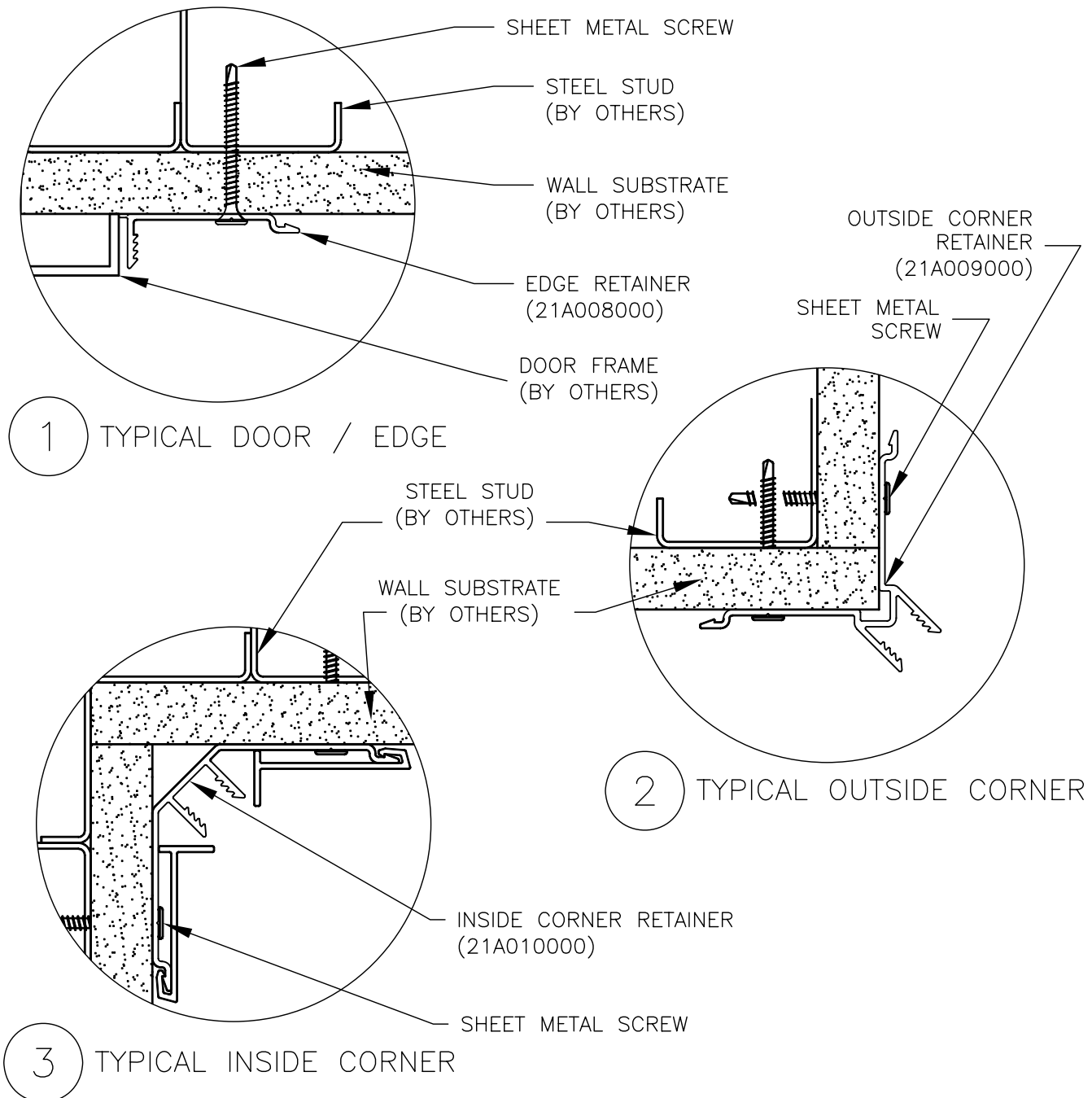

STEP 3:

CUT TO SIZE AND INSTALL ALL HORIZONTAL ALUMINUM REVEAL RETAINERS. WHEN COMPLETE CUT TO SIZE AND INSTALL ALL VERTICAL ALUMINUM REVEAL RETAINERS. BE SURE ALL PIECES ARE LEVEL AND PLUMB, SHIM IF NECESSARY. ALL ALUMINUM EXTRUSIONS HAVE A SMALL "V" GROOVE FOR LOCATING FASTENERS. ALLOW A 1/4" (6mm) TO 3/4" (19mm) GAP BETWEEN END OF VERTICAL RETAINER AND HORIZONTAL RETAINER (SEE PAGE 6, DETAIL 7).

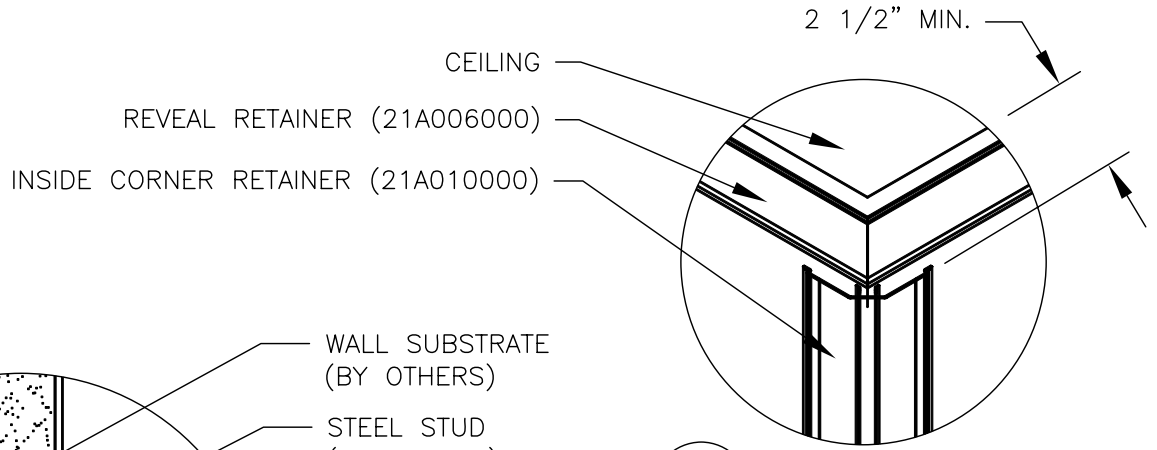

4 TYPICAL REVEAL RETAINER INSIDE CORNER AT CEILING

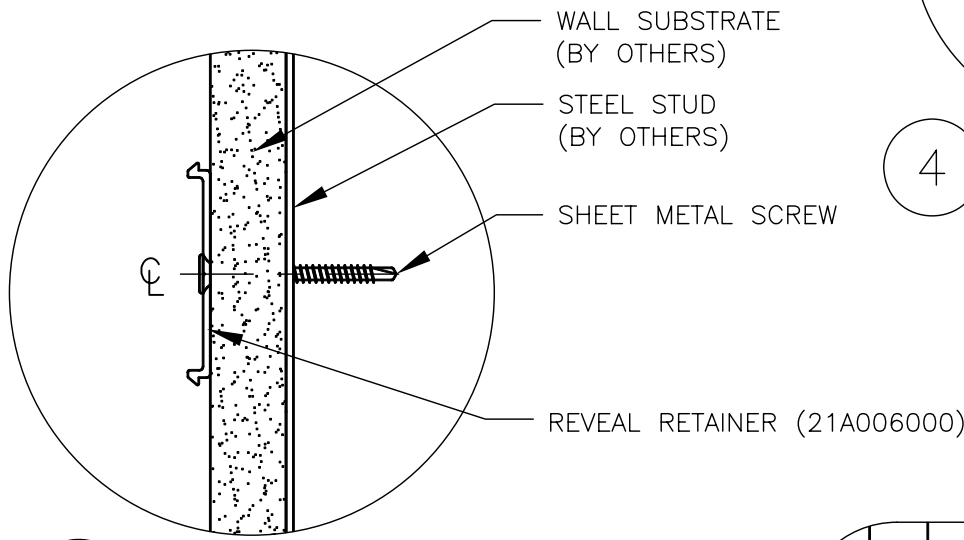

5 TYPICAL REVEAL RETAINER

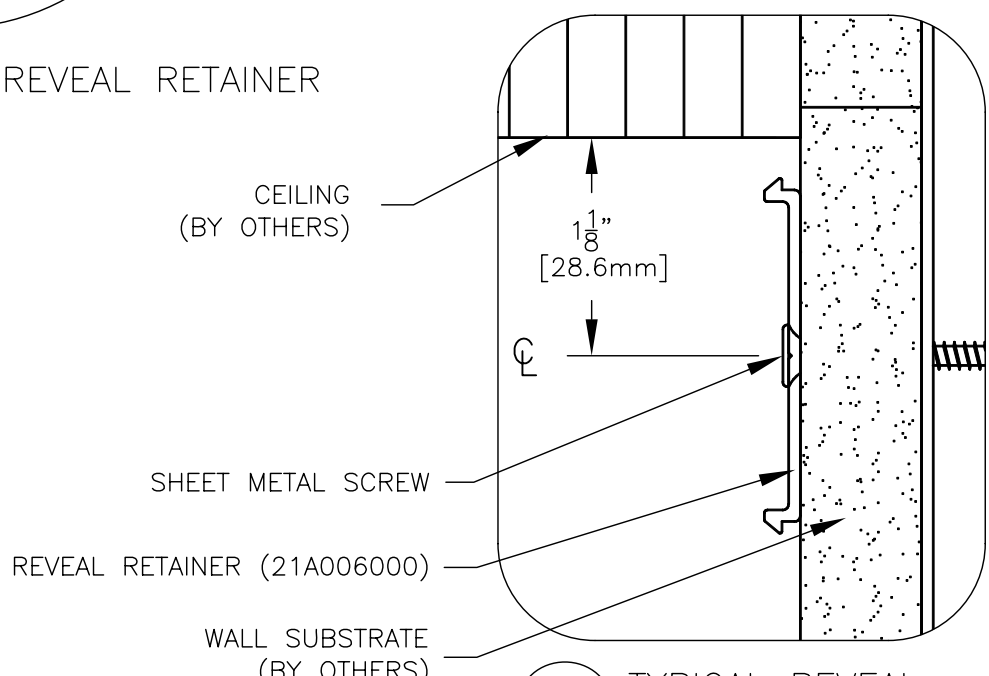

6 TYPICAL REVEAL RETAINER AT CEILING

# INSTALLATION INSTRUCTIONS

## DEMOUNTABLE Z-CLIP ACROVYN WALL PANEL SYSTEM

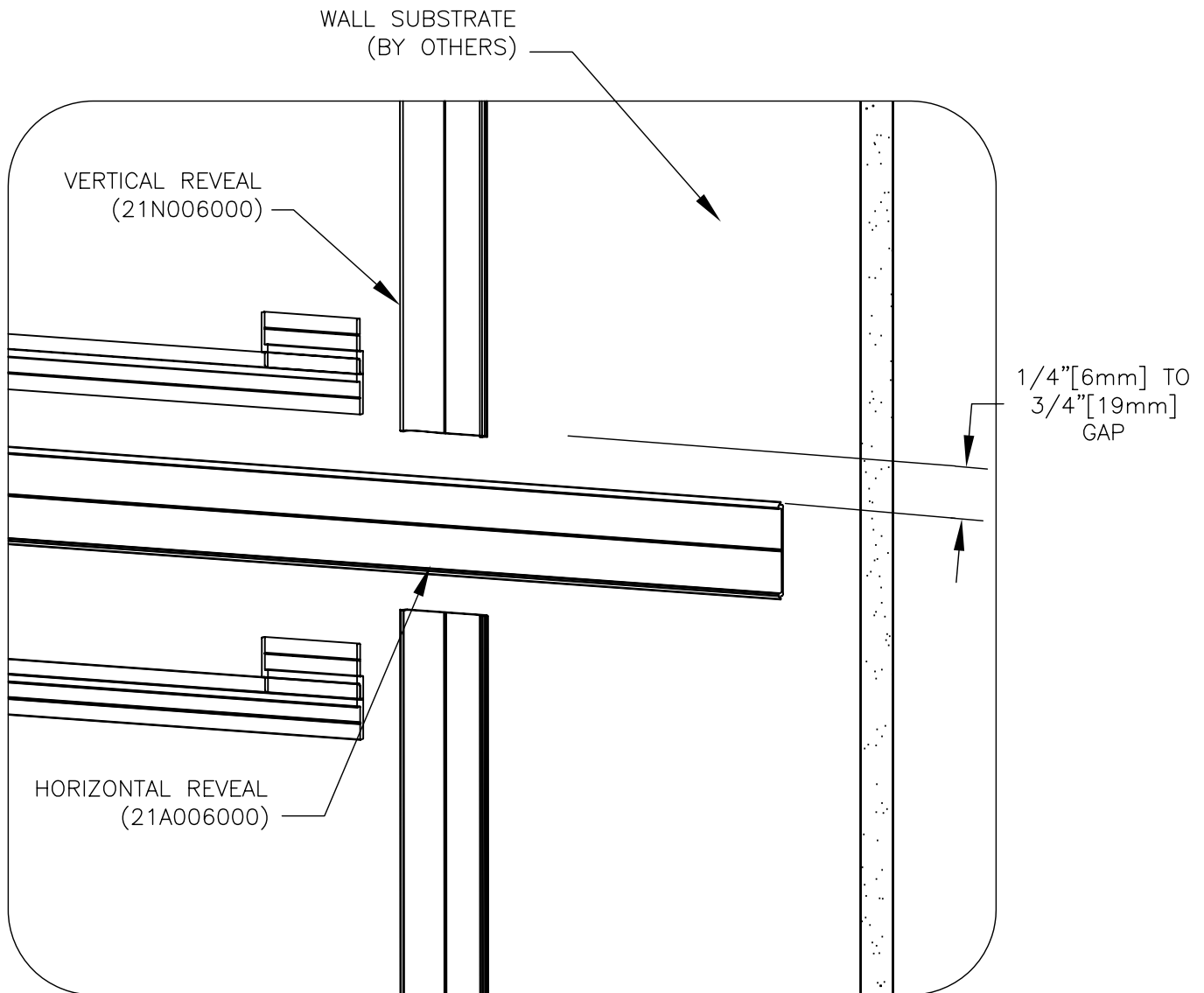

7 TYPICAL REVEAL RETAINER INTERSECTION

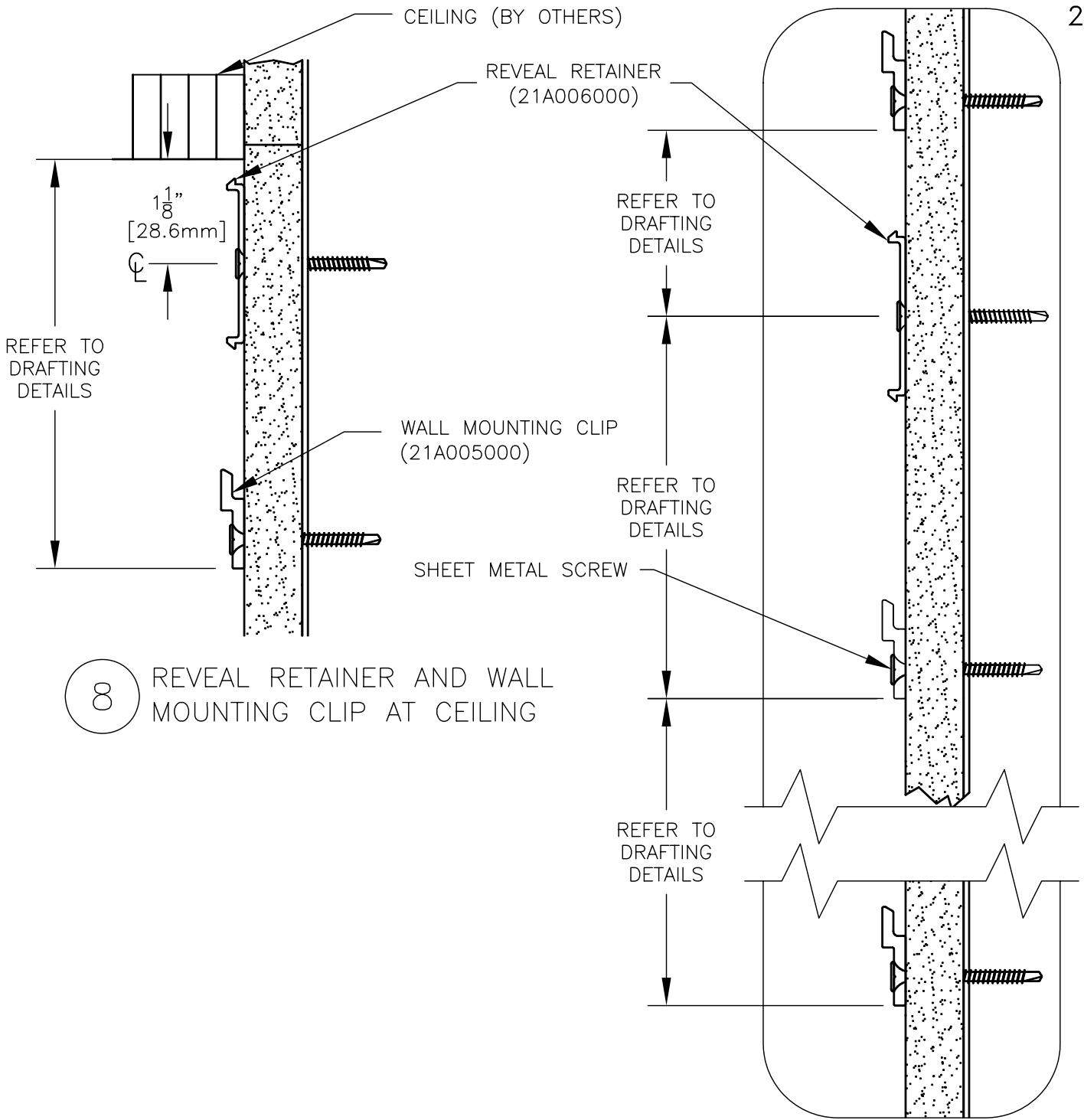

8 REVEAL RETAINER AND WALL MOUNTING CLIP AT CEILING

9 TYPICAL ALUMINUM WALL MOUNTING CLIPS AND REVEAL RETAINER

STEP 4:  
 CUT TO SIZE AND INSTALL ALL WALL MOUNTING CLIPS. SEE DETAILS 8 AND 9. BE SURE ALL WALL MOUNTING CLIPS ARE LEVEL. WARNING: THE LOCATION OF WALL MOUNTING CLIPS IS CRITICAL TO A PROPERLY SPACED REVEAL WIDTH. BE SURE THESE CLIPS ARE ATTACHED TO A STUD, BECAUSE THEY SUPPORT THE FULL WEIGHT OF THE WALL PANELS. ALL ALUMINUM EXTRUSIONS HAVE A SMALL "V" GROOVE FOR LOCATING FASTENERS.

# INSTALLATION INSTRUCTIONS

## DEMOUNTABLE Z-CLIP ACROVYN WALL PANEL SYSTEM

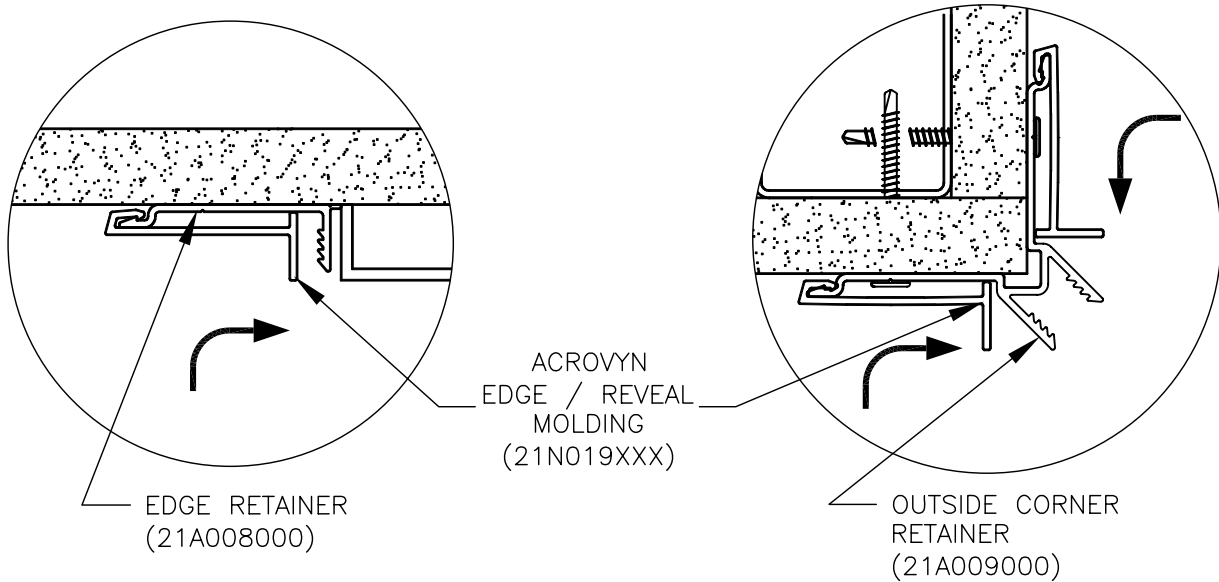

10 TYPICAL ALUMINUM EDGE RETAINER WITH ACROVYN EDGE / REVEAL MOLDING

11 TYPICAL ALUMINUM OUTSIDE CORNER RETAINER WITH ACROVYN EDGE / REVEAL MOLDINGS

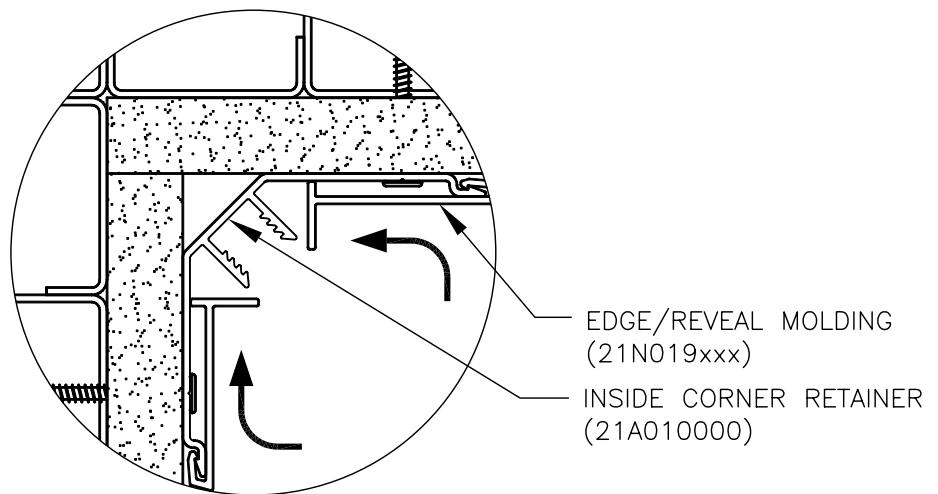

12 TYPICAL ALUMINUM INSIDE CORNER RETAINER WITH ACROVYN EDGE / REVEAL MOLDINGS

STEP 5:  
CUT TO SIZE AND SNAP FIT EDGE/REVEAL MOLDING ON ALUMINUM RETAINERS. SEE DETAILS 10, 11, AND 12. NOTE: ALL REVEAL EDGES TO BE TIGHT AND SQUARE AGAINST ADJACENT REVEAL MOLDING.

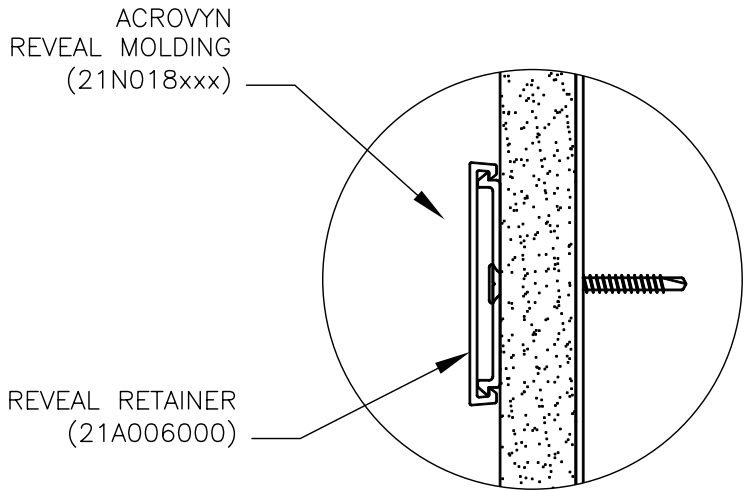

13 TYPICAL REVEAL RETAINER WITH ACROVYN REVEAL MOLDING

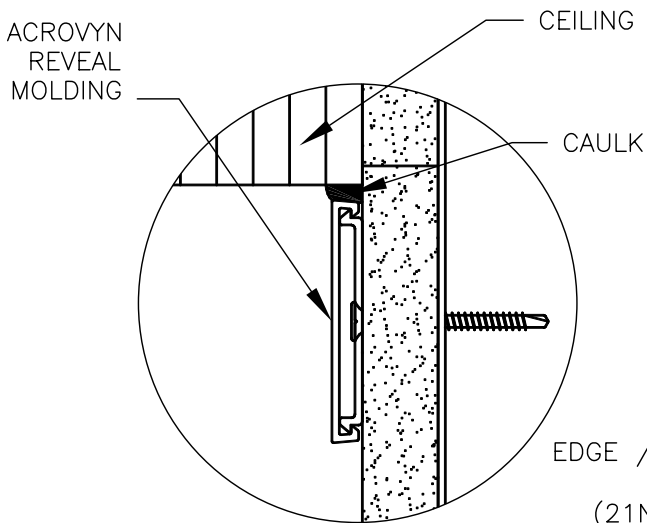

14 CAULK AT CEILING

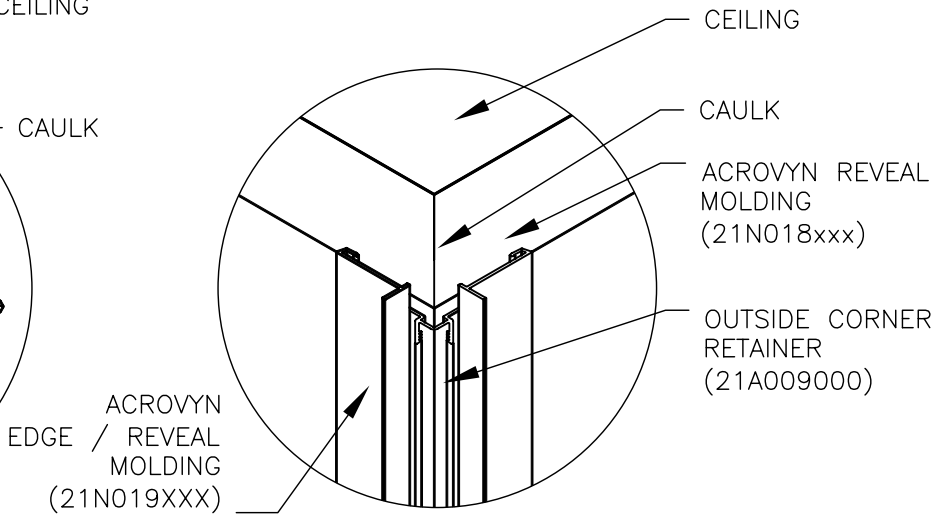

15 CAULK AT CORNER

STEP 6:  
CUT TO SIZE AND SNAP FIT ALL HORIZONTAL REVEAL MOLDINGS ON ALUMINUM RETAINERS. SEE DETAIL 13. NOTE: ALL REVEAL EDGES TO BE TIGHT AND SQUARE AGAINST ADJACENT REVEAL MOLDING.

STEP 7:  
APPLY COLOR MATCHED CAULK BETWEEN CEILING AND TOP HORIZONTAL REVEAL MOLDING (SEE DETAIL 14). WHEN COMPLETE, APPLY COLOR MATCHED CAULK AT TOP INSIDE AND OUTSIDE CORNER JOINTS (SEE DETAIL 15).

STEP 8:  
CUT TO SIZE AND SNAP FIT ALL VERTICAL REVEAL MOLDINGS ON ALUMINUM RETAINERS. BE SURE TO COMPLETE STEP 6 BEFORE CUTTING AND FITTING VERTICAL REVEAL MOLDING. NOTE: ALL REVEAL EDGES TO BE TIGHT AND SQUARE AGAINST ADJACENT REVEAL MOLDING.

# INSTALLATION INSTRUCTIONS

## DEMOUNTABLE Z-CLIP ACROVYN WALL PANEL SYSTEM

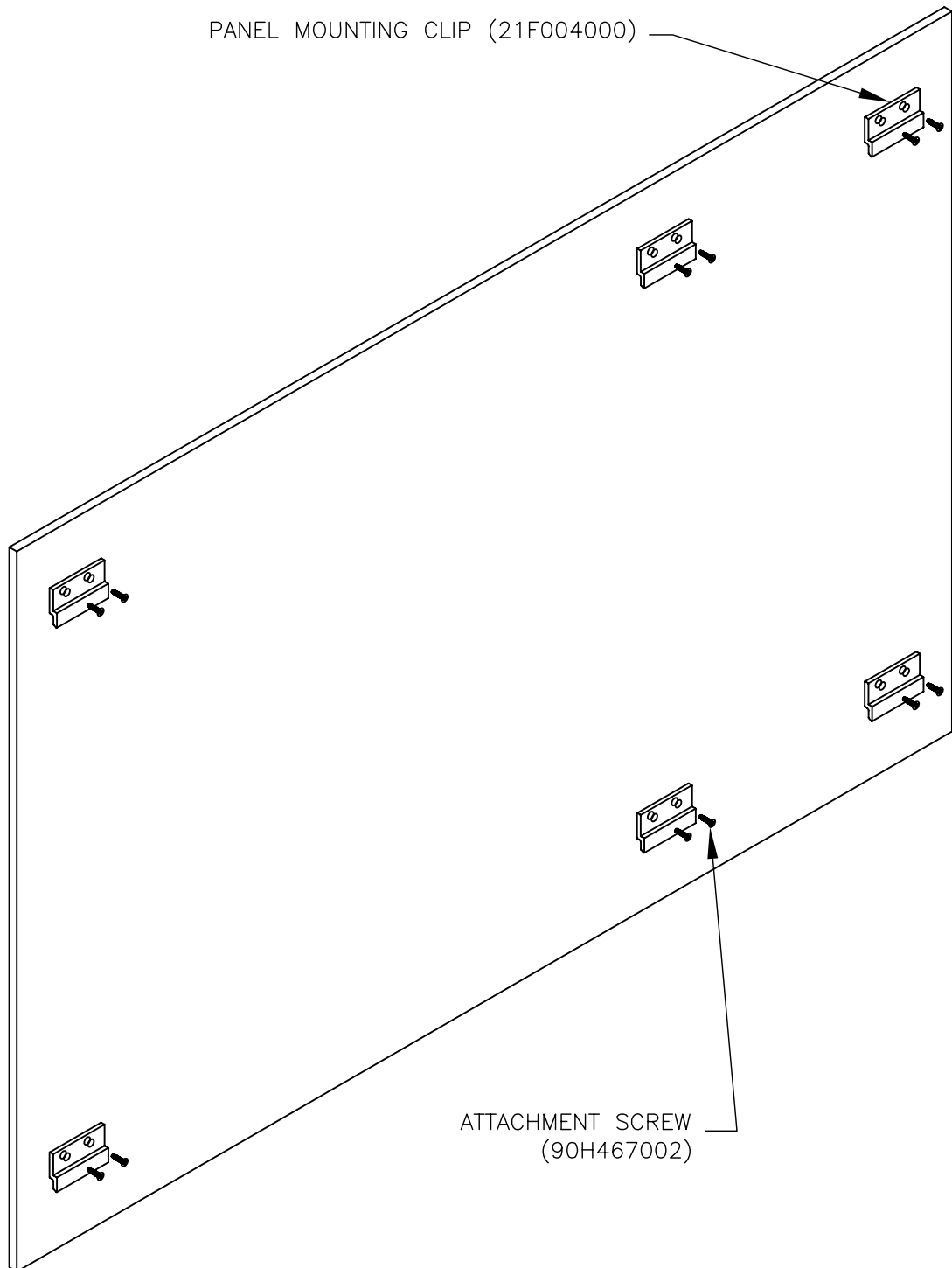

### STEP 9:

INSTALL FACTORY SUPPLIED PANEL MOUNTING CLIPS (21F004000) USING ATTACHMENT SCREWS (90H467002) IN PREDRILLED HOLES IN THE BACK OF PANELS. THE TOP OF THE PANEL SHOULD BE CLEARLY MARKED TO ENSURE THAT THE PANEL MOUNTING CLIPS ARE PROPERLY ORIENTED. **TO RELOCATE PANEL MOUNTING CLIP HOLES ON CUT PANELS, REFER TO PAGE 14.**

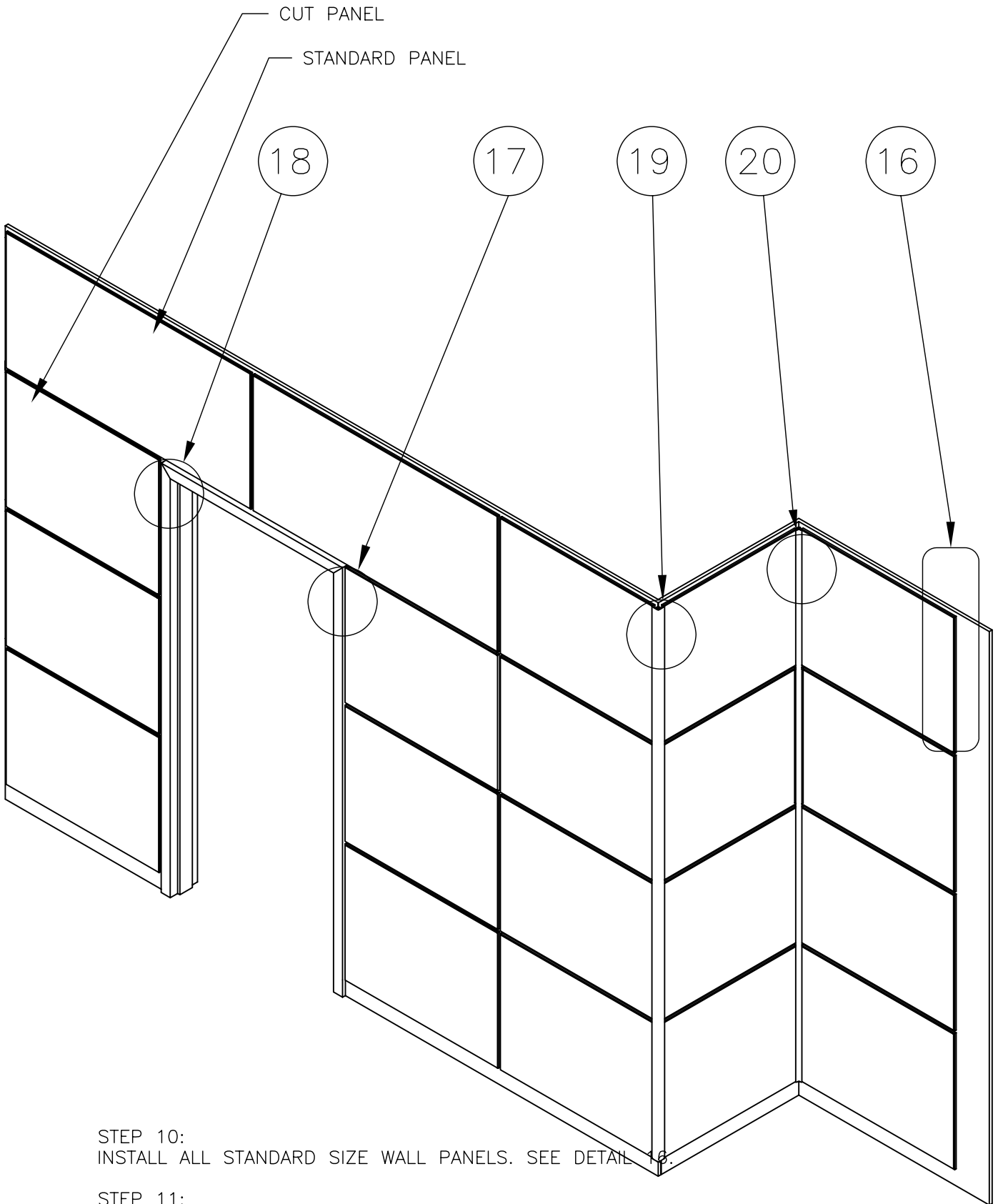

STEP 10:  
INSTALL ALL STANDARD SIZE WALL PANELS. SEE DETAIL 18.

STEP 11:  
FIELD CUT ANY WALL PANELS THAT END ON EDGE / REVEAL MOLDING ATTACHED AT DOOR FRAMES, OUTSIDE AND INSIDE CORNERS. BE SURE NOT TO EXCEED ALLOWABLE GAP SHOWN IN DETAIL 17. **TO RELOCATE THE PANEL MOUNTING CLIP HOLES ON CUT PANELS, REFER TO PAGE 14.**

# INSTALLATION INSTRUCTIONS

## DEMOUNTABLE Z-CLIP ACROVYN WALL PANEL SYSTEM

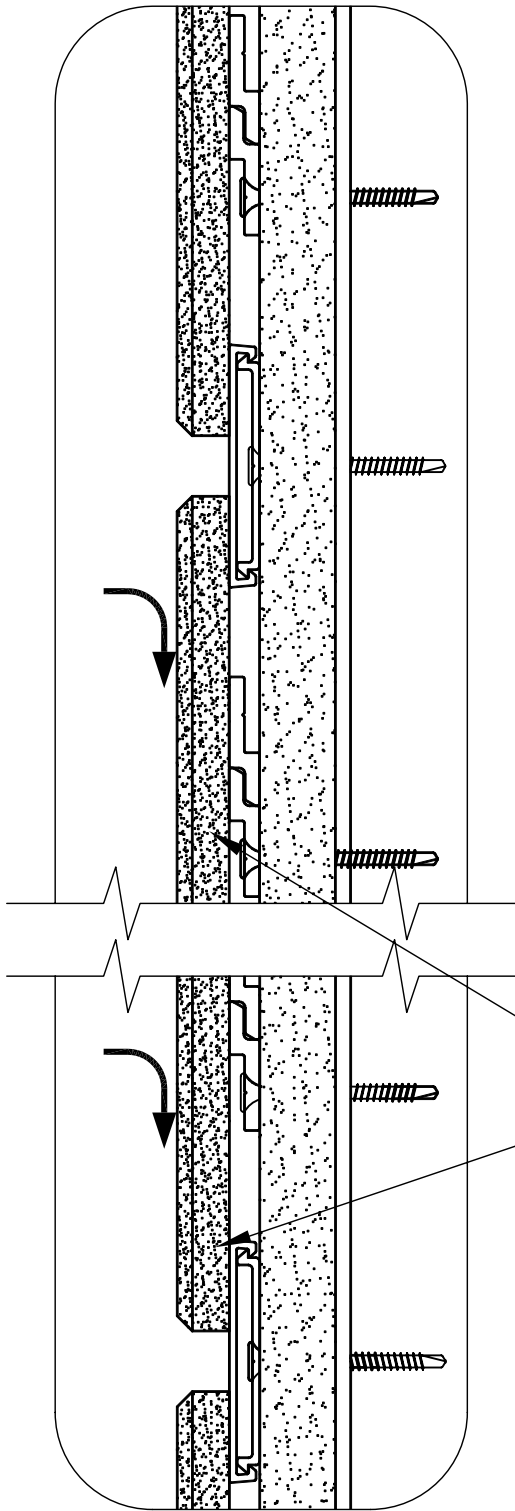

16 TYPICAL MOUNTING OF WALL PANEL

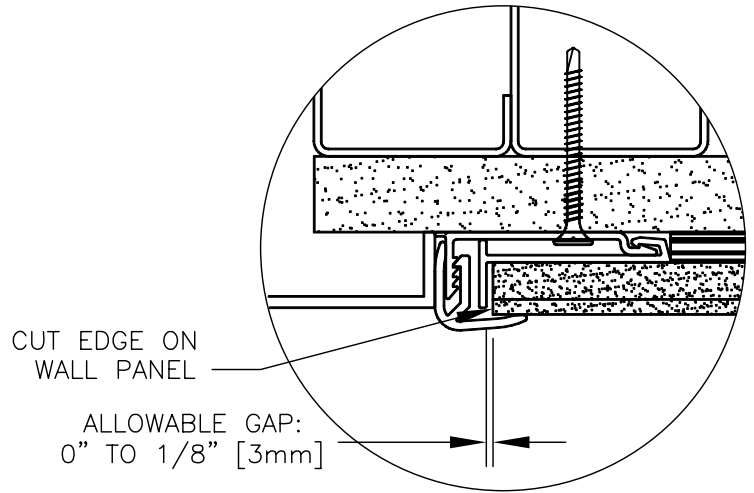

17 TYPICAL CUT EDGE OF WALL PANEL

.040 ACROVYN CLAD WALL PANEL USING FACTORY SUPPLIED PANEL MOUNTING CLIPS.

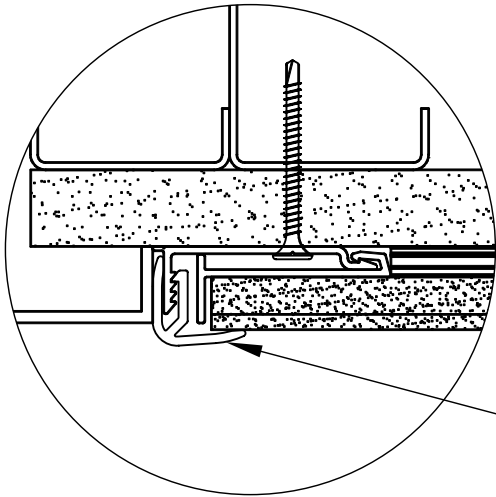

ACROVYN EDGE MOLDING  
(21N020XXX)

18 TYPICAL ACROVYN  
EDGE MOLDING

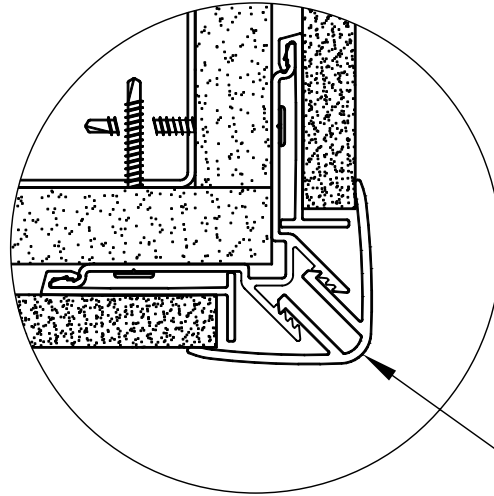

ACROVYN OUTSIDE  
CORNER MOLDING  
(21N021XXX)

19 TYPICAL ACROVYN  
OUTSIDE CORNER MOLDING

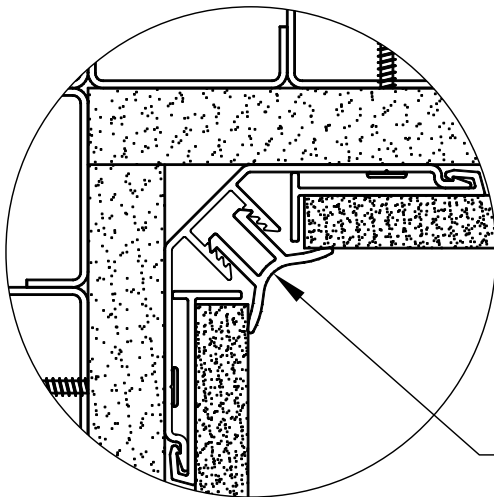

ACROVYN INSIDE CORNER MOLDING  
(21N022XXX)

20 TYPICAL ACROVYN  
INSIDE CORNER MOLDING

STEP 12:  
CUT TO SIZE AND SNAP FIT EDGE, OUTSIDE AND/OR INSIDE CORNER MOLDINGS IN THE ALUMINUM RETAINERS. SEE DETAILS 18, 19, AND 20. NOTE: IF CHIPPING OCCURS FROM CUTTING THE ACROVYN MOLDING, ORIENT THE PROFILE SO THE SNAP FITTING TEETH ARE FIRST TO BE CUT BY THE SAW BLADE.

NOTE: TO ENSURE A QUALITY MITER ON EDGE MOLDING, SNAP FIT MOLDING TO A SHORT PIECE OF ALUMINUM EDGE RETAINER, THEN CUT.

# INSTALLATION INSTRUCTIONS

## DEMOUNTABLE Z-CLIP ACROVYN WALL PANEL SYSTEM

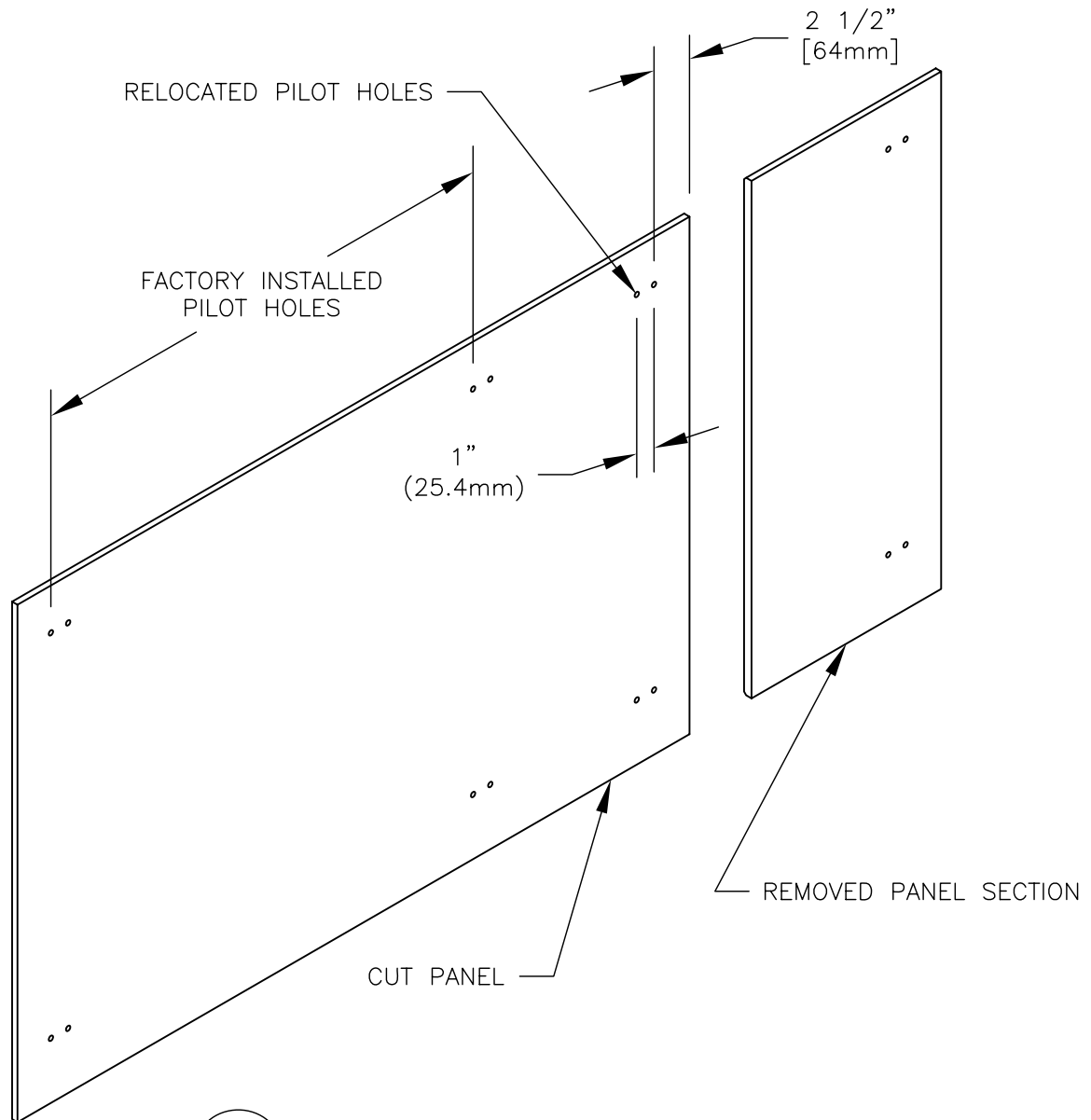

### 21 CUT PANEL WITH RELOCATED HOLES

FOR CUT PANELS, LOCATE OUTER PANEL MOUNTING CLIP PILOT HOLES 2 1/2" (64mm) INCHES FROM CUT EDGE. PILOT HOLE SIZE TO BE 5/32" (4mm) DIAMETER X 3/8" (10mm) DEEP. HOLE LOCATION FROM TOP EDGE OF PANEL SHOULD REMAIN THE SAME AS THE FACTORY PREDRILLED PILOT HOLES. WARNINGS: USE A DRILL STOP TO PREVENT DRILLING THROUGH THE ACROVYN SURFACE. DO NOT DRILL PILOT HOLE DEEPER THAN 3/8" (10mm). IF THE HOLE IS TOO SHALLOW OR NOT CLEARED OF CHIPS THE PILOT HOLE WILL BULGE AND PREVENT THE CLIP FROM SEATING FLUSH.

CONSTRUCTION SPECIALTIES INC  
DECOGARD PRODUCTS

MUNCY, PENNSYLVANIA 17756  
MISSISSAUGA ONTARIO L5E 2C2

A Member of the  
**CSGROUP**  
of Companies

This document is the property of Construction Specialties, Inc. and contains CONFIDENTIAL PROPRIETARY INFORMATION that is not to be disclosed to third parties and is not to be used without approval in writing from Construction Specialties, Inc.

1/4/06

FOR FURTHER ASSISTANCE CALL (800) 233-8493 OR FAX (570) 546-5169 OR IN CANADA CALL (888) 895-8955 OR FAX (905) 274-6241