

COLOR: \_\_\_\_\_

COLOR TO BE SELECTED FROM ONE OF C/S 60 STANDARD COLORS.

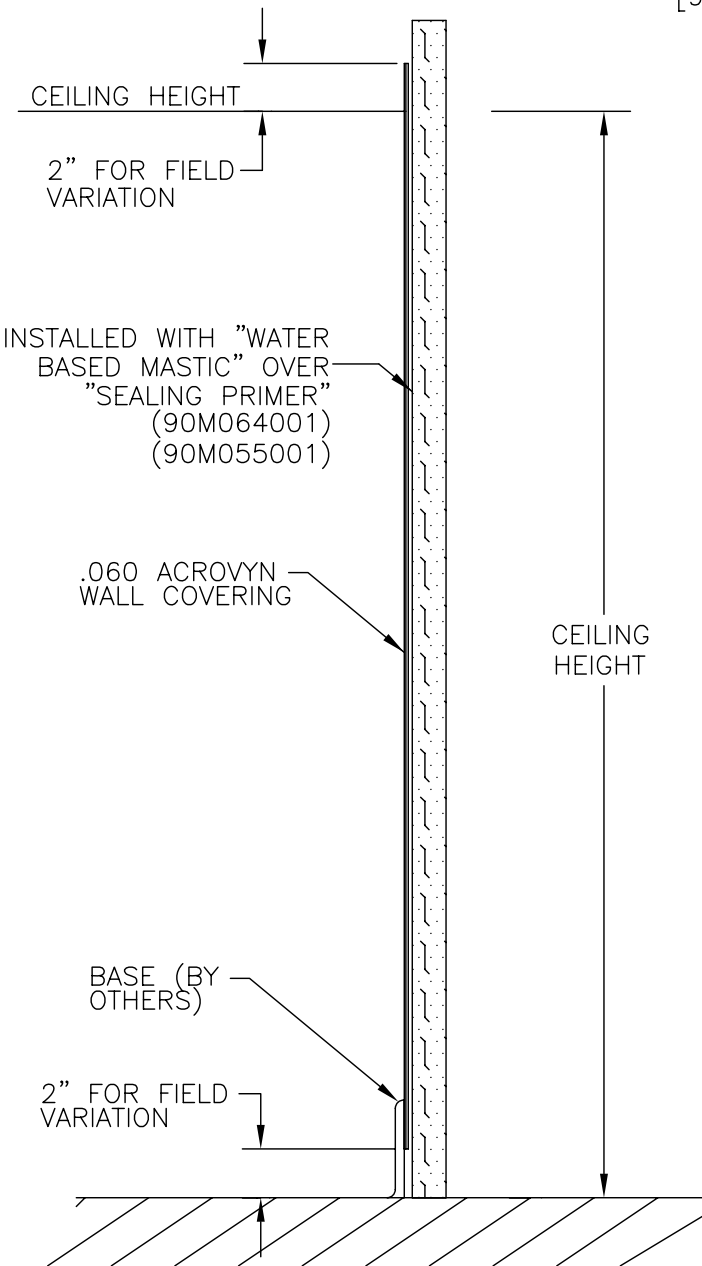

INSTALLED WITH "WATER BASED MASTIC" OVER "SEALING PRIMER" (90M064001) (90M055001)

.060 ACROVYN WALL COVERING

BASE (BY OTHERS)

2" FOR FIELD VARIATION

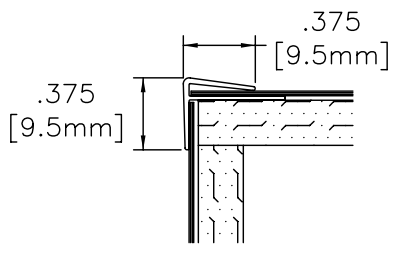

OUTSIDE CORNER (25N032XXX)

NO. REQ'D: \_\_\_\_\_

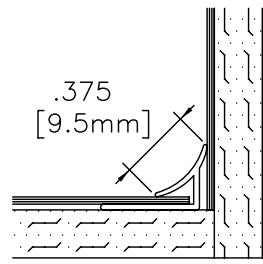

INSIDE CORNER (25N035XXX)

NO. REQ'D: \_\_\_\_\_

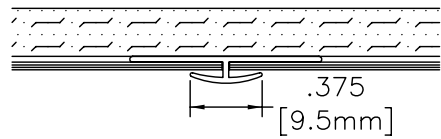

"H" JOINT MOLDING (25N033XXX)

NO. REQ'D: \_\_\_\_\_

GENERAL NOTES:

- 1) STANDARD SHEET SIZES: 4'x8' OR 4'x10' WITH MINIMUM .060 THICKNESS.
- 2) .060 ACROVYN WALL COVER IS SUPPLIED WITH A STANDARD PEBBLETTE TEXTURE.
- 3) ALL TRIM MEMBERS SHALL BE SUPPLIED IN HIGH IMPACT VINYL/ACRYLIC ALLOY IN 10' LENGTHS.
- 4) TO INSURE PROPER INSTALLATION OF .060 ACROVYN COVERING, USE INSTALLATION SHEETS INCLUDED WITH EACH HARDWARE SHIPMENT.
- 5) COLOR SELECTION MUST BE INCLUDED WITH THE APPROVED DRAWINGS TO PREVENT ANY DELAYS IN THE SHIPMENT OF MATERIALS.
- 6) .060 ACROVYN WALL COVER IS AVAILABLE IN ANY OF C/S 60 STANDARD COLORS.

INSTALLATION NOTES:

- 1) WAINSCOT TRIM QUANTITY IS CALCULATED FOR WAINSCOT USE ONLY. NOT FOR EDGE TRIM.
- 2) INSIDE CORNER TRIM QUANTITY IS BASED ON WHERE SHEET IS ON ADJOINING WALLS
- 3) OUTSIDE CORNER TRIM QUANTITY IS BASED ON SHEET ON BOTH WALLS AT CORNER.

MATERIAL TO BE SUPPLIED IN 4'x8' OR 4'x10' SHEETS

NO. 4'x 8' SHEETS REQ'D. (25S001XXX): \_\_\_\_\_

NO. 4'x 10' SHEETS REQ'D. (25S018XXX): \_\_\_\_\_

.060 ACROVYN AT FULL HEIGHT

**C/S GROUP**

MUNCY, PA 17756  
MISSISSAUGA, ONTARIO, CANADA

PROJECT:		REV.
LOCATION:		F&F
CUSTOMER:		SHEET OF
AGENT:		JOB NO.
DWG. BY:	DATE:	